

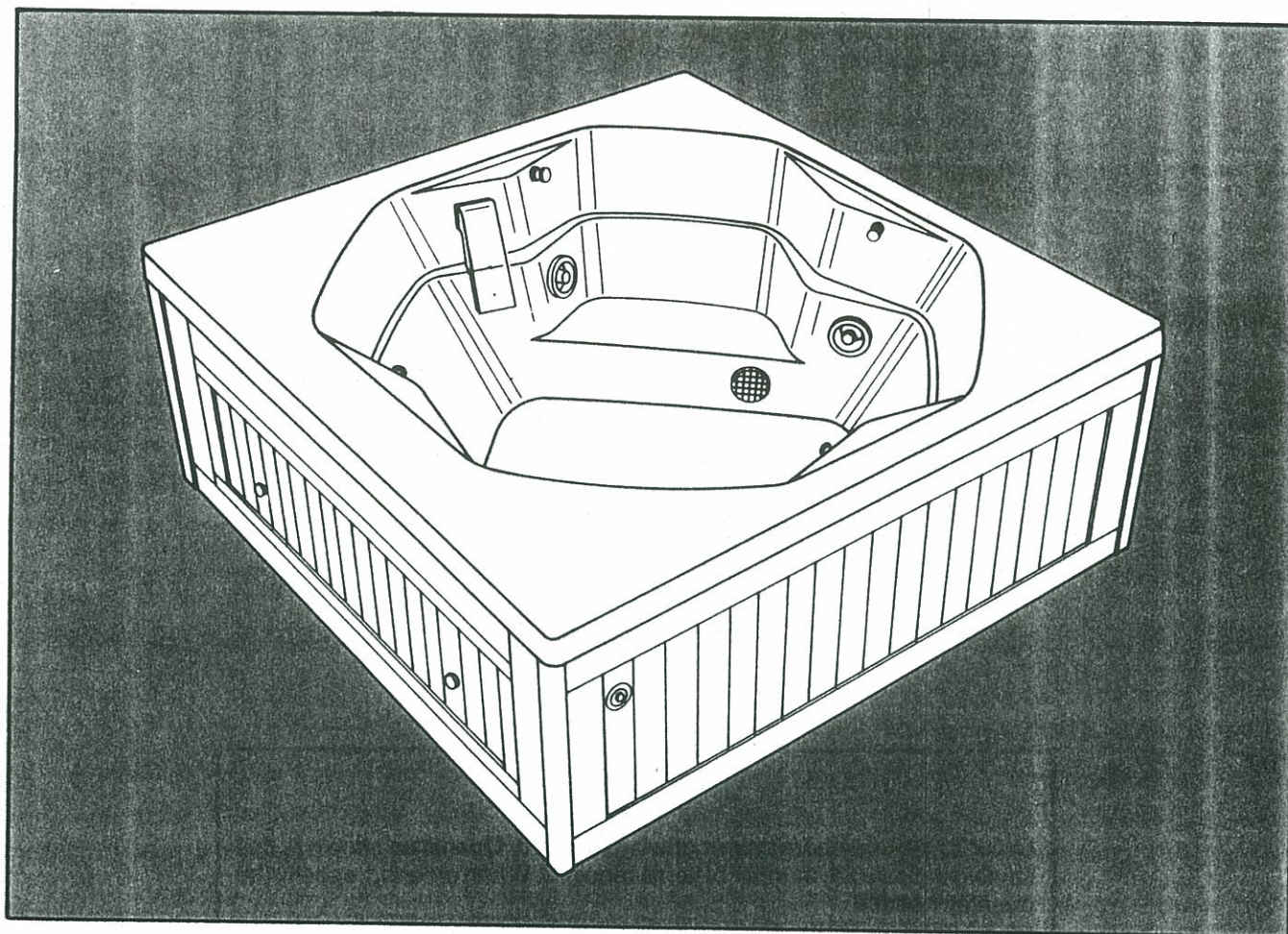

The ESPREE II™ Whirlpool Spa



PARTS CATALOG

Model #5630000 Level 1
Model #5630000 Level 2
Issue Date: 12/85
Catalog #6701000

CONTENTS

	Page
Espre II Reference	1
Discharge Plumbing	2
AMH Jet	3
AMH Jet Trim	4
Suction Plumbing	5
Suction Cover/Strainer	6
Suction Fitting	7
Air Line Assembly	8
Air Line Assembly with Bleeder	9
Air Cap Assembly	10
Safety Suction Relief	11
Skimmer Assembly	12
Filter and Equipment Pack Discharge Plumbing (Level 1 Only)	13
Filter and Equipment Pack Discharge Plumbing (Level 2 Only)	14
Filter Assembly, 25 Sq. Ft.	15
Heater Assembly	16
Pump Assembly	17
Motor/Bracket Assembly	18
Electrical Box Assembly (Level 1 Only)	19
Electrical Box Assembly (Level 2 Only)	20
Electrical Line Cord Assembly	21
Vent/Drain Assemblies	22
Spa Cover	23
Skirt Assembly (Level 1 Only)	24
Skirt Assembly (Level 2 Only)	25
Repair Carton Assembly	26
Other Items Available	27

TO ORDER

Order by part numbers unless otherwise noted. Quantities shown in this catalog indicate the number of items required. When ordering, specify the quantity needed.

PART NO.	MODEL	LEVEL	DESCRIPTION
6701000A	Espre II	1	Removable Foam Batts, Foam Insulated, Vinyl-Cover.
6701000A	Espre II	2	.75 HP., 2-Speed, Magnetic Equipment Pack. Heater Priority System.

Repair Assemblies Are Referenced to Page Numbers Shown Below.

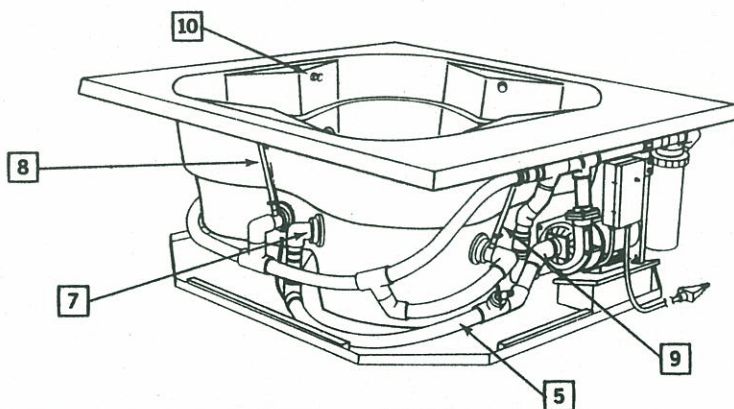
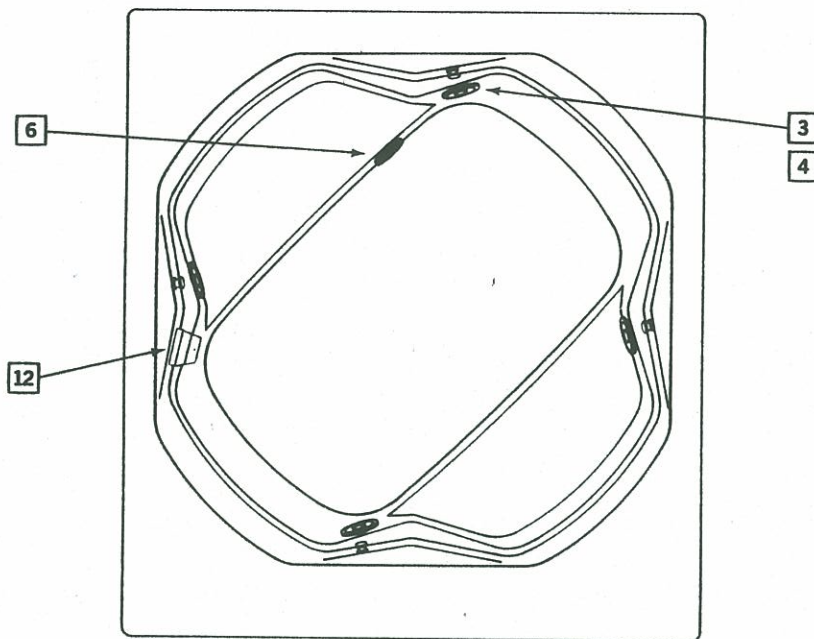

Serial Number and Product Specifications

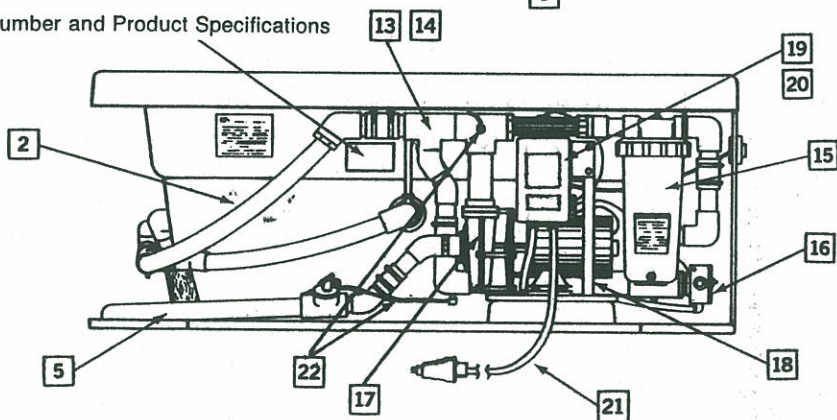

DISCHARGE PLUMBING

(1½" Flex PVC Piping, shown for reference, is not available from Jacuzzi Whirlpool Bath.)*

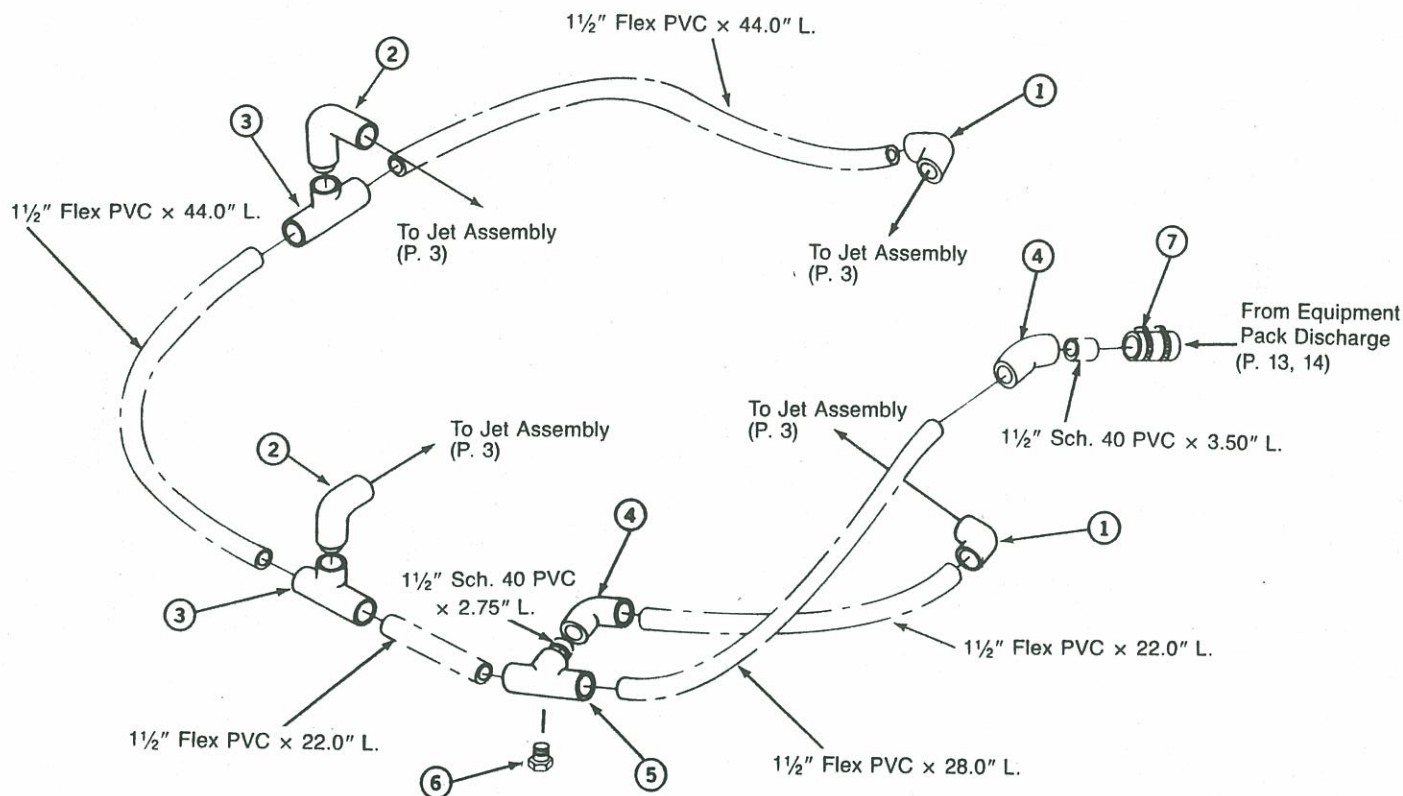

*Bond Flex PVC with Flex PVC cement.

ITEM	P/N	DESCRIPTION	QTY
1	0239000	Ell, 90° 1.5" S x S	2
2	0955000	Ell, 90° Street 1.5" S x MS	2
3	0167000	Tee, 1.5", S x S x S	2
4	0157000	Ell, 45° 1.5" S x S	2
5	5495000	Tee, 1½" Machined	1
6	0538000	Plug, Drain ⅜" NPT	1
7	2448000	Repair Piping Connector, 1.5"	1

AMH JET

(Trim shown for reference; see page 4 for Trim Assembly.)

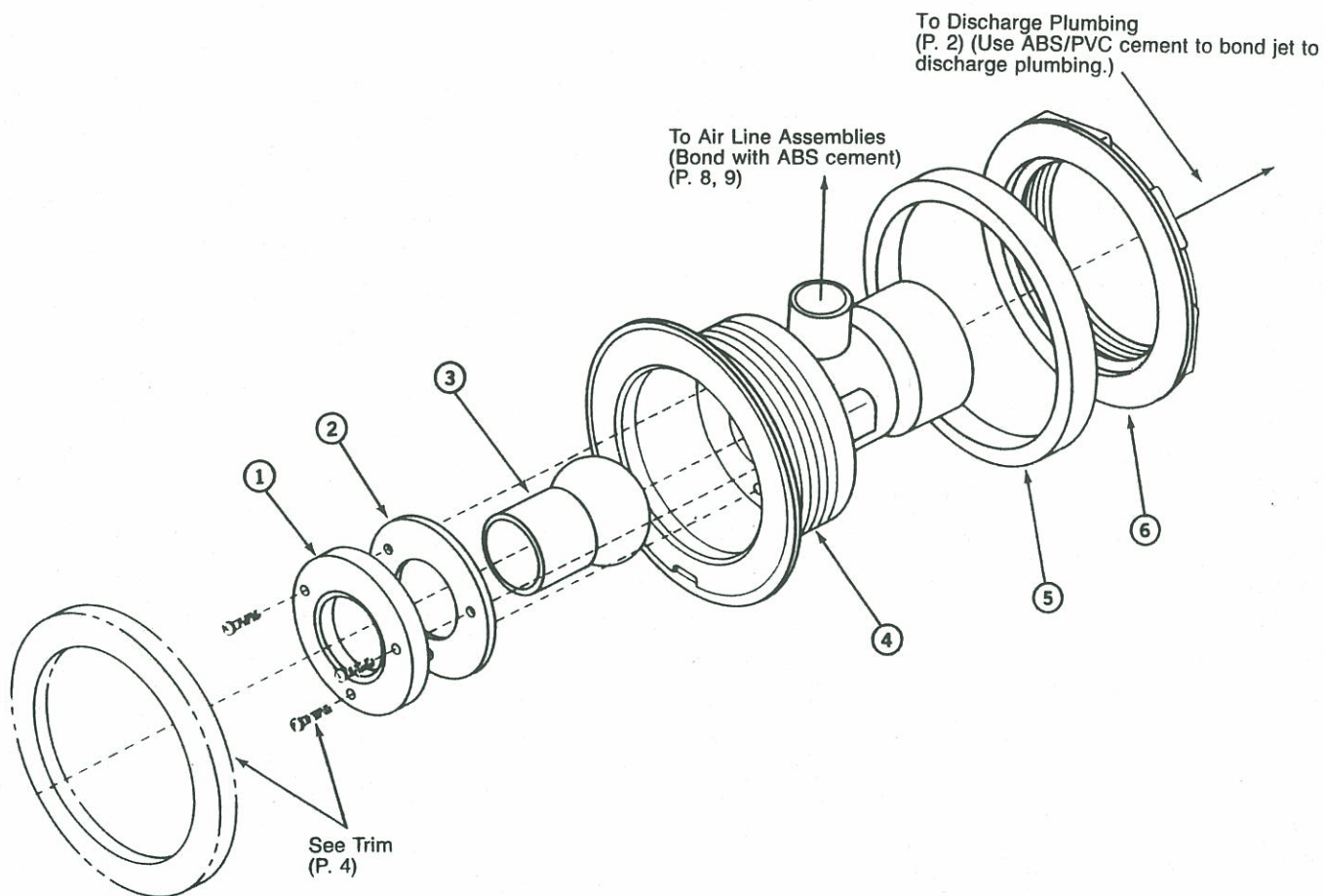

ITEM	P/N	DESCRIPTION	QTY
1	4558000	Ring, Clamping, AMH Jet	1
2	1840000	Gasket, Clamping Ring, AMH Jet	1
3	1834000	Nozzle, AMH Jet	1
4	1833000	Body, AMH Jet	1
5	1836000	Ring, Back-up, AMH Jet	1
6	1835000	Nut, AMH Jet	1

AMH JET TRIM

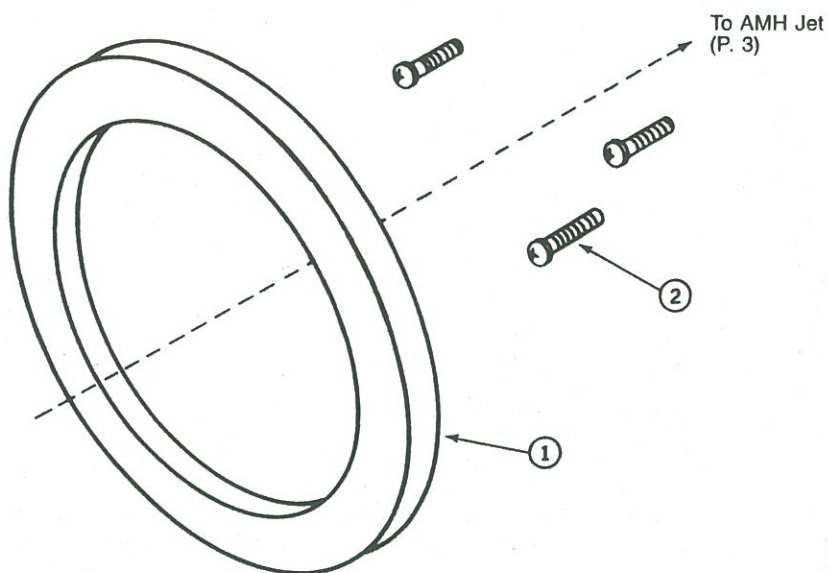

AMH Jet Trim

ITEM	P/N	DESCRIPTION	QTY
1	1838848	Face Ring, AMH, Polished	1
2	3967000	Screw, Mach. PHP 8-32 x .5" L., S.S.	3

SUCTION PLUMBING

(1½" Flex PVC, shown for reference, is not available from Jacuzzi Whirlpool Bath.)*

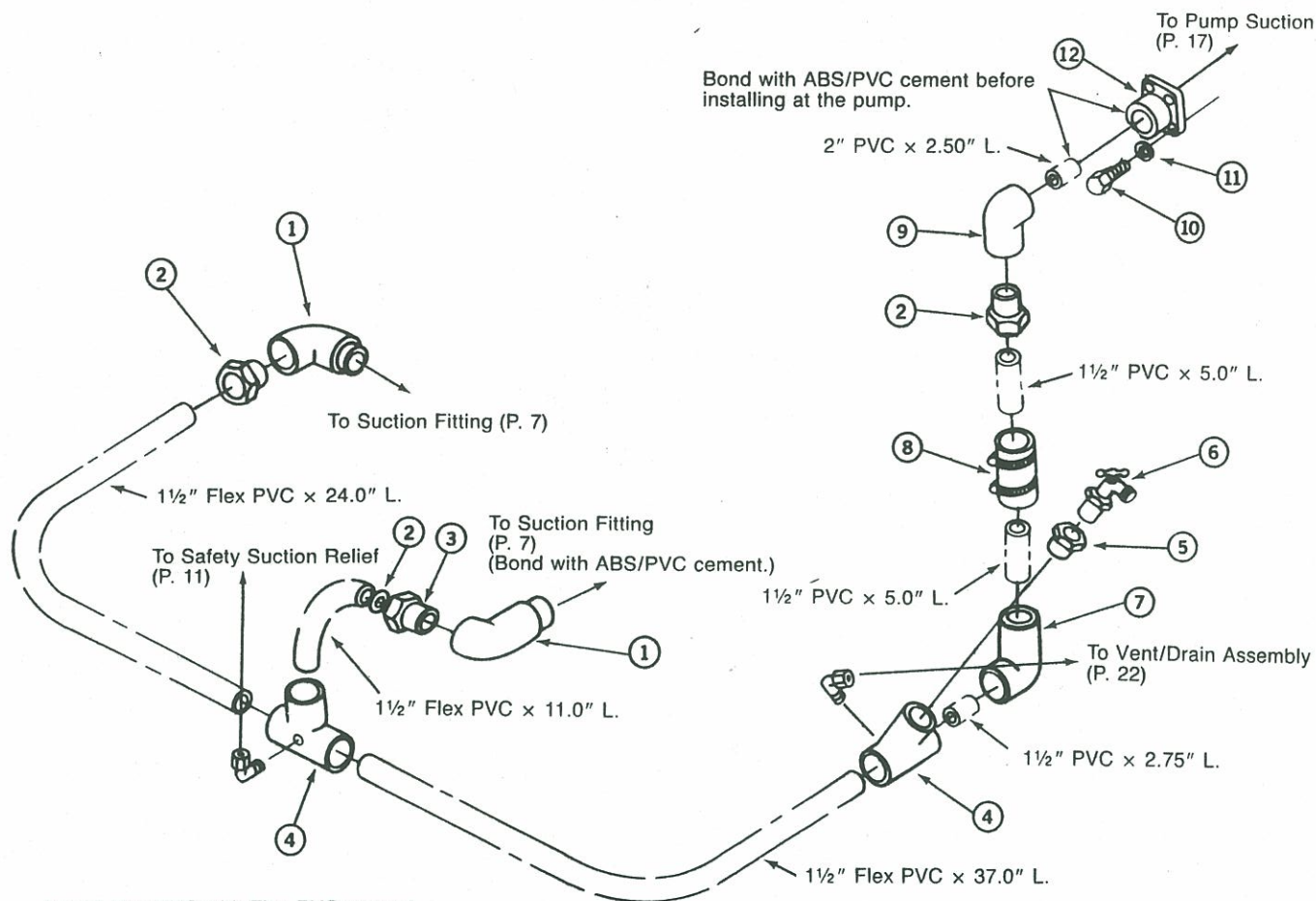

*Bond Flex PVC with Flex PVC cement.

ITEM	P/N	DESCRIPTION	QTY
1	1592000	Ell, 90° Street, 2" S x MS	2
2	0473000	Bushing, Reducing 2" x 1.5"	3
3	3798000	Restrictor, Flow .94 I.D.	1
4	5495000	Tee, 1½" Machined	2
5	3622000	Bushing, Rdg., 1.50" x .75" SPG x FPT	1
6	4657000	Hose Bibb, Tee handle	1
7	015700Q	Ell, 45°, 1.5" S x S	2
8	2448000	Repair Piping Connector, 1.5"	1
9	0522000	Ell, 45°, 2" S x S	1
10	3951832	Bolt, Hex 5/16-18 x 1" L.	4
11	3983832	Washer, 5/16 Flt, Type A Pln Wd Ser	4
12	4516000	Flange, Pump 2"	1

SUCTION COVER/STRAINER

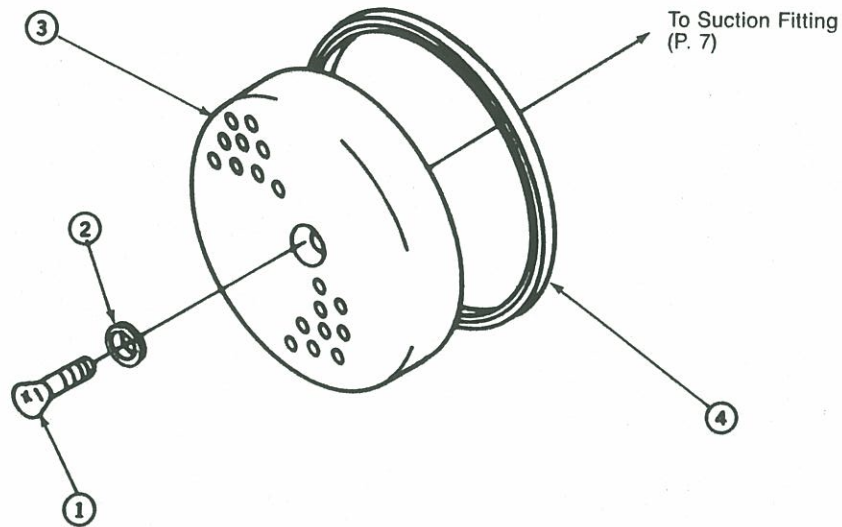

ITEM	P/N	DESCRIPTION	QTY
1	3958000	Screw, OHPM #10-24 x 1.25" L.	1
2	4506000	Washer, Counter Sunk or Finish #10	1
3	1902000	Strainer, Suction, S.S.	1
4	4507000	Suction Strainer Ring	1

SUCTION FITTING

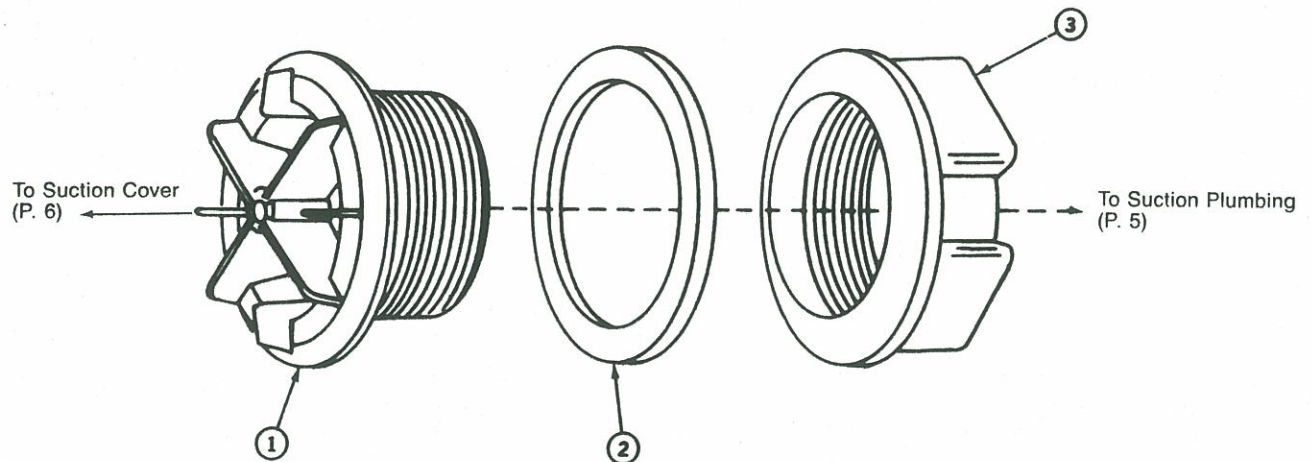

Do not use #1836000 Back-up Ring from AMH Jet. Use of non-interchangeable parts may cause leaks or malfunction.

ITEM	P/N	DESCRIPTION	QTY
1	1958000	Housing Sub-Assembly, Suction	1
2	2136000	Ring, Back-up, Suction	1
3	1643000	Nut, Locking, Suction Housing	1

AIR LINE ASSEMBLY

($\frac{5}{8}$ " Dishwasher hose, shown for reference, is not available from Jacuzzi Whirlpool Bath.)

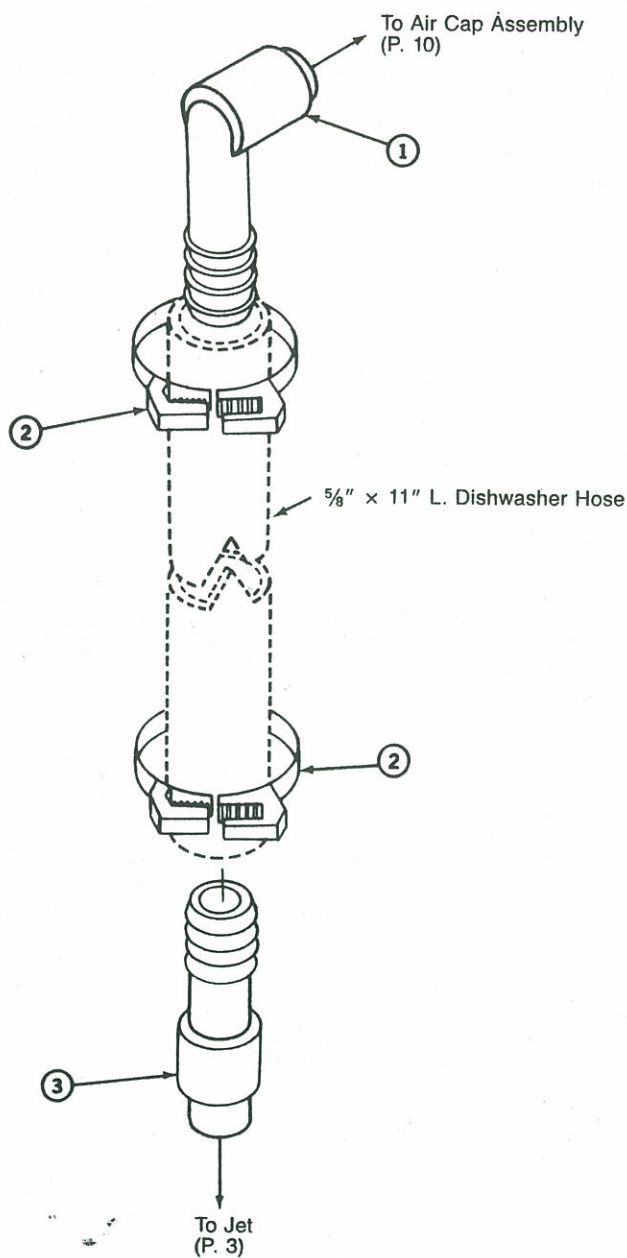

ITEM	P/N	DESCRIPTION	QTY
1	1464000	Adapter, 90° Air Line, ABS	1
2	2181000	Clamp, Hose	2
3	1463000	Adapter, Straight Air Line, ABS	1



AIR LINE ASSEMBLY WITH BLEEDER

Diagram illustrating the assembly of the vent/drain system:

- 1**: PVC Pipe (1/2" x 1.50" L.)
- 2**: Dishwasher Hose (5/8" x 11" L.)
- 3**: Air Cap Assembly (P. 10)
- 4**: Vent/Drain Assembly (P. 22)

The diagram shows the connection of the vent/drain assembly (4) to the air cap assembly (3) via the PVC pipe (1) and the dishwasher hose (2). The hose is connected to the jet (P. 3).

9

AIR CAP ASSEMBLY

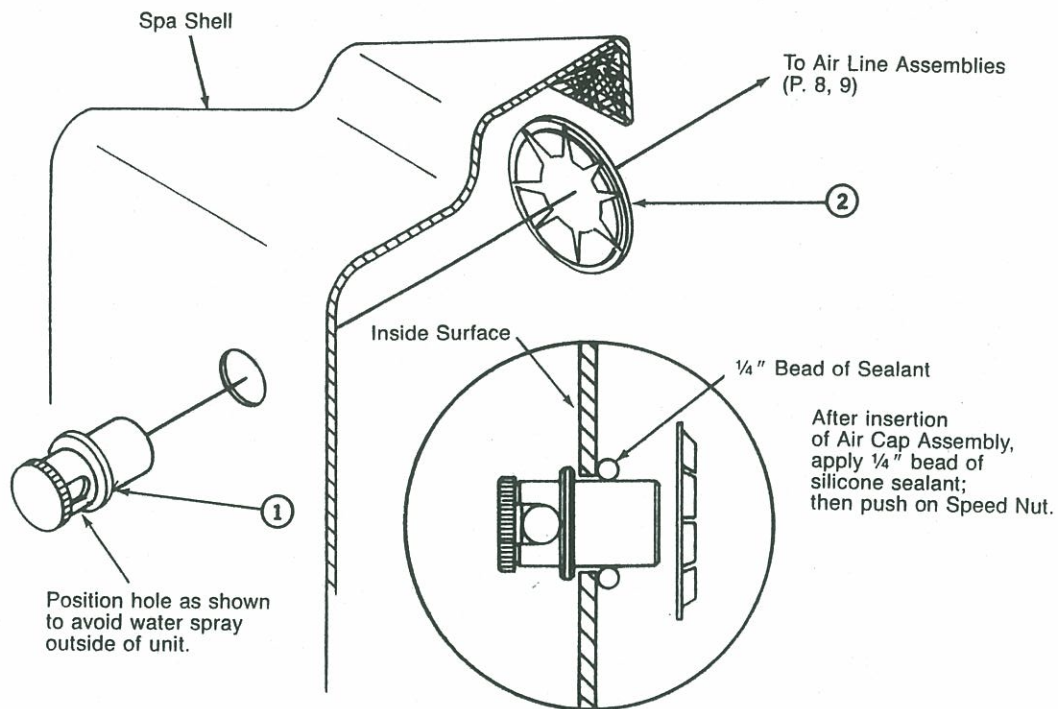

ITEM	P/N	DESCRIPTION	QTY
1	4117940	Air Cap Assembly	1
2	4319000	Speed Nut, Push-on, 1.0"	1

SAFETY SUCTION RELIEF

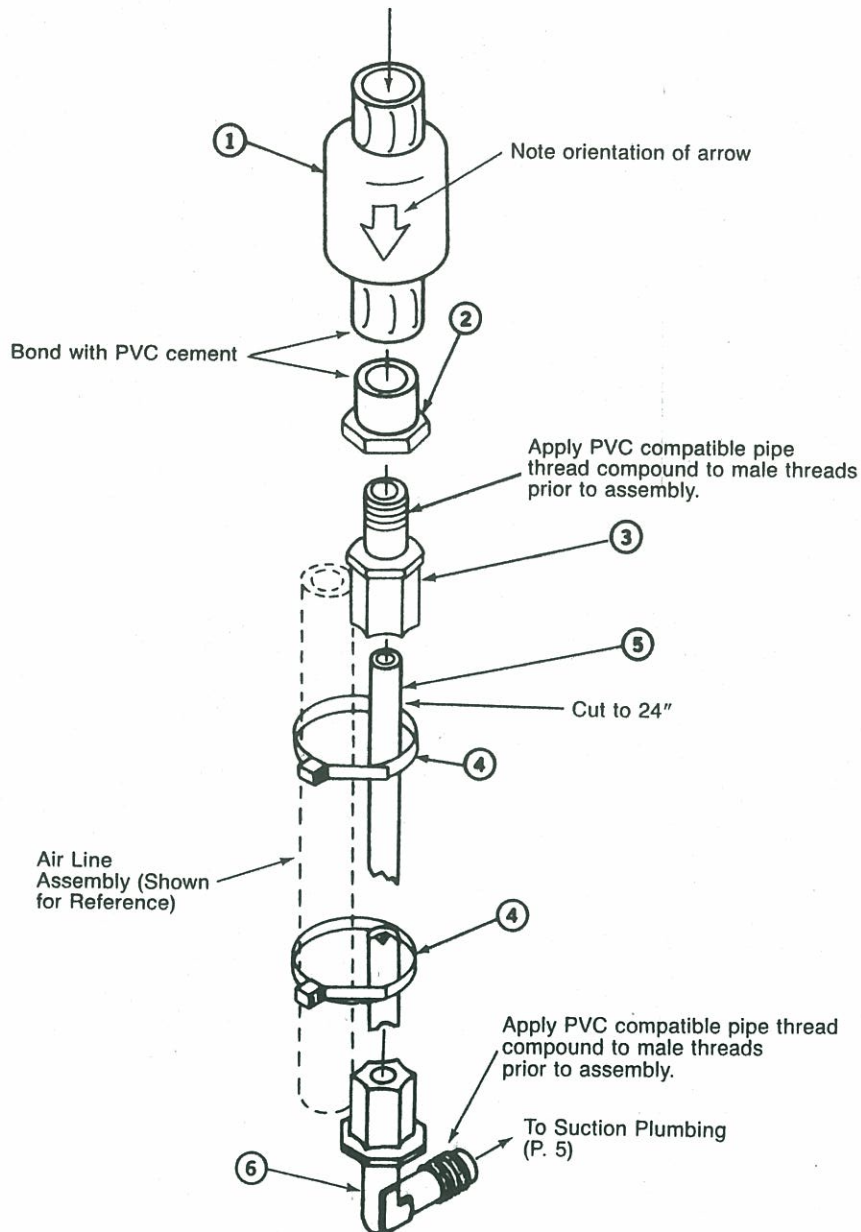

ITEM	P/N	DESCRIPTION	QTY
1	4330000	Check Valve and Spring Assembly	1
2	3064000	Bushing, Reducing, 1/2" x 1/8", SPIG x FPT	1
3	3054000	Compression Fitting, Straight, .25"	1
4	4821000	Cable Tie, Self Locking	2
5	4649000	Tubing, .25" O.D. Flex Nylon, 75' L.	1
6	3044000	Compression Fitting, 90° Ell, .25"	1

SKIMMER ASSEMBLY

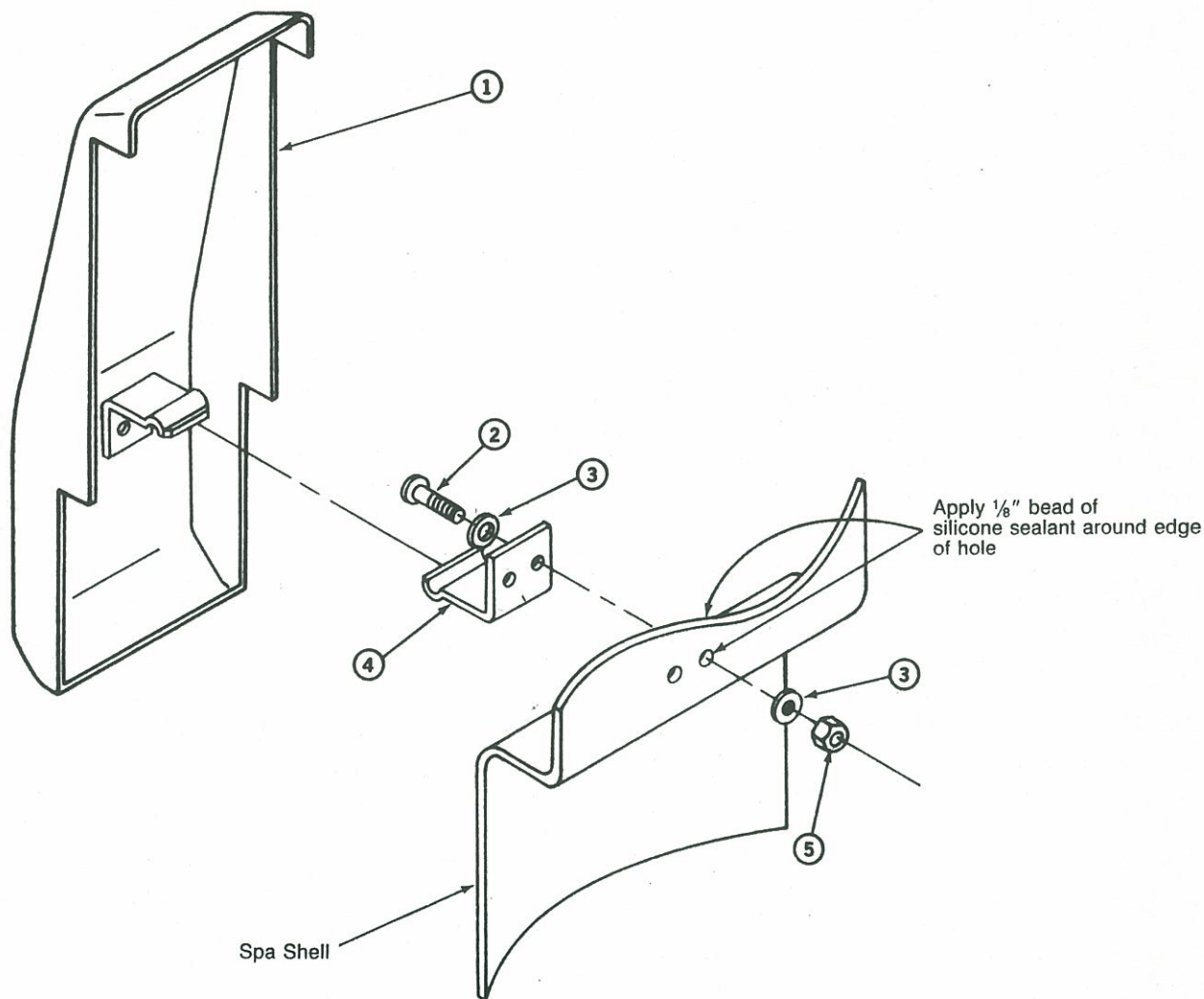

ITEM	P/N	DESCRIPTION	QTY
1	5485914	Skimmer Assembly, AL	1
1	5485921	Skimmer Assembly, CH	1
1	5485924	Skimmer Assembly, BL	1
2	3973000	Screw, Mach. PHP, #10-24 x .75" L.	2
3	4036000	Washer, #10 Flat, Type A, Pln Wd Ser	4
4	5486000	Clip, Skimmer	1
5	4033832	Nut, Locking Head KEP Type #10-24	2

FILTER AND EQUIPMENT PACK DISCHARGE PLUMBING (LEVEL 1 ONLY)

(2" and 1½" Sch. 40 PVC Piping, shown for reference, are not available from Jacuzzi Whirlpool Bath.)

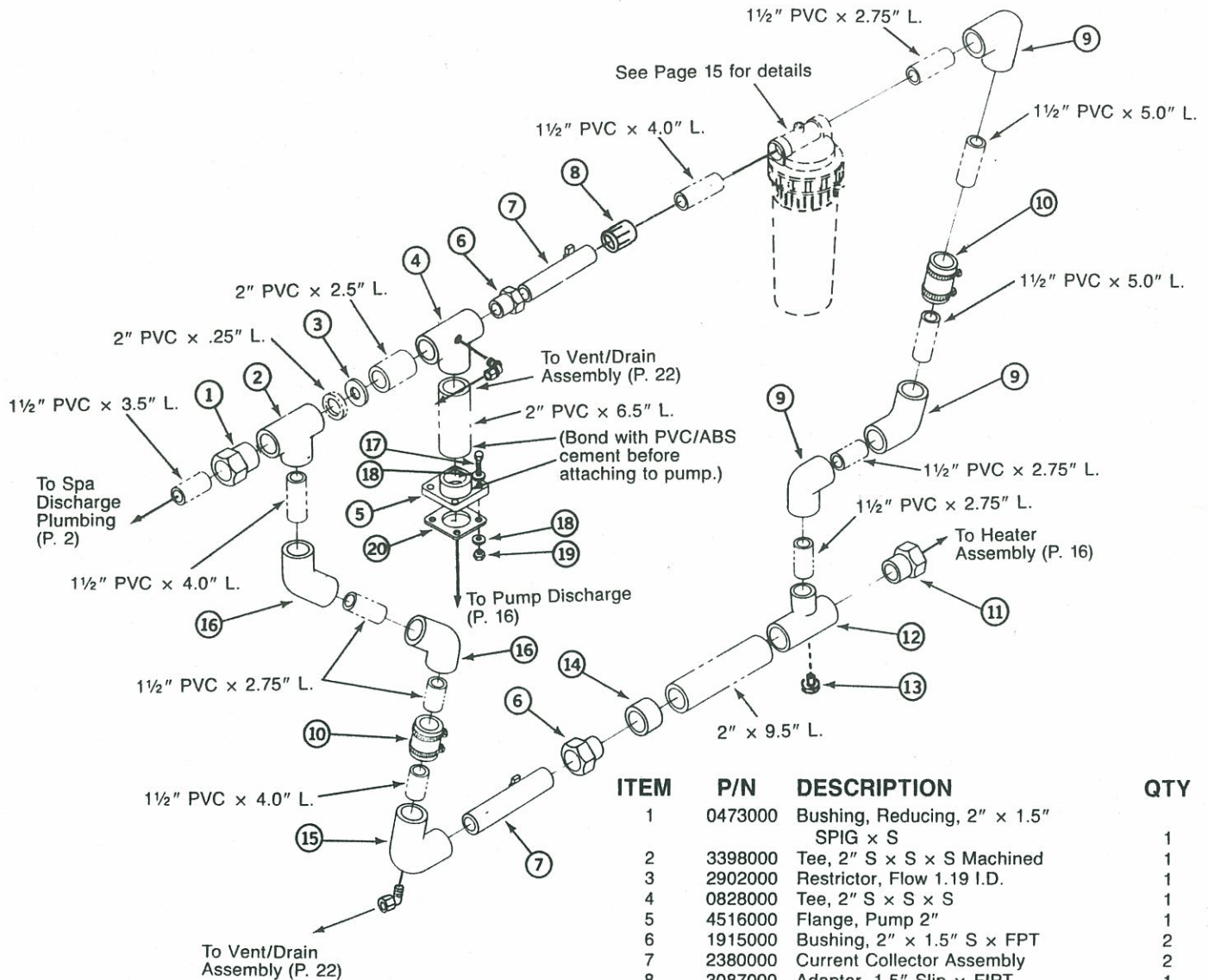

ITEM	P/N	DESCRIPTION	QTY
1	0473000	Bushing, Reducing, 2" x 1.5" SPIG x S	1
2	3398000	Tee, 2" S x S x S Machined	1
3	2902000	Restrictor, Flow 1.19 I.D.	1
4	0828000	Tee, 2" S x S x S	1
5	4516000	Flange, Pump 2"	1
6	1915000	Bushing, 2" x 1.5" S x FPT	2
7	2380000	Current Collector Assembly	2
8	3087000	Adapter, 1.5" Slip x FIPT	1
9	0239000	Elb, 90°, 1.5" S x S	3
10	2448000	Repair Piping Connector, 1.5"	2
11	5297000	Bushing, Reducing, 2" x 1½" SPIG x FPT	1
12	3152000	Tee, Reducing, 2" x 2" x 1.5" S x S x S, Mach.	1
13	0538000	Plug, Drain ⅝" NPT	1
14	0851000	Coupling, 2" S x S	1
15	2965000	Elb, 90°, 1½" S x FPT	1
16	0157000	Elb, 45°, 1½" S x S	2
17	3952832	Bolt, Hex ⅝-18 x 1.75" L.	4
18	3983832	Washer, ⅝ Flat	8
19	3993832	Nut, Hex ⅝-18	4
20	0199000	Gasket, Pump Flange	1

FILTER AND EQUIPMENT PACK DISCHARGE PLUMBING (LEVEL 2 ONLY)

(2" and 1½" Sch. 40 PVC Piping, shown for reference, are not available from Jacuzzi Whirlpool Bath.)

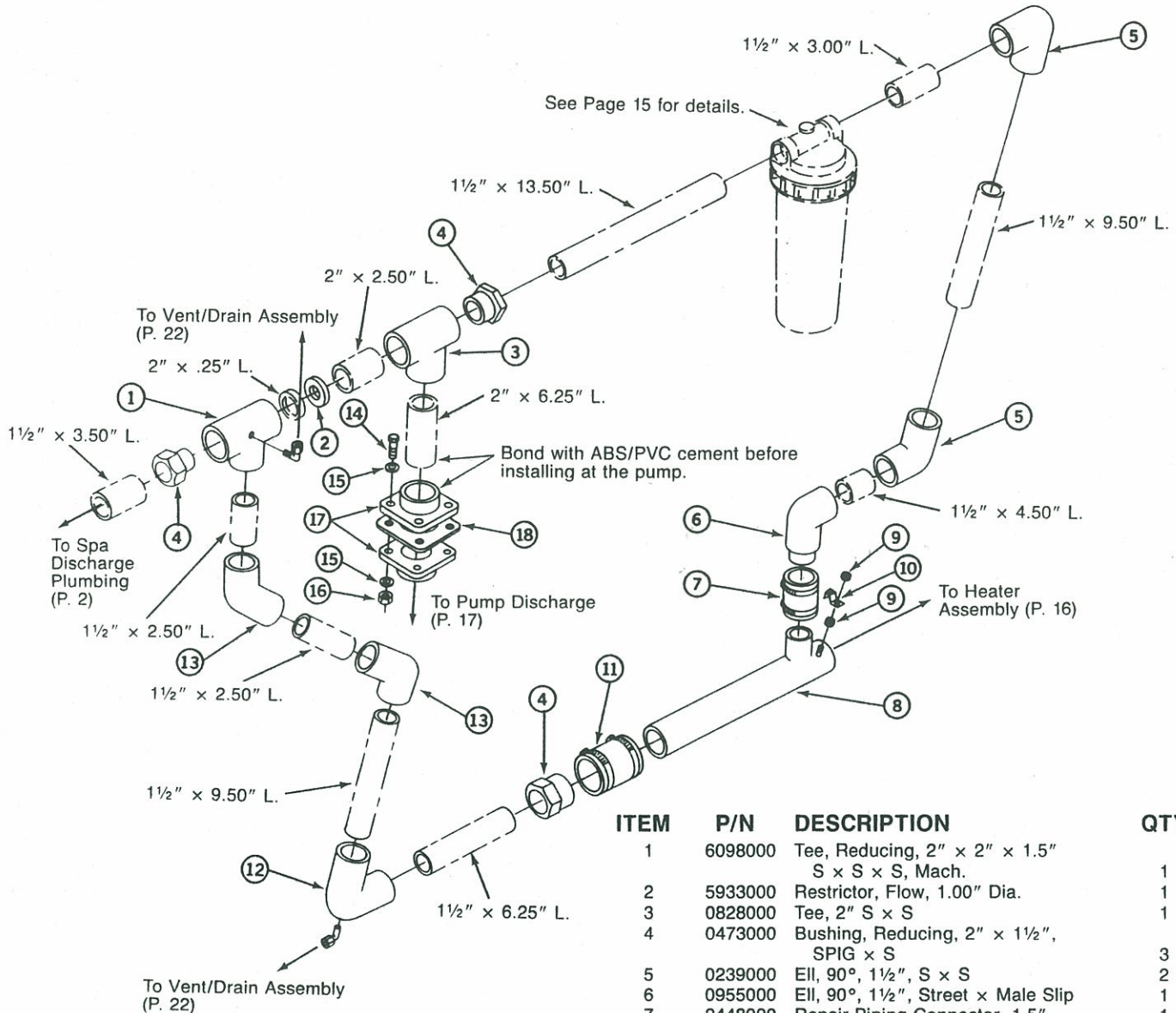

ITEM	P/N	DESCRIPTION	QTY
1	6098000	Tee, Reducing, 2" x 2" x 1.5" S x S x S, Mach.	1
2	5933000	Restrictor, Flow, 1.00" Dia.	1
3	0828000	Tee, 2" S x S	1
4	0473000	Bushing, Reducing, 2" x 1½", SPIG x S	3
5	0239000	El, 90°, 1½", S x S	2
6	0955000	El, 90°, 1½", Street x Male Slip	1
7	2448000	Repair Piping Connector, 1.5"	1
8	5619000	Housing, Heater, 1¼" NPT, SST	1
9	4033832	Nut, Locking, Hd KEP Type #10-24	2
10	2133000	Lug, Copper Cable Connector	1
11	2634000	Repair Piping Connector, 2"	1
12	5822000	El, 1½", 90°, Machined	1
13	0157000	El, 45°, 1½", S x S	2
14	3952832	Bolt, Hex 5/16-18 x 1.75" L.	4
15	3983832	Washer, 5/16 Flt, Type A Pln Wd Ser	8
16	3993832	Nut, Hex, UNC-2B 5/16-18	4
17	4516000	Flange, Pump 2"	2
18	0199000	Gasket, Pump Flange	1

FILTER ASSEMBLY, 25 SQ. FT.

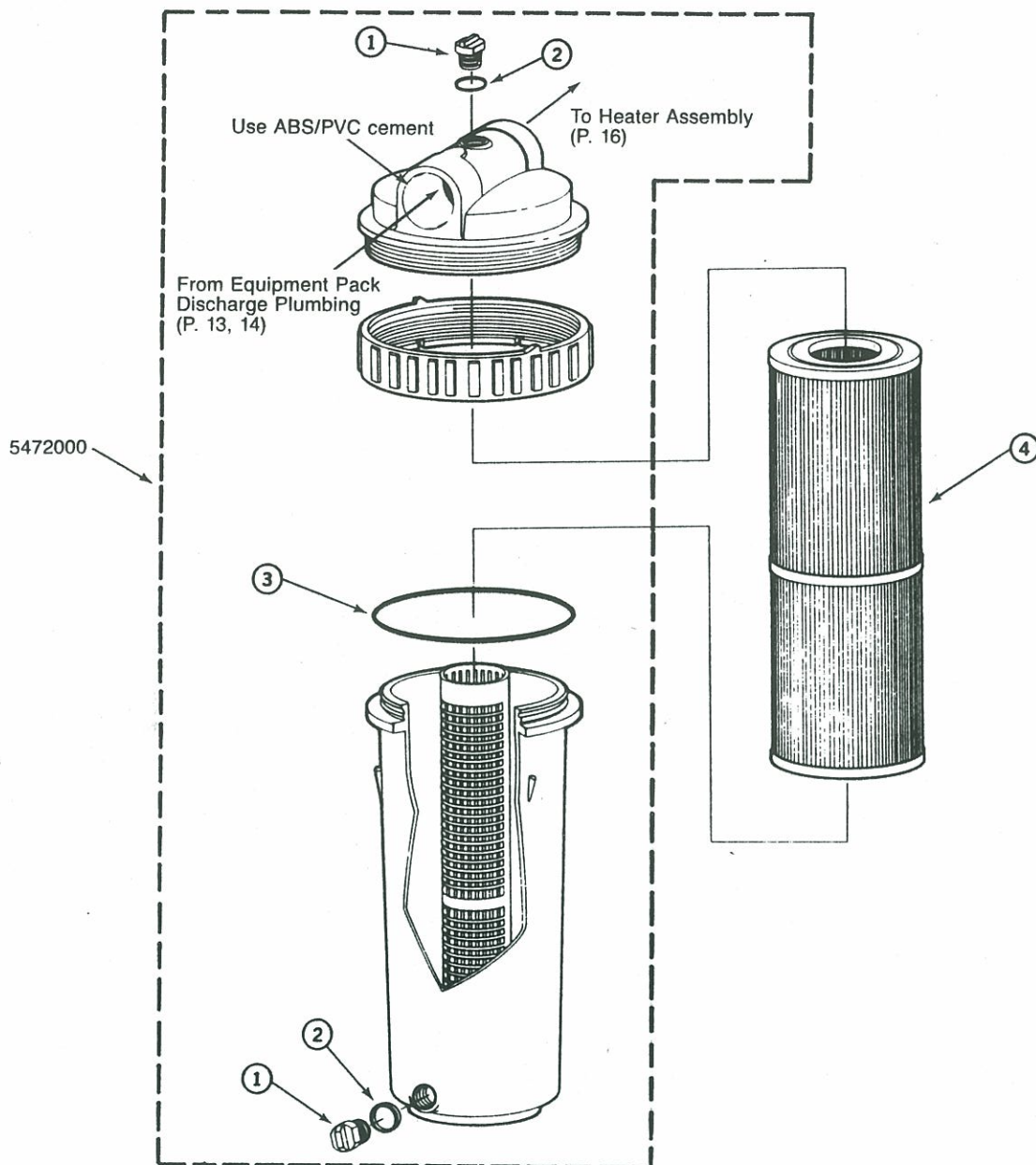

*5472000 Filter Assembly

ITEM	P/N	DESCRIPTION	QTY
1	6187000	Plug, Vent/Drain	2
2	6185000	O-ring, .487" I.D. x .693" O.D.	2
3	6186000	O-ring, 5.850" I.D. x 6.270" O.D.	1
4	**5475000	Filter Cartridge, 25 Sq. Ft.	1
N.S.	5184000	Lubricant, Silicone, 2cc Tube	1

*Available by assembly number or by individual parts as shown per callouts.

**Must be ordered separately.

HEATER ASSEMBLY

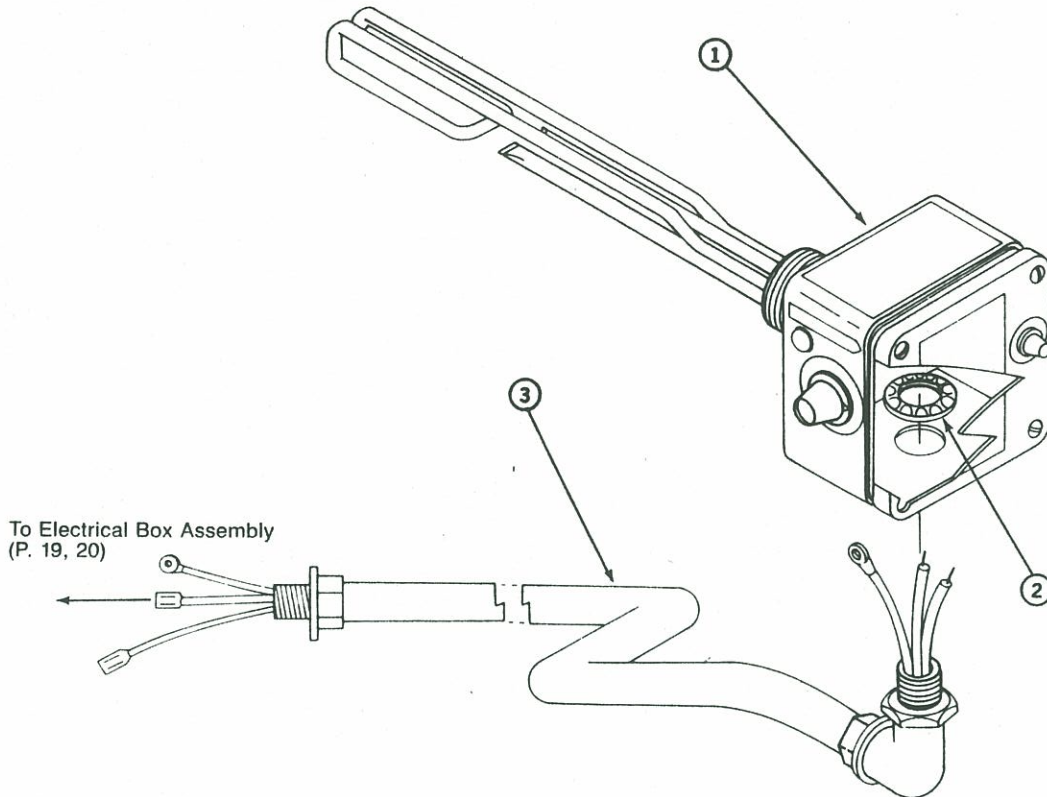

ITEM	P/N	DESCRIPTION	QTY
1	5251000	Heater, 1.5 KW, 120 VAC	1
2	4826832	Locknut, Rigid Metal Conduit	1
3	* 5480000	Heater Cord Assembly	1
4	**6376000	Cord Assembly, Heater 5 Wire	1

*Applicable to Level 1 Units.

**Applicable to Level 2 Units.

PUMP ASSEMBLY

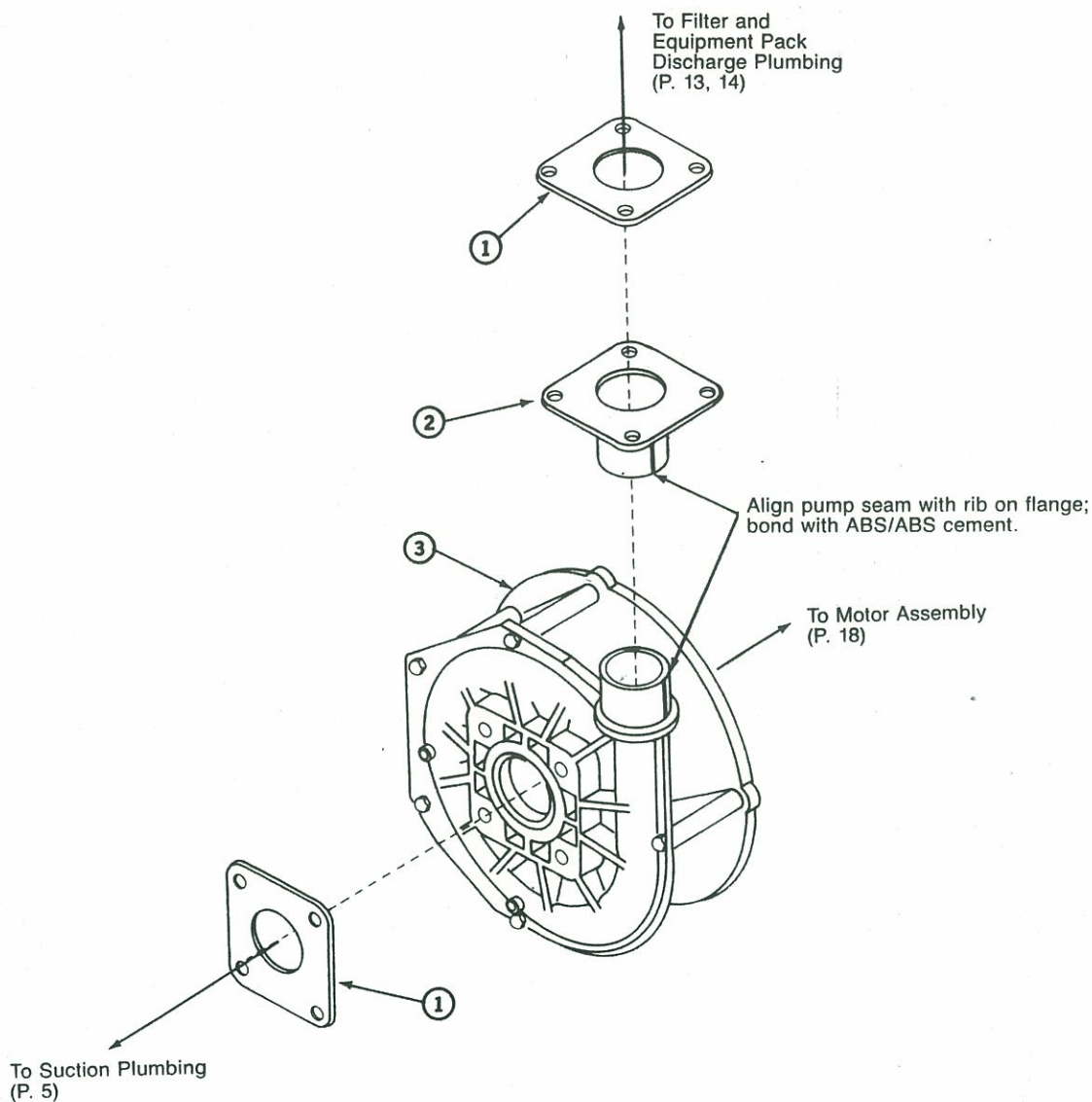

ITEM	P/N	DESCRIPTION	QTY
1	0199000	Gasket, Pump Flange	2
2	4516000	Flange, Pump, 2"	1
3	4634000	.75 HP Pump Assembly	1

MOTOR AND BRACKET ASSEMBLY

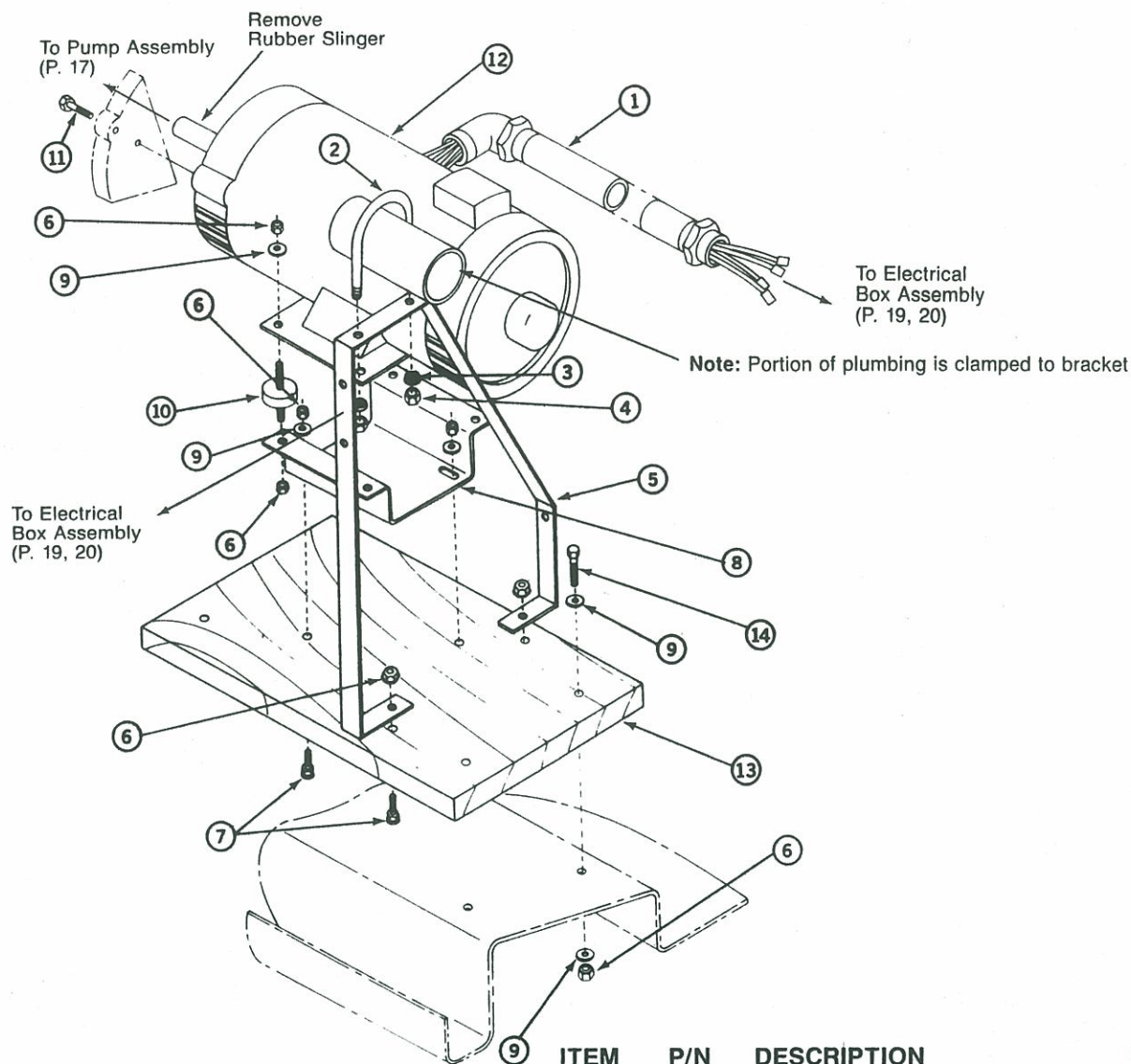

ITEM	P/N	DESCRIPTION	QTY
1	5478000	Motor Cord	1
2	5277832	U-Bolt, 2.5" I.D. x 3.19" x 5/16"	1
3	4013832	Washer, 5/16 Ext. Tooth, Locking	2
4	3993832	Nut, Hex, UNC-2B 5/16-18	2
5	5271000	Filter Bracket, Espree	1
6	4034832	Nut, Locking Head KEP Type 1/4-20	15
7	4022832	Bolt, Rnd Hd., Sq. Neck 1/4-20 x 1.5" L.	4
8	4477000	Bracket, Motor, (1" High)	1
9	3982832	Washer, 1/4 Flt., Type A Pln Wd Ser	12
10	3689000	Vibration Damper	4
11	3953832	Bolt, Hex 3/8-16 x 1" L.	4
12	2812000	Motor, .75 HP (115 V) 2-Spd, Drip-proof	1
13	5490000	Base, Equipment Pack—Espree	1
14	3947832	Bolt, Hex 1/4-20 x 1.5" L.	3

ELECTRICAL BOX ASSEMBLY (LEVEL 1 ONLY)

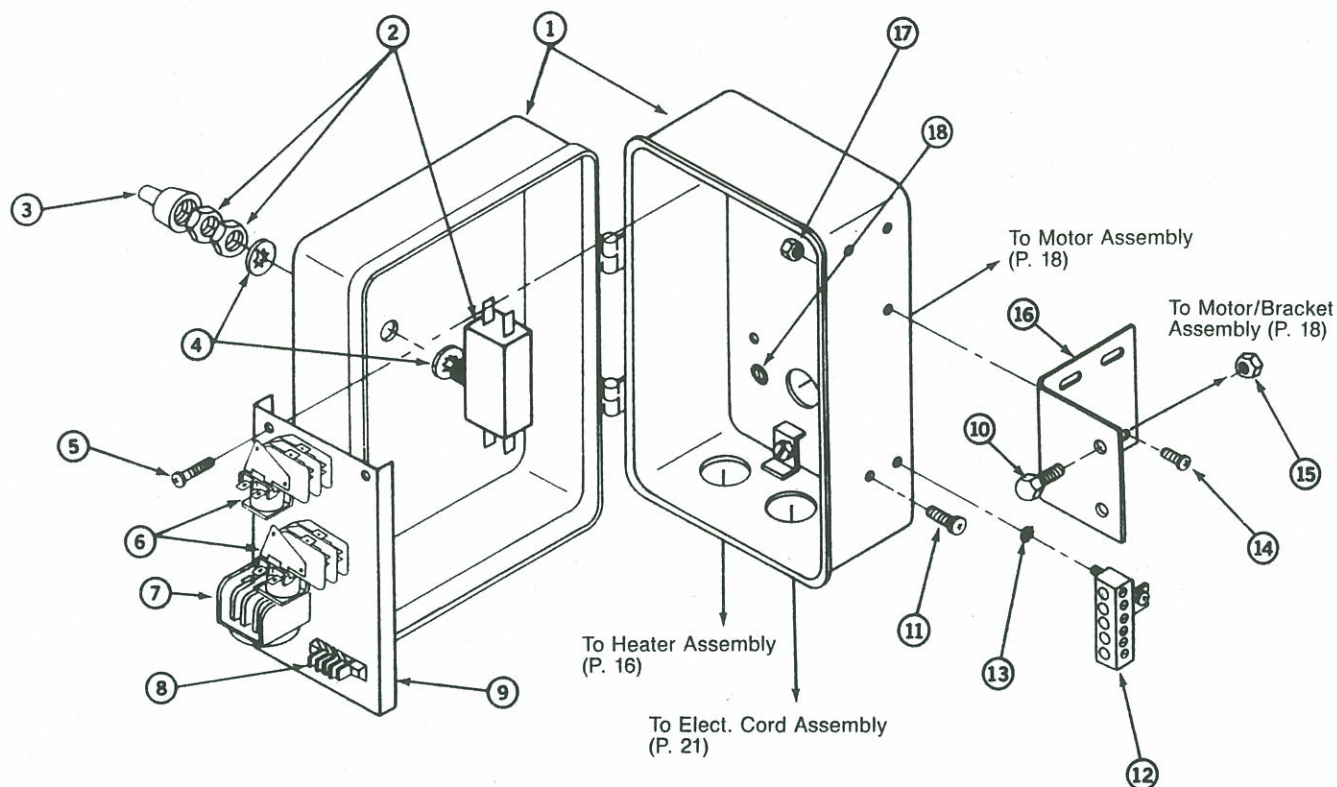

ITEM	P/N	DESCRIPTION	QTY
1	5257000	Box, Electrical, Machined	1
2	5254000	Switch, Push Button, DPST 15 A	1
3	*5483000	Boot, Push Button Switch	NLA
4	5488000	Washer, $\frac{3}{8}$ Internal Tooth, Locking	2
5	4041832	Screw, TPG, PHP, Type F #8-32 x .75" L.	3
6	5209000	Switch, DPDT, Solenoid Activated	2
7	5260000	Switch, Sequencing, 4 Funct., Air	1
8	5258000	Terminal Block, 4 Circuit, .25" Tab	1
9	5256000	Subplate, Electrical Box	1
10	3944832	Bolt, Hex $\frac{1}{4}$ -20 x .75" L.	2
11	4040832	Screw, Tapping, PHP, Type F 8-32 x .5" L.	1
12	1974000	Bar, Bonding	1
13	4012832	Washer, #10 External Tooth, Locking	1
14	3966000	Screw, Mach., PHP, #8-32 x .38" L.	3
15	4034832	Nut, Locking HD, KEP Type, $\frac{1}{4}$ -20	2
16	5270000	Bracket, Electrical Box, Espree	1
17	5269832	Nut, Locking Head, KEP Type #8-32	3
18	5279000	Grommet, .188" I.D.	1
19	5267000	Label, Switch Functioning Sequence	1
20	1980000	Label, Bonding Bar	1
21	5255000	Label, Electrical Wiring Diagram	1
22	5268000	Label, GFCI and Temperature Caution	1

*Item 3 is no longer available as a repair part.

ELECTRICAL BOX ASSEMBLY (LEVEL 2 ONLY)

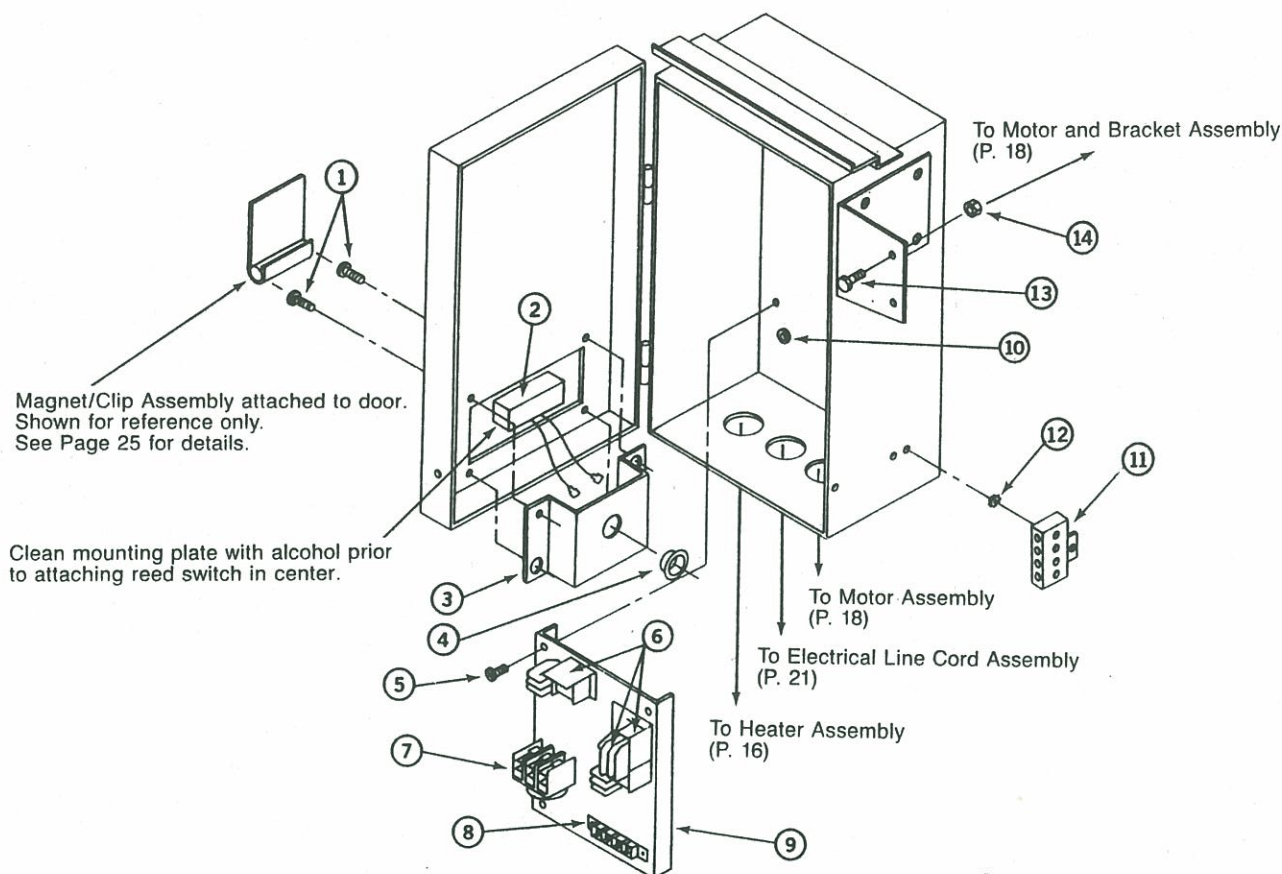

ITEM	P/N	DESCRIPTION	QTY
1	4040832	Screw, TPG, PHP, Type F #8-32 x .50" L.	2
2	6366000	Reed Switch/Terminal Assembly	1
3	6361000	Shield, Reed Switch	1
4	2369000	Bushing, Open/Closed	1
5	4041832	Screw, TPG, PHP, Type F #8-32 x .75" L.	3
6	5209000	Switch, DPDT, Solenoid Actuated	3
7	5260000	Switch, Sequence, 4-function, Air Actuated	1
8	5258000	Terminal Block, 4-circuit, .25" TB	1
9	5256000	Sub-Plate, Electrical Box	1
10	5279000	Grommet, .188" I.D.	1
11	1974000	Bar, Bonding	1
12	4012832	Washer, #9-16 Extnl. Tooth, Locking	1
13	3944832	Bolt, Hex 1/4-20 x .75" L.	2
14	4034832	Nut, Locking Hd KEP Type 1/4-20	2

ELECTRICAL LINE CORD ASSEMBLY

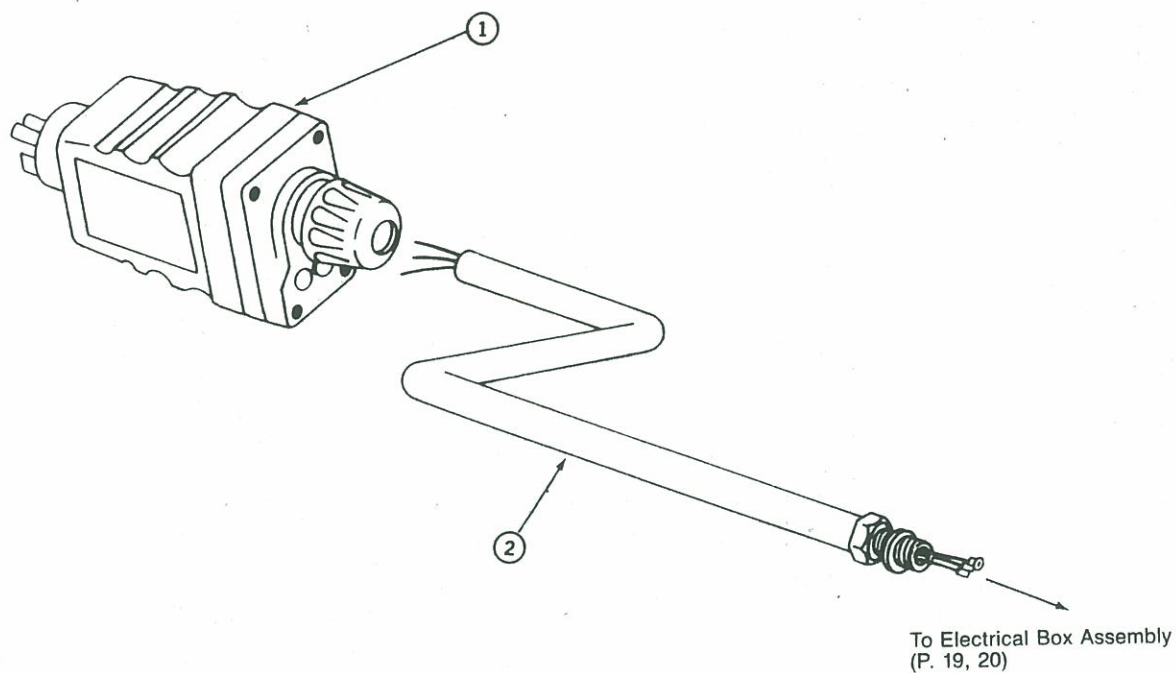

ITEM	P/N	DESCRIPTION	QTY
1	4653000	GFCI, Cord End Plug	1
2	5667000	REPR Supply Cord Assembly	1

VENT/DRAIN ASSEMBLIES

NOTE: Apply PVC compatible pipe thread compound to male threads prior to assembly.

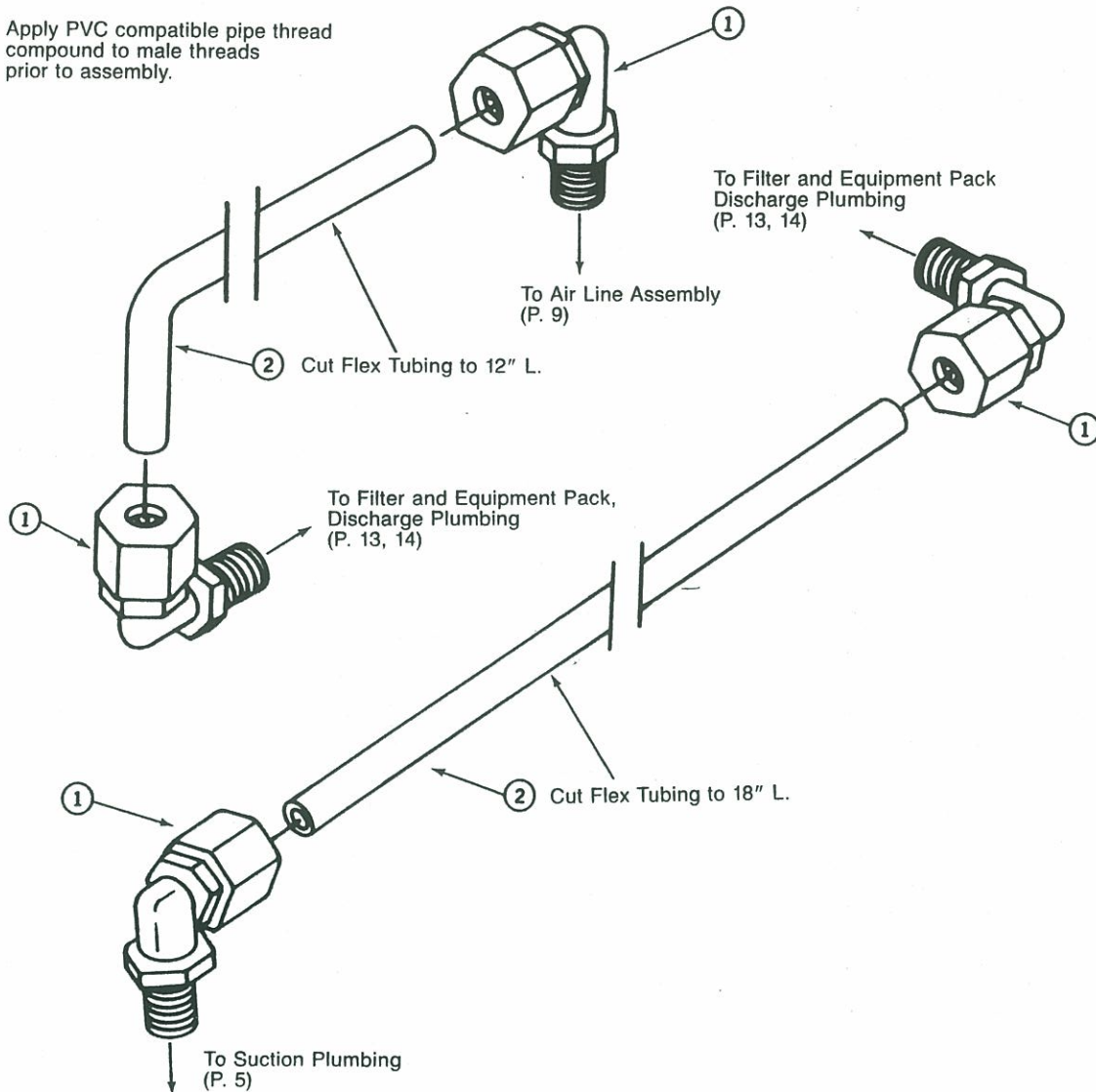

ITEM	P/N	DESCRIPTION	QTY
1	3044000	Compression Fitting 90° Ell, .25"	4
2	4649000	Tube, .25" O.D. Flex Nylon x 75.00" L.	2



ESPREE II

Model #5630000 Level 1
Model #5630000 Level 2
Issue Date: 12/85

SPA COVER

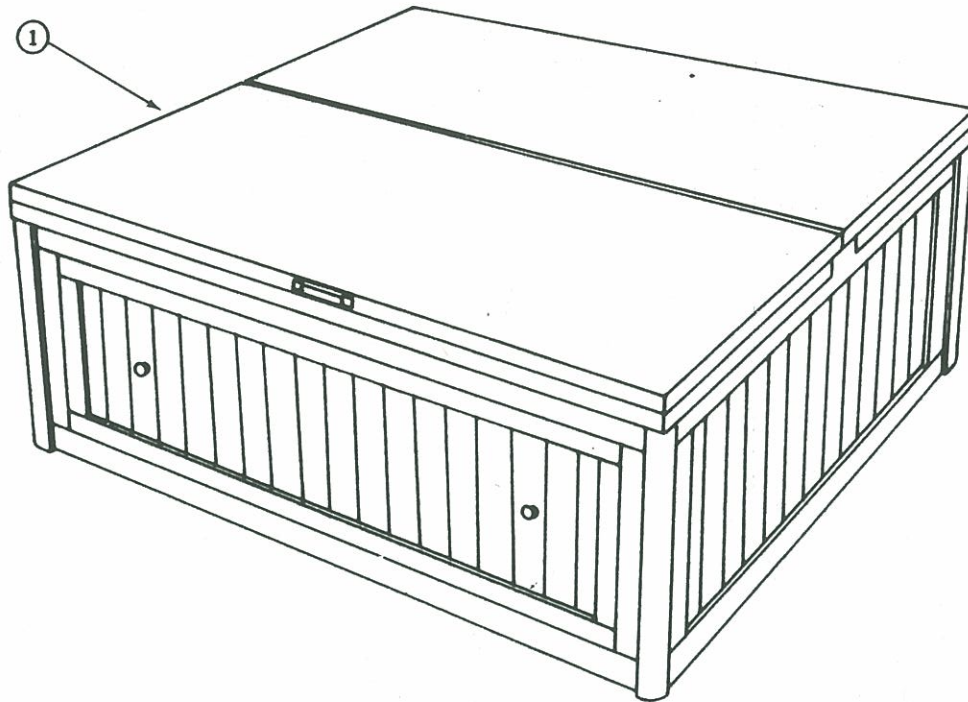

ITEM	P/N	DESCRIPTION	QTY
1	5636000	Spa Cover, Espree	1

SKIRT ASSEMBLY (LEVEL 1 ONLY)

NOTE: Removable insulating foam batts not shown. To remove foam batts, remove side skirts and back skirt, and lift up from bottom of batts and swing out. To re-install foam batts, position under lip of shell and swing into place.

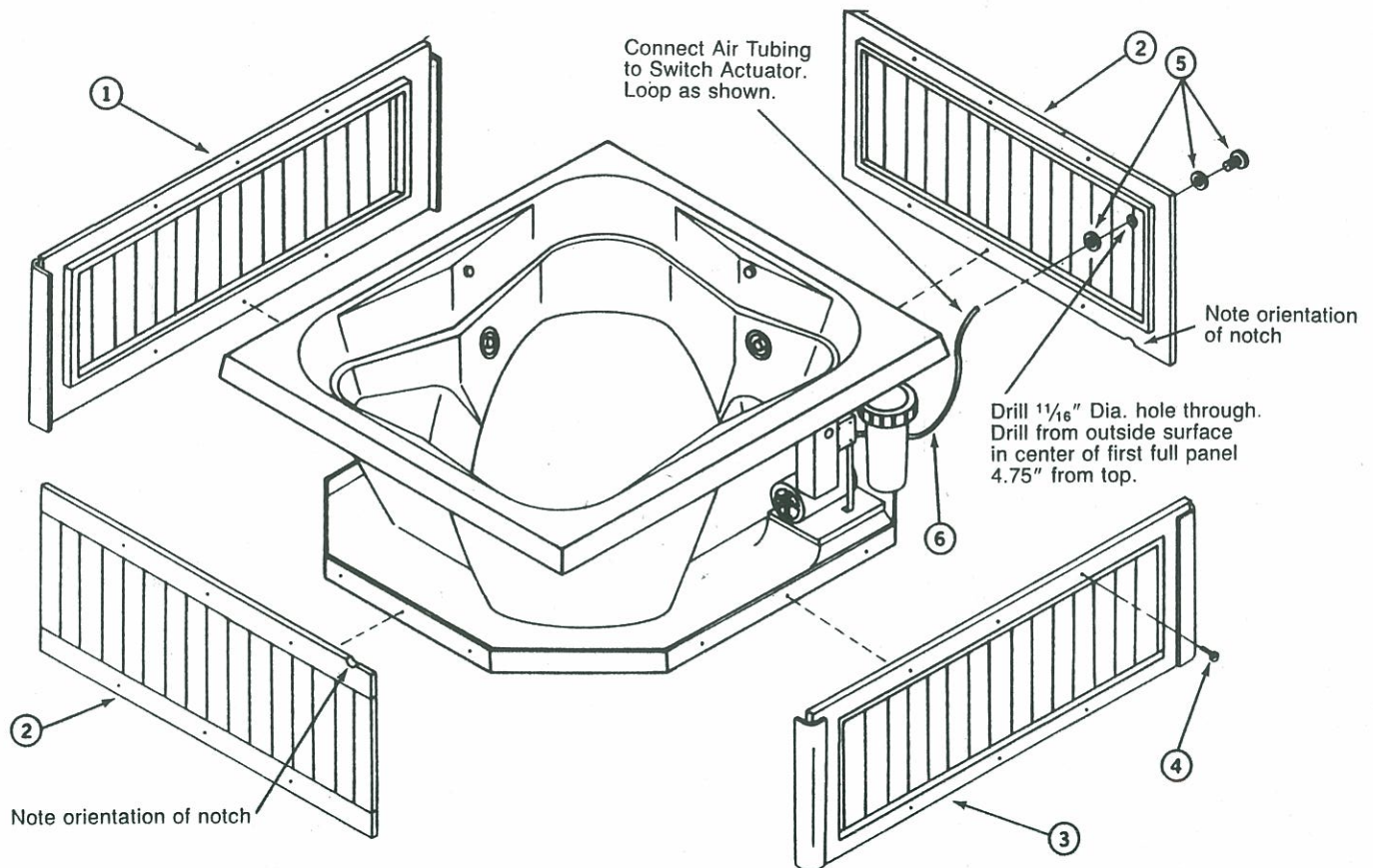

ITEM	P/N	DESCRIPTION	QTY
1	5272000	Skirt, Back Redwood, Espree	1
2	5273000	Skirt, Side Redwood, Espree	2
3	5669000	Skirt, Front Redwood, Espree	1
4	5303837	Screw, Drywall, TEK #6 x 1.63" L.	24
5	5259000	Actuator, Sequence Switch	1
6	5673000	Tubing, Air Switch	42"

SKIRT ASSEMBLY (LEVEL 2 ONLY)

NOTE: Removable insulating foam batts not shown. To remove foam batts, remove side skirts and back skirt, and lift up from bottom of batts and swing out. To re-install foam batts, position under lip of shell and swing into place.

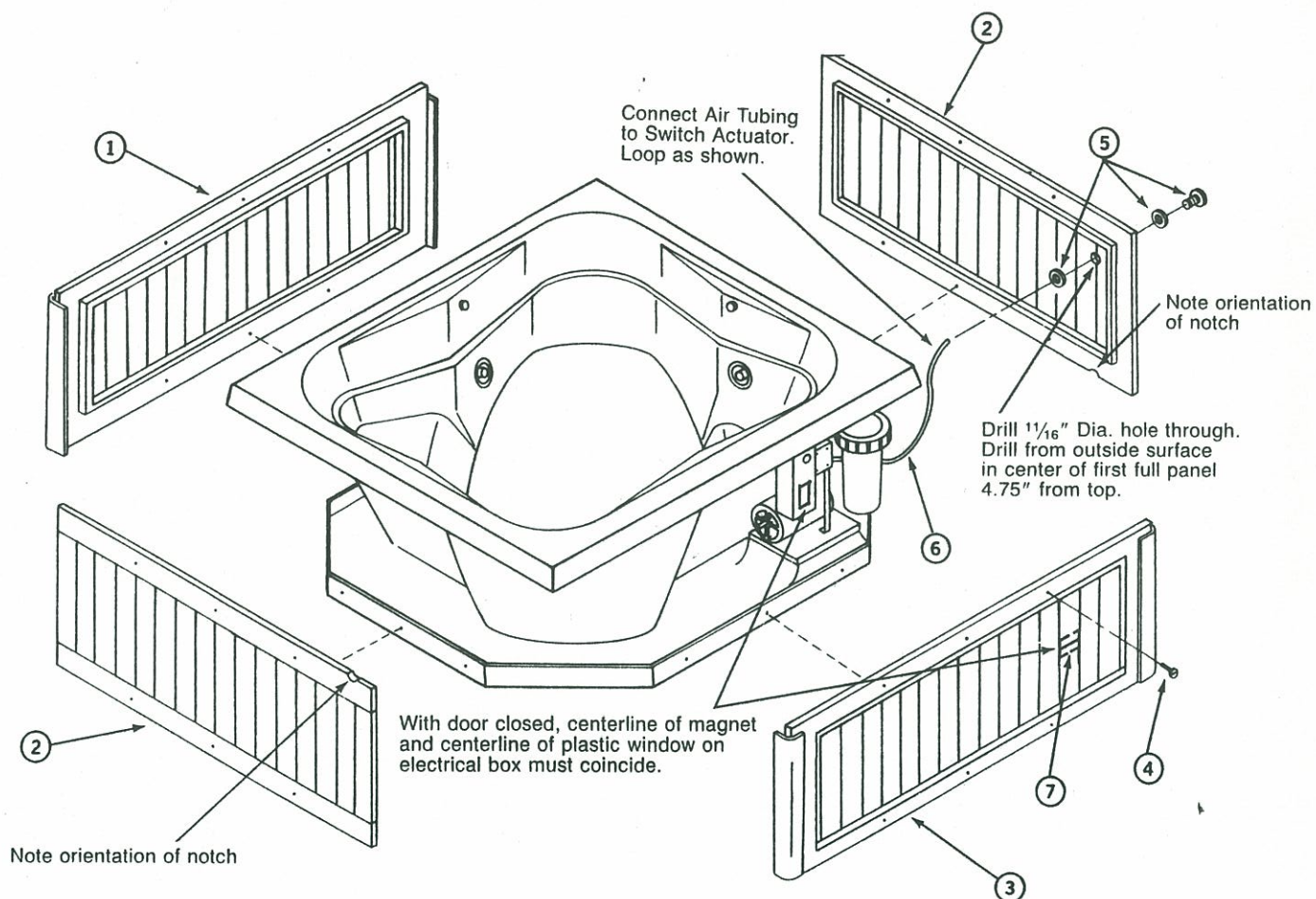

ITEM	P/N	DESCRIPTION	QTY
1	5272000	Skirt, Back Redwood, Espree	1
2	5273000	Skirt, Side Redwood, Espree	2
3	5669000**	Skirt, Front Redwood, Espree	1
4	5303837	Screw, Drywall, TEK #6 x 1.63" L.	24
5	5259000	Actuator, Sequence Switch	1
6	5673000	Tubing, Air Switch	42"
7	6357000	Magnet/Clip Assembly	1

CARTON ASSEMBLY

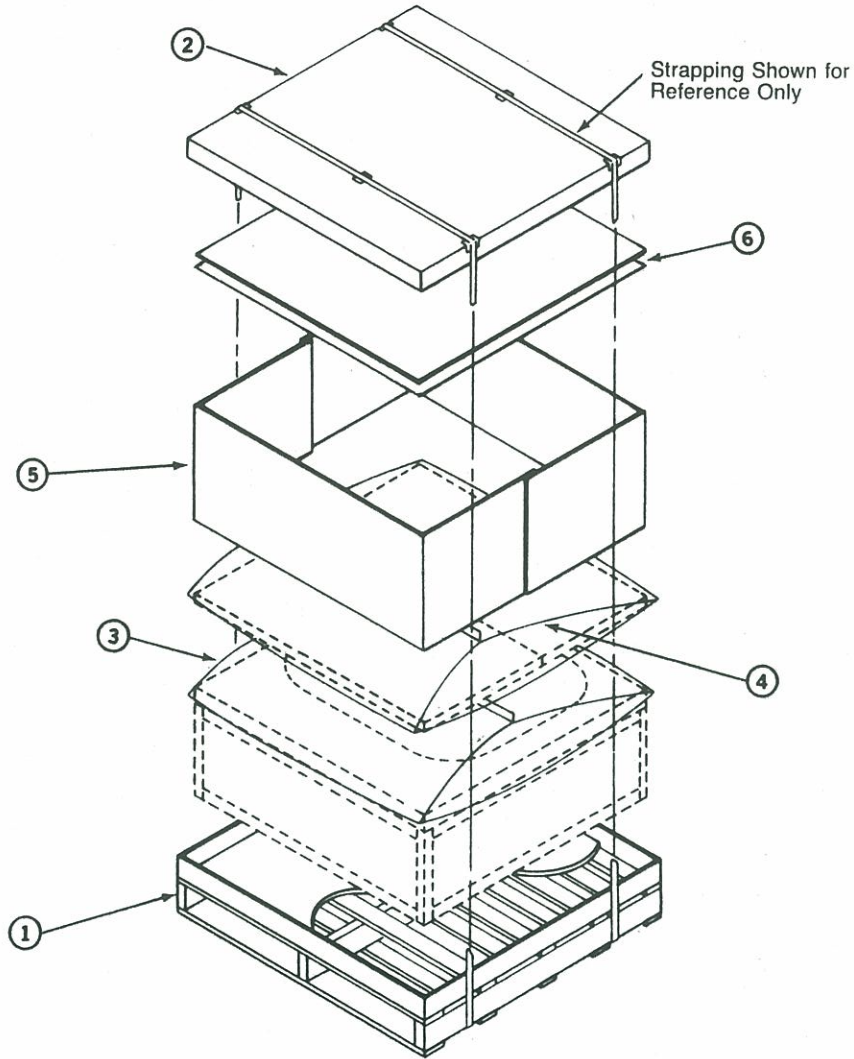

(6700000) REPAIR CARTON ASSEMBLY, ESPREE II

ITEM	P/N	DESCRIPTION	QTY
1	2935000*	Pallet Assembly	1
2	2936000*	Carton, Tray	2
3	4900000*	Bag, Gusseted, 68" x 74" x 30"	1
4	2080000*	Sheet, 8 ft. x 4 Mil Poly	8 ft.
5	5671000*	U-Pad, Scored, Espree Carton	4
6	4411000*	Pad, 66.5" x 72.5"	2

*Not available as single parts.



ESPREE II

Model #5630000 Level 1
Model #5630000 Level 2
Issue Date: 12/85

OTHER ITEMS AVAILABLE

- 0802000 Electric Heater, 11.5 KW 230 VAC
- 5010000 Gas Heater, 55,000 BTU
- 5020000 Repair Kit, Almond, Acrylic/Lacquer
- 5055000 Repair Kit, Sandstone Marble, Acrylic/Lacquer
- 5400000 Timer, Portable
- 6072000 Repair Kit, Blue Marble, Acrylic/Lacquer

Limited 90-Day Warranty on Replacement Parts

Warranty Coverage

Jacuzzi Whirlpool Bath (the "Company") provides a limited material and labor warranty on its replacement parts.

Our warranty extends to the original purchaser of the replacement parts who buys it for installation in a Company product used for personal, family or household purposes ("user"). It does not extend to purchasers who intend to resell the product. Additional limitations apply to commercial users, and special rules apply to dealers and distributors.

Our warranty is ninety (90) days, beginning on the date the replacement part was installed or purchased by the user, whichever is later.

Our warranty covers: All replacement parts against defects in material or workmanship, or failure to operate in accordance with the performance ratings for the part.

Without charge to the user, the Company will, at its option, either repair the defective part or replace the defective part.

Warranty Service

In order to obtain service provided under this warranty, during regular business hours contact a Jacuzzi Whirlpool Bath Authorized Service Agent or the Dealer/Distributor who sold the part and describe the problem. (See the white pages of your local telephone book for the location of the nearest Authorized Service Agent.) An Authorized Service Agent will contact the user, inspect the system, and provide the service described herein.

Warranty Limitations

Our warranty is limited and does not cover defects, damage, or failure caused by the installer, user or other person, including but not limited to the following: improper installation or installation not in accordance with the instructions and specifications provided with the part or system; any type of modification of any part or component, including modification to meet local codes; misuse; lack of maintenance or improper maintenance or operation; use of chemicals in units with gold-plated fixtures; improper connections by the installer; improper voltage supply; careless handling; operation of the system without minimum amount of water in the vessel as specified in the Operating Instructions; acts of God.

In addition, the Company will not be responsible for any incidental or consequential damages or losses, direct or indirect, arising from any cause whatsoever; shipping damage; alleged factory damage or defect which was not reported to the Company prior to installation; compliance with local building codes.

Commercial Limitations

In addition to the user Warranty Limitations, our warranty does not cover commercial installations when the part or system has been altered or modified in any way. The part or system is sold on an "as is" basis, and the Company is not responsible for loss of use or profit under any circumstances.

Implied Warranties

Implied warranties of merchantability and fitness for a particular purpose, to the extent that they are applicable, are limited to ninety (90) days from the date of purchase or installation, whichever is later.

Notice: This warranty gives you specific legal rights, and you may also have other rights which vary from state to state. There are no warranties applicable to Jacuzzi Whirlpool Bath producers except as expressly stated herein or as implied in applicable state and Federal laws. The Company will not be responsible for any statements or representations made in any form that go beyond, are broader than, or are inconsistent with authorized literature or specifications furnished by the Company. Some states do not allow limitations on how long an implied warranty lasts, so the above limitation may not apply to you. Also, some states do not allow the exclusion of incidental or consequential damages, so the above limitation or exclusion may not apply to you.

Responsibility to Others

Inspecting the replacement part prior to installation is the responsibility of the user or installer or building contractor who acts on behalf of the user. He is responsible for ensuring the replacement part is free of defects or damage. In the event of a problem, the replacement part must not be installed. The Company is not responsible for defects or damage that could have been discovered, repaired, or avoided by inspection and testing the replacement part prior to installation.

Damage occurring to the replacement part during or after installation is the responsibility of the installer and/or building contractor.

PRODUCT SPECIFICATIONS ARE SUBJECT TO CHANGE WITHOUT NOTICE

Jacuzzi Whirlpool Bath has obtained applicable code (standards) listings generally available on a national basis for products of this type. It is the responsibility of the installer/owner to determine specific local code compliances prior to installation of the product. Jacuzzi Whirlpool Bath makes no representation or warranty regarding, and will not be responsible for any code compliance.

JACUZZI WHIRLPOOL BATH

Subsidiary of Kidde, Inc.

KIDDE

298 North Wiget Lane, P.O. Drawer J, Walnut Creek, CA 94596 (415) 938-7070

Jacuzzi Whirlpool Bath Regional Offices

Western Region: 335 Fischer Ave., Costa Mesa, CA 92626 (714) 751-1244

Great Lakes Region: 415 W. Golf Rd., Suite 49, Arlington Heights, IL 60005 (312) 640-1300

Central Region: 13720 Midway Rd., Suite 110, Dallas, TX 75244 (214) 233-5572

Southeast Region: 2500 Park Central Blvd., Decatur, GA 30035 (404) 981-8222

Northeast Region: West Essex Plaza II, 1129 Bloomfield Ave., West Caldwell, NJ 07006 (201) 575-7710