

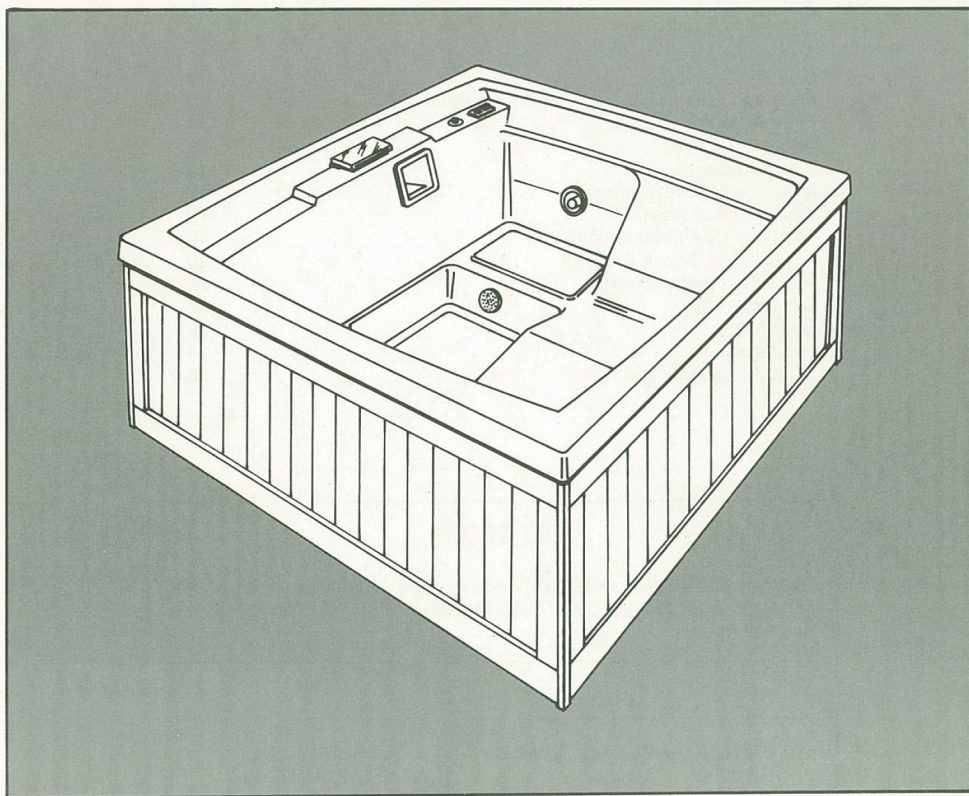

The CARESSA™ Whirlpool Spa



PARTS CATALOG

Model #5600000 Level 1

Issue Date: 6/85

Catalog #6497000

CONTENTS

	Page
Caressa Reference	1
Spa Discharge Plumbing	2
Water Rainbow Fill Spout Assembly	3
AMH Jet	4
AMH Jet Trim	5
Suction Plumbing	6
Suction Cover/Strainer	7
Suction Fitting	8
Air Line Piping	9
Air Control Assembly	10
Air Control Knob	11
Skimmer Assembly	12
Filter and Equipment Pack Discharge Plumbing	13
Filter Assembly, 25 Sq. Ft.	14
Heater Assembly	15
Pump Assembly	16
Motor/Bracket Assembly	17
Electrical Box Assembly	18
Electrical Line Cord Assembly	19
Sequencing Switch Actuator	20
Vent/Drain Assemblies	21
Skirt Assembly	22
Spa Cover	23
Packaging	24
Other Items Available	25

TO ORDER

Order by part numbers unless otherwise noted. Quantities shown in this catalog indicate the number of items required. When ordering, specify the quantity needed.

PART NO.	MODEL	LEVEL	DESCRIPTION
5600000	Caressa	1	Acrylic Shell; AMH Jets; .75 HP Motor/Pump Assembly; Water Rainbow Fill Spout Assembly; Four- Function Control Switch; Factory-Installed Redwood Skirt; Silent Air Induction System

Repair Assemblies are Referenced to Page Numbers Shown Below.

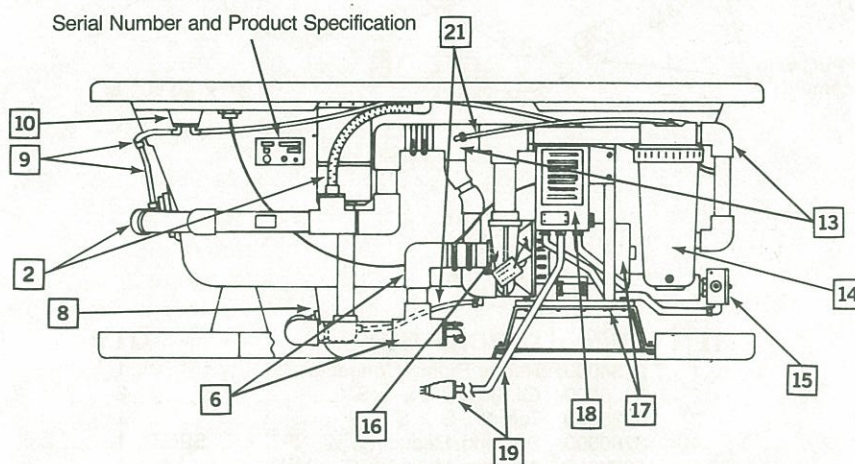
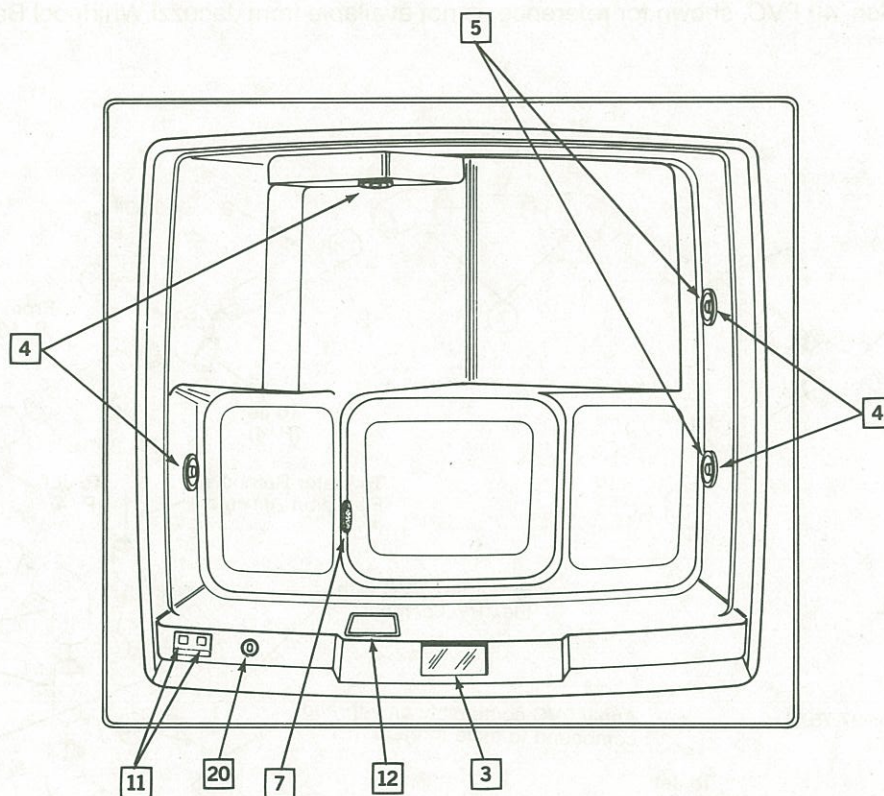

SPA DISCHARGE PLUMBING

(2" Sch. 40 PVC, shown for reference, is not available from Jacuzzi Whirlpool Bath.)

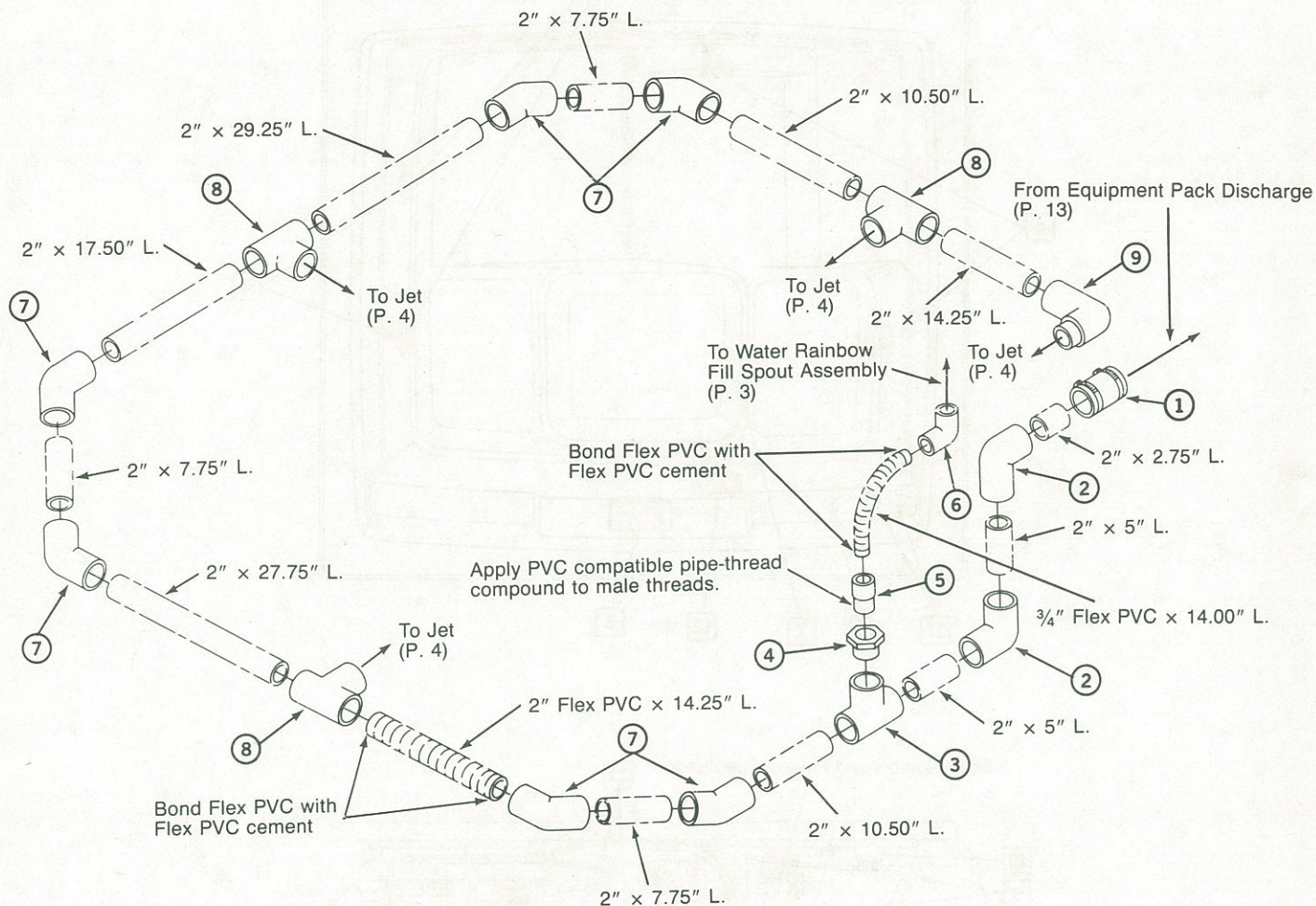

ITEM	P/N	DESCRIPTION	QTY
1	2634000	Repair Piping Connector, 2"	1
2	0426000	Elb, 90°, 2", S x S	2
3	0828000	Tee, 2", S x S x S	1
4	3789000	Bushing, Reducing, 3/4" NPT x 2" SPGT	1
5	6379000	Adaptor, Male 3/4" S x MPT	1
6	6380000	Elb, 90°, 3/4" S x FPT	1
7	0522000	Elb, 45°, 2", S x S	6
8	2488000	Tee, Reducing, 2" x 2" x 1 1/2", S x S x S	3
9	1100000	Elb, 90°, 2" x 1 1/2" Reducing	1

WATER RAINBOW FILL SPOUT ASSEMBLY

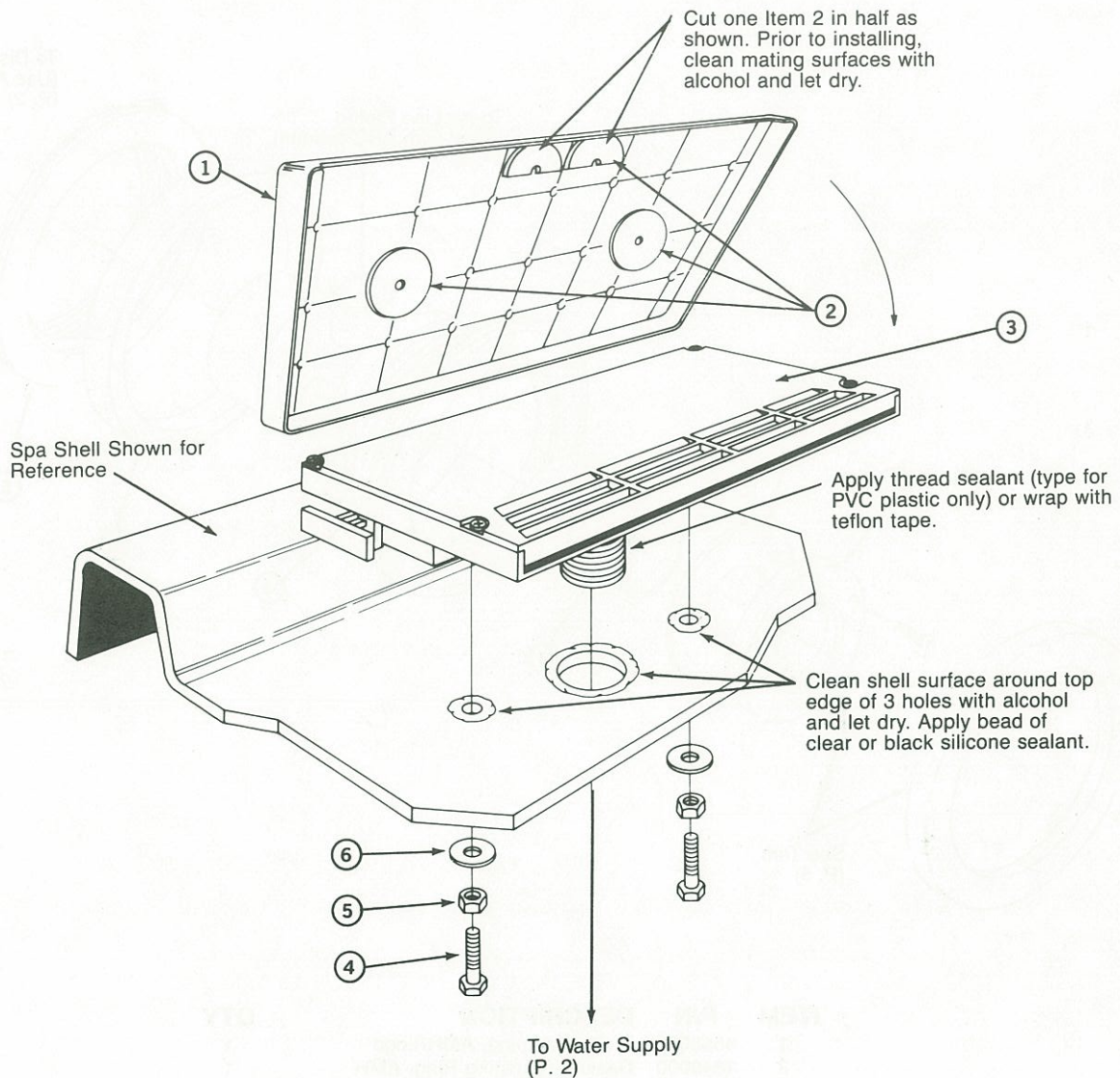

ITEM	P/N	DESCRIPTION	QTY
1	5996827	Cover, Fill Spout, Chrome	1
2	5409000	Adhesive, Switch Cap	3
3	5999000	Fill Spout Assembly	1
4	3945832	Bolt, Hex 1/4-20 x 1.00" L.	2
5	4034832	Nut, Locking Hd Kep Type 1/4-20	2
6	3982832	Washer, 1/4 Flt, Type A PinWdSer	2

AMH JET

(Trim shown for reference; see page 5 for Trim Assembly.)

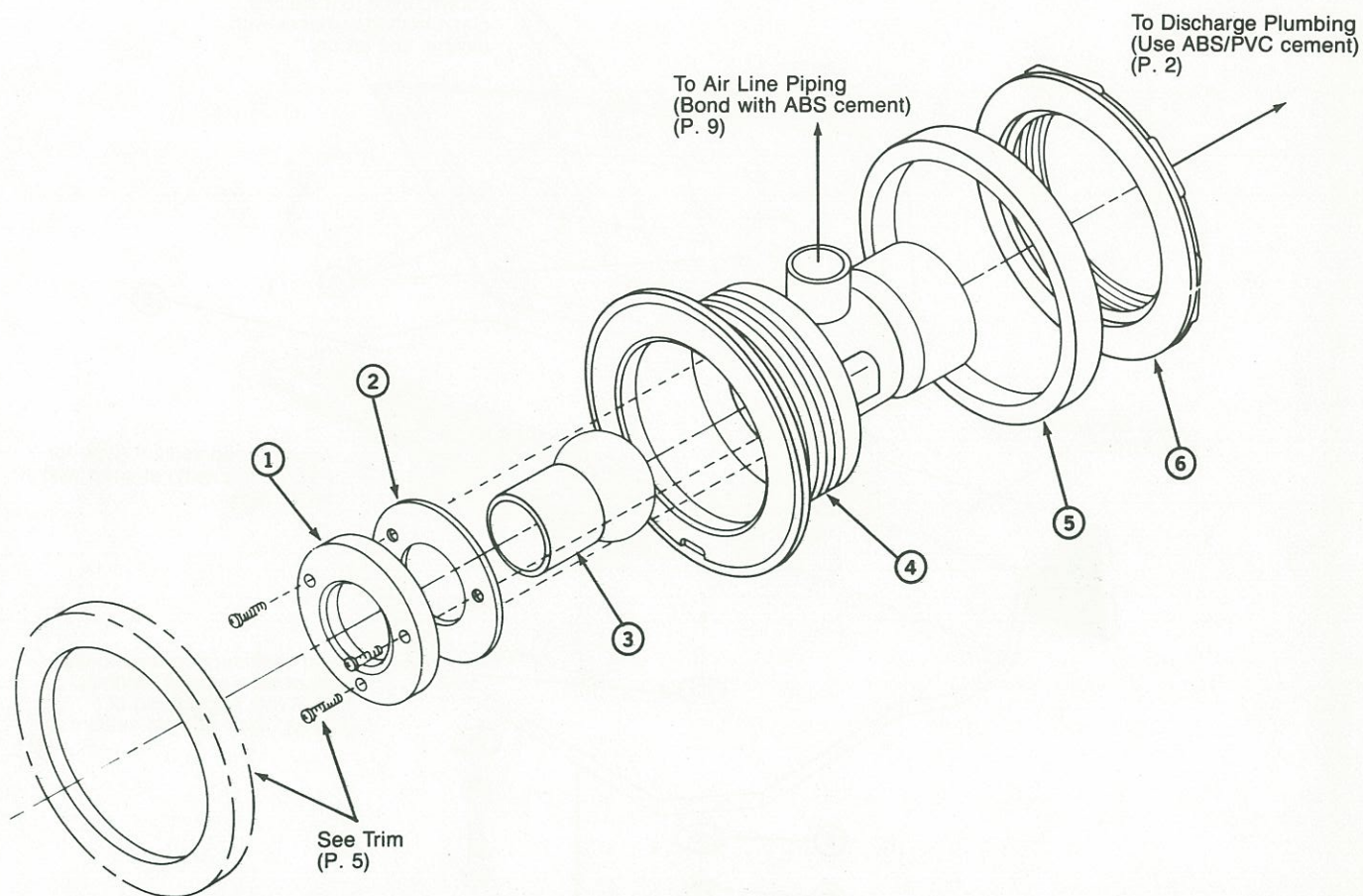

ITEM	P/N	DESCRIPTION	QTY
1	4558000	Ring, Clamping, AMH/Logo	1
2	1840000	Gasket, Clamping Ring, AMH	1
3	1834000	Nozzle, AMH	1
4	1833000	Body, AMH	1
5	1836000	Ring, Back-up	1
6	1835000	Nut, AMH	1

AMH JET TRIM

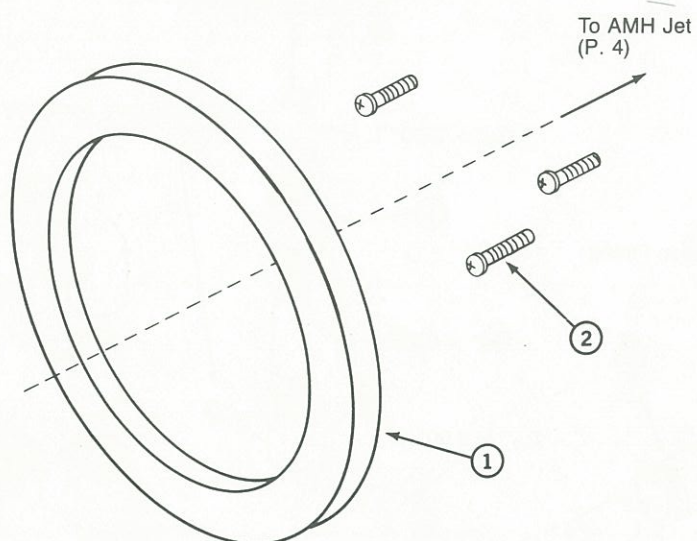

AMH Jet Trim

ITEM	P/N	DESCRIPTION	QTY
1	1838848	Face Ring, AMH, Polished	1
2	3967000	Screw, Mach., PHP 8-32 x .50" L.	3

SUCTION PLUMBING

(1½" and 2" Sch. 40 PVC Piping, shown for reference, are not available from Jacuzzi Whirlpool Bath.)

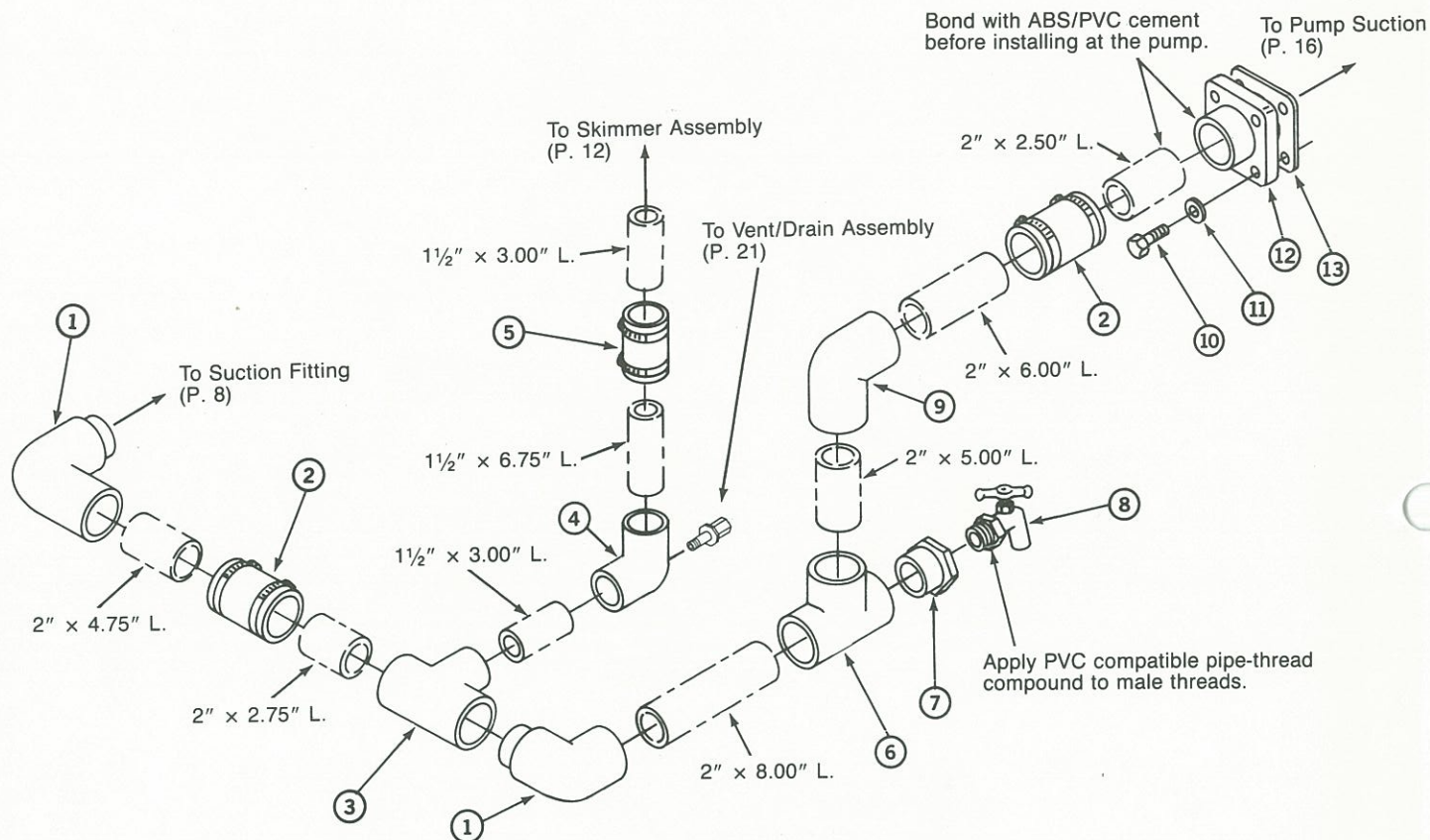

ITEM	P/N	DESCRIPTION	QTY
1	1592000	Ell, Street, 2", 90°	2
2	2634000	Repair Piping Connector, 2"	2
3	2488000	Tee, Reducing, 2" x 2" x 1½", S x S x S	1
4	5822000	Ell, 1½", 90°, Machined	1
5	2448000	Repair Piping Connector, 1.5"	1
6	0828000	Tee, 2" S x S x S	1
7	3789000	Bushing, Reducing, ¾" NPT x 2"SPGT	1
8	4657000	Hose Bib, Tee Handle	1
9	0426000	Ell, 90°, 2" S x S	1
10	3951832	Bolt, Hex ⅝-18 x 1.00" L.	4
11	3983832	Washer, ⅝ Flt., Type A PlnWdSer	4
12	4516000	Flange, Pump, 2"	1
13	0199000	Gasket, Pump Flange	1

SUCTION COVER/STRAINER

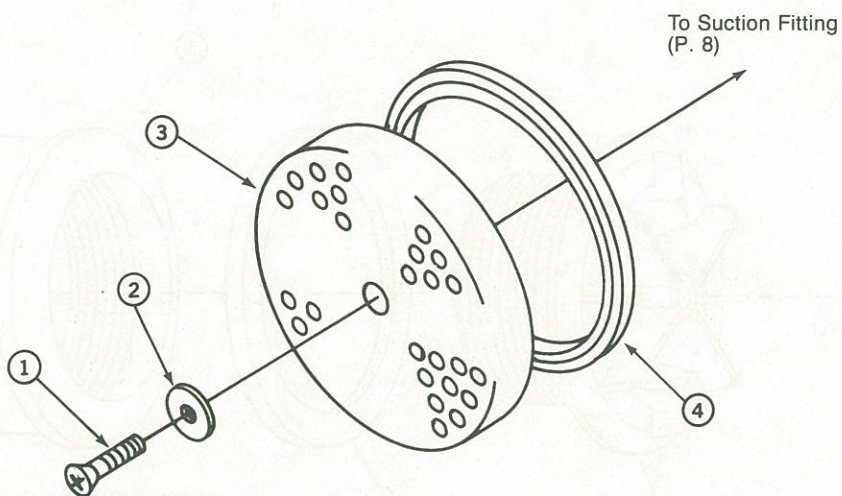

ITEM	P/N	DESCRIPTION	QTY
1	3958000	Screw, Mach., OHP #10-24 x 1.25" L.	1
2	4506000	Washer, #10 Finishing	1
3	1902000	Spa Suction Strainer	1
4	4507000	Ring, Suction Strainer	1

SUCTION FITTING

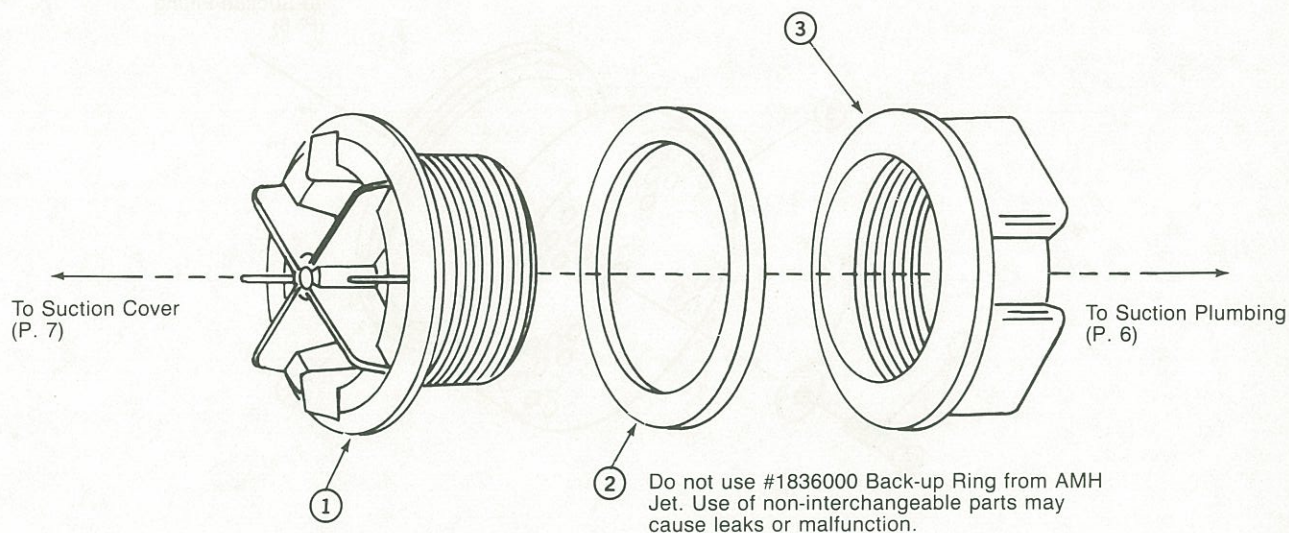

ITEM	P/N	DESCRIPTION	QTY
1	1958000	Suction Fitting Sub-Assembly	1
2	2136000	Ring, Back-up	1
3	1643000	Locknut, Suction Fitting	1

AIR LINE PIPING

($\frac{1}{2}$ " Sch. 40 PVC Piping and $\frac{5}{8}$ " Dishwasher Hose, shown for reference, are not available from Jacuzzi Whirlpool Bath.)

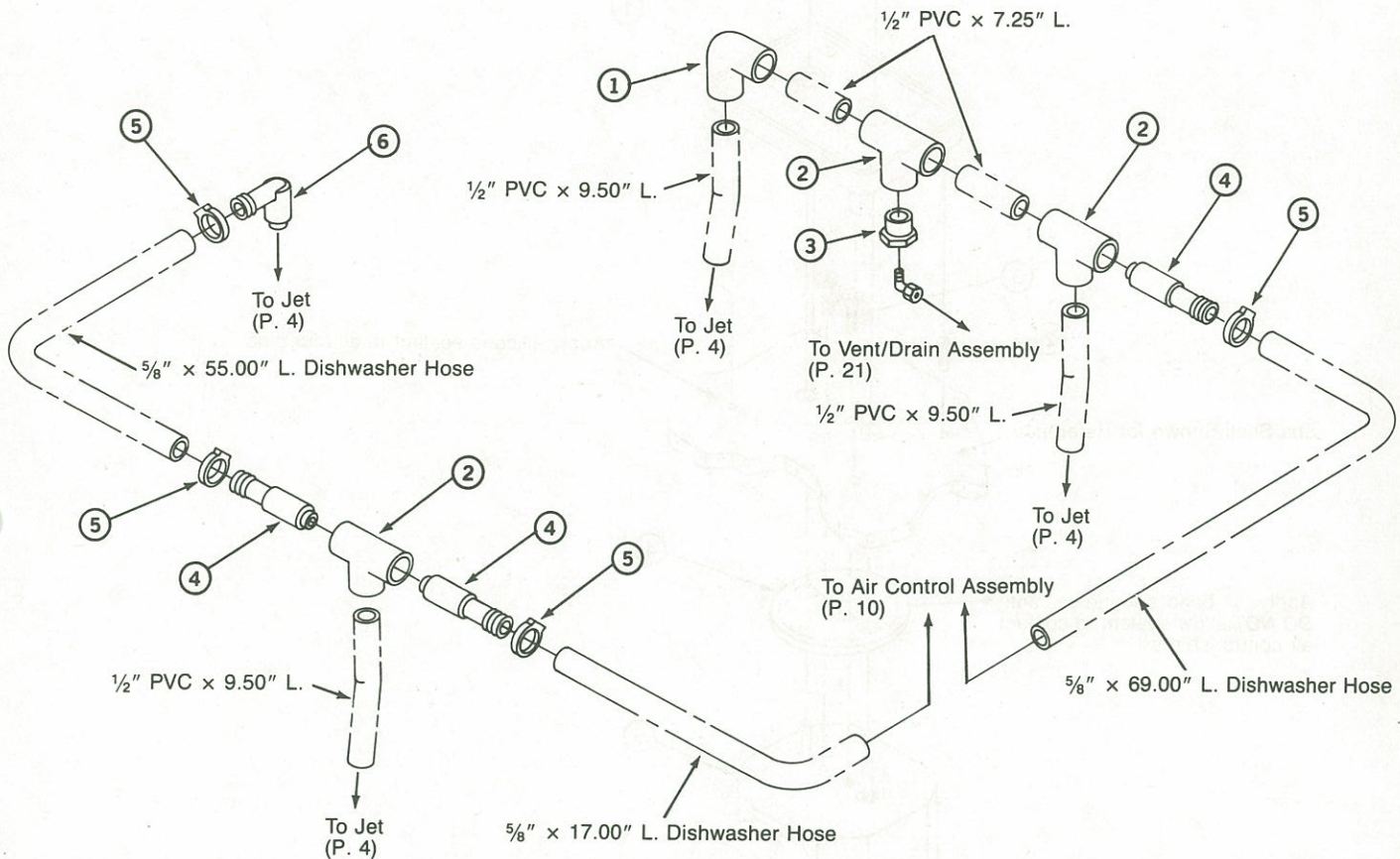

ITEM	P/N	DESCRIPTION	QTY
1	0436000	Elb, 90°, $\frac{1}{2}$ " S x S	1
2	0455000	Tee, $\frac{1}{2}$ " S x S x S	3
3	3064000	Bushing, Reducing, $\frac{1}{2}$ " x $\frac{1}{8}$ " SPIG x FIPT	1
4	1463000	Hose Adapter, Air Line, Straight	3
5	2181000	Clamp, Hose	4
6	1464000	90° Hose Adapter-Air Line	1

AIR CONTROL ASSEMBLY

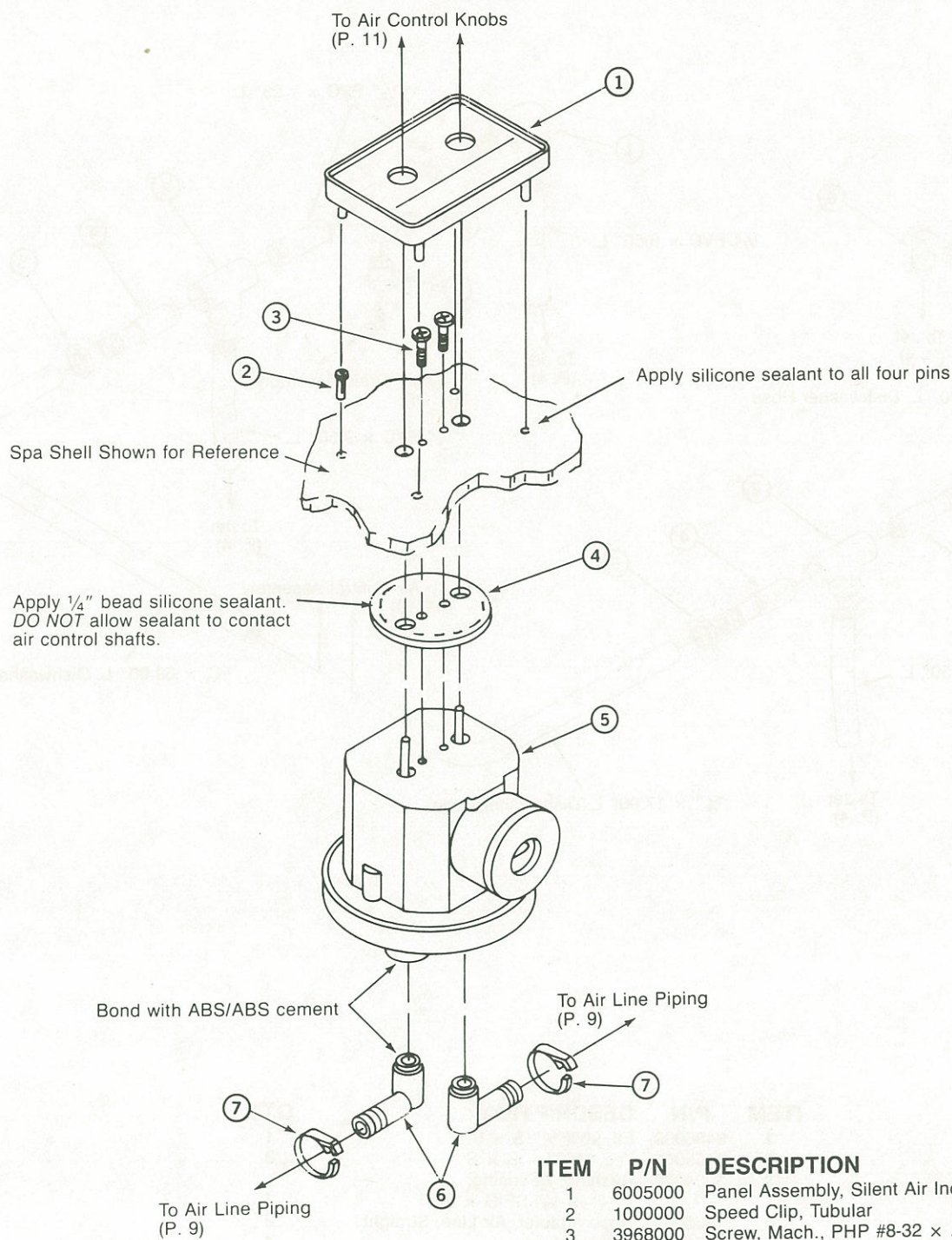

ITEM	P/N	DESCRIPTION	QTY
1	6005000	Panel Assembly, Silent Air Indc., Spa	1
2	1000000	Speed Clip, Tubular	4
3	3968000	Screw, Mach., PHP #8-32 x .75" L.	2
4	1120000	Gasket, Air Box Body	1
5	2124000	Air Control Unit Sub-Assembly	1
6	1464000	90° Hose Adapter-Air Line	2
7	2181000	Clamp, Hose	2

AIR CONTROL KNOB

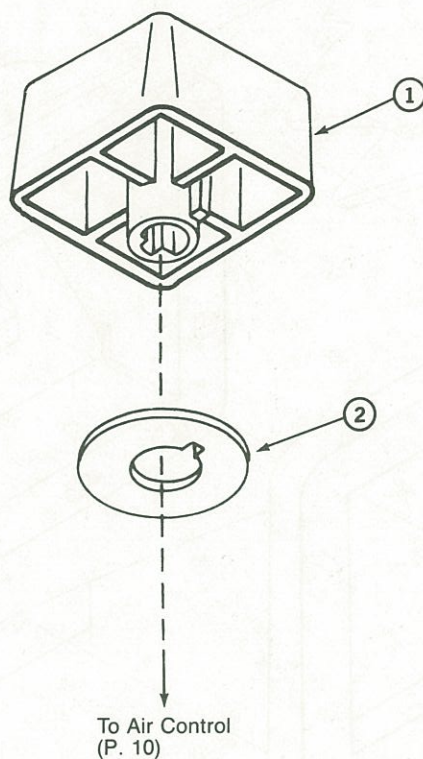

(Order two of each to replace the full set.)

Air Control Knob Assembly, Chrome

ITEM	P/N	DESCRIPTION	QTY
1	4139827	Air Control Knob Assembly, Chrome	1
2	3153000	Spacer, Air Control Knob	1

SKIMMER ASSEMBLY

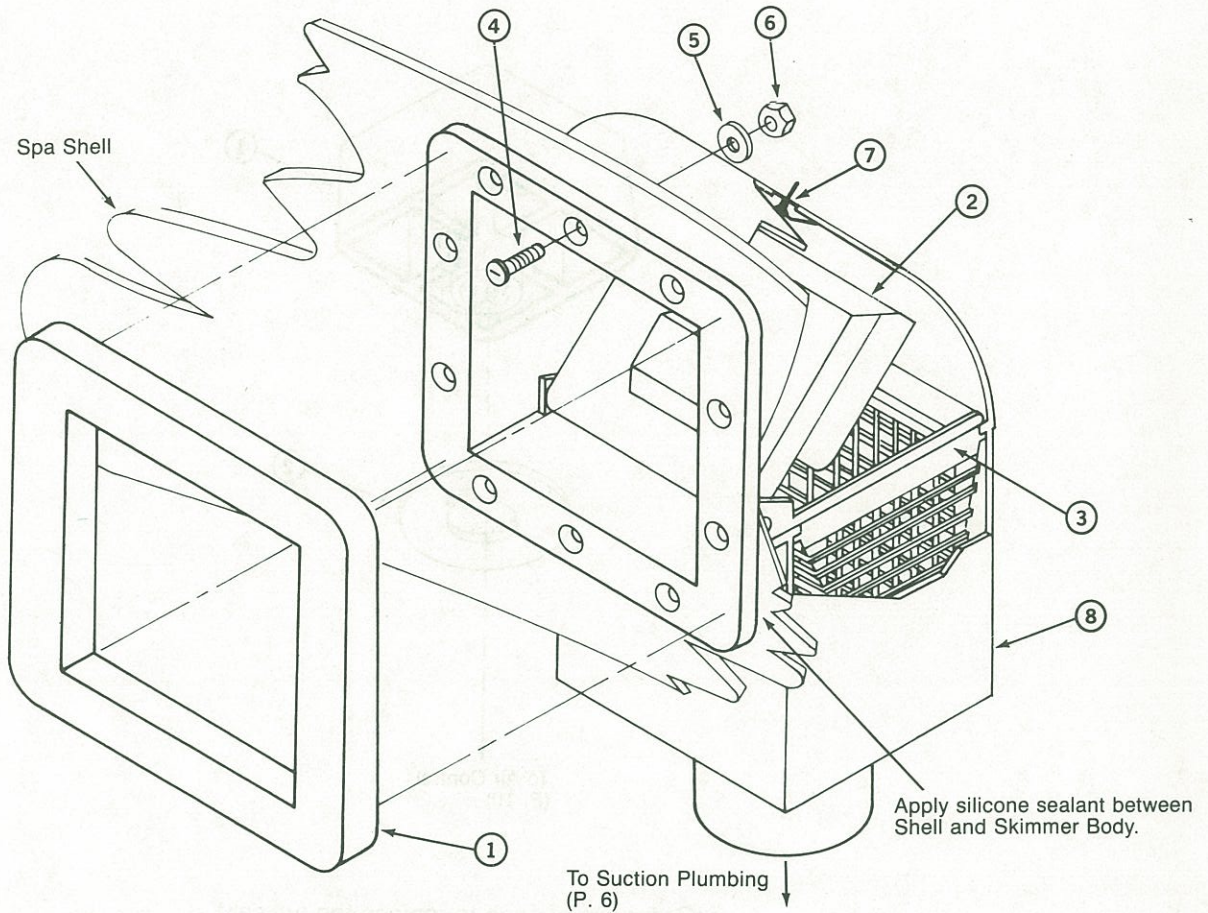

ITEM	P/N	DESCRIPTION	QTY
1	3669902	Face Plate, Skimmer, White	1
1	3669904	Face Plate, Skimmer, Beige	1
1	3669908	Face Plate, Skimmer, Brown	1
1	3669924	Face Plate, Skimmer, Blue	1
1	3669922	Face Plate, Skimmer, Cinnabar	1
2	3668000	Weir, Skimmer	1
3	3667000	Basket, Skimmer	1
4	3961000	Screw, Mach., OHP, 1/4-20 x 2" L.	10
5	4037000	Washer, 1/4 Flat Type A PlnWdSer	10
6	3474000	Nut, Hex, N.C. 1/4-20	10
7	6171000	Seal, Valve 1"	1
8	3666000	Skimmer Body Assembly	1

NOTE: When Item 8 is ordered, Item 7 is included.
Item 7 can also be ordered individually.

FILTER AND EQUIPMENT PACK DISCHARGE PLUMBING

(2" and 1½" Sch. 40 PVC Piping, shown for reference, are not available from Jacuzzi Whirlpool Bath.)

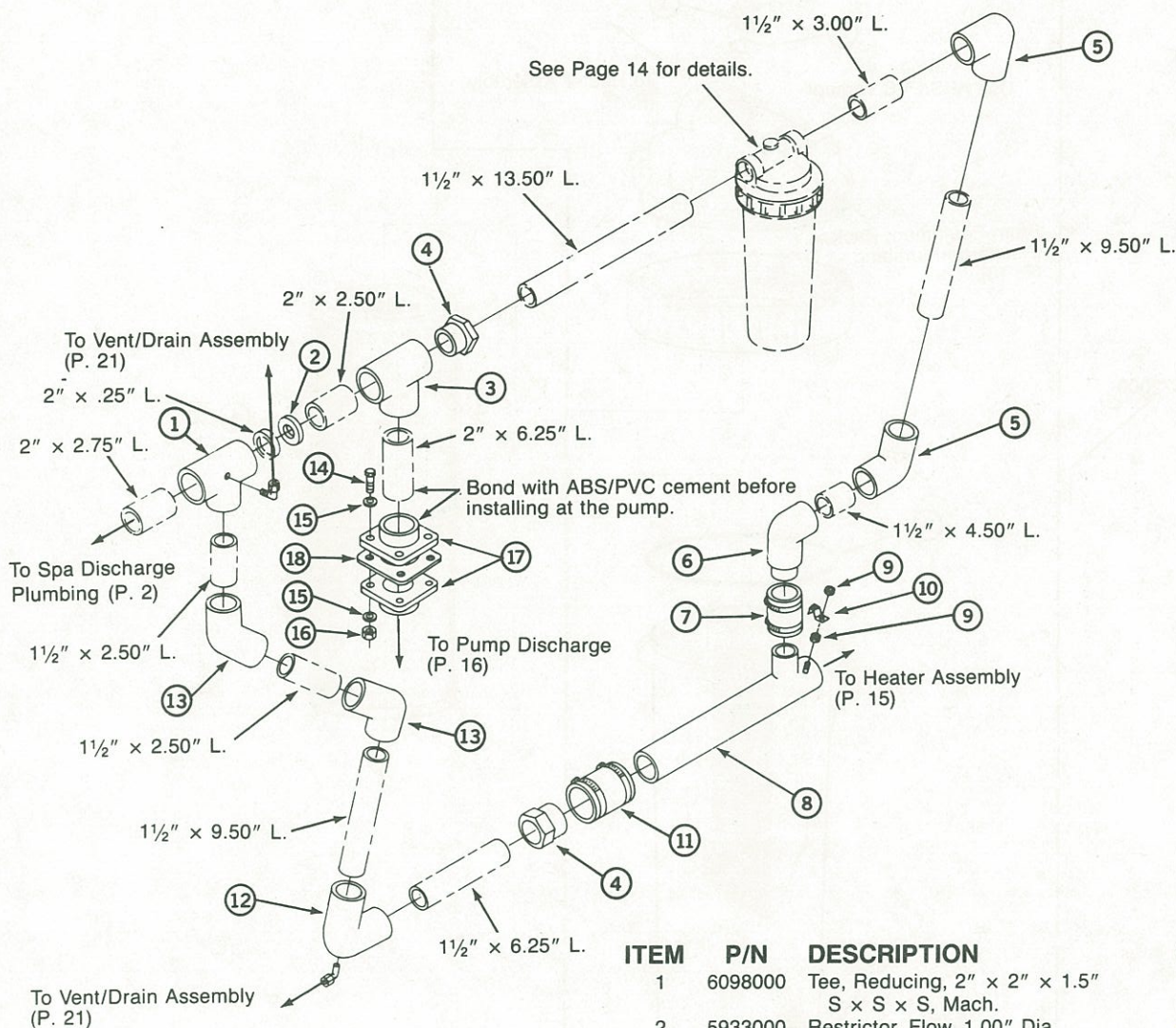

ITEM	P/N	DESCRIPTION	QTY
1	6098000	Tee, Reducing, 2" x 2" x 1.5" S x S x S, Mach.	1
2	5933000	Restrictor, Flow, 1.00" Dia.	1
3	0828000	Tee, 2" S x S	1
4	0473000	Bushing, Reducing, 2" x 1½", SPIG x S	2
5	0239000	Ell, 90°, 1½", S x S	2
6	0955000	Ell, 90°, 1½", Street x Male Slip	1
7	2448000	Repair Piping Connector, 1.5"	1
8	5619000	Housing, Heater, 1¼" NPT, SST	1
9	4033832	Nut, Locking, Hd Kep Type #10-24	2
10	2133000	Lug, Copper Cable Connector	1
11	2634000	Repair Piping Connector, 2"	1
12	5822000	Ell, 1½", 90°, Machined	1
13	0157000	Ell, 45°, 1½", S x S	2
14	3952832	Bolt, Hex 5/16-18 x 1.75" L.	4
15	3983832	Washer, 5/16 Flt, Type A PlnWdSer	8
16	3993832	Nut, Hex, Unc-2B 5/16-18	4
17	4516000	Flange, Pump 2"	2
18	0199000	Gasket, Pump Flange	1

FILTER ASSEMBLY, 25 SQ. FT.

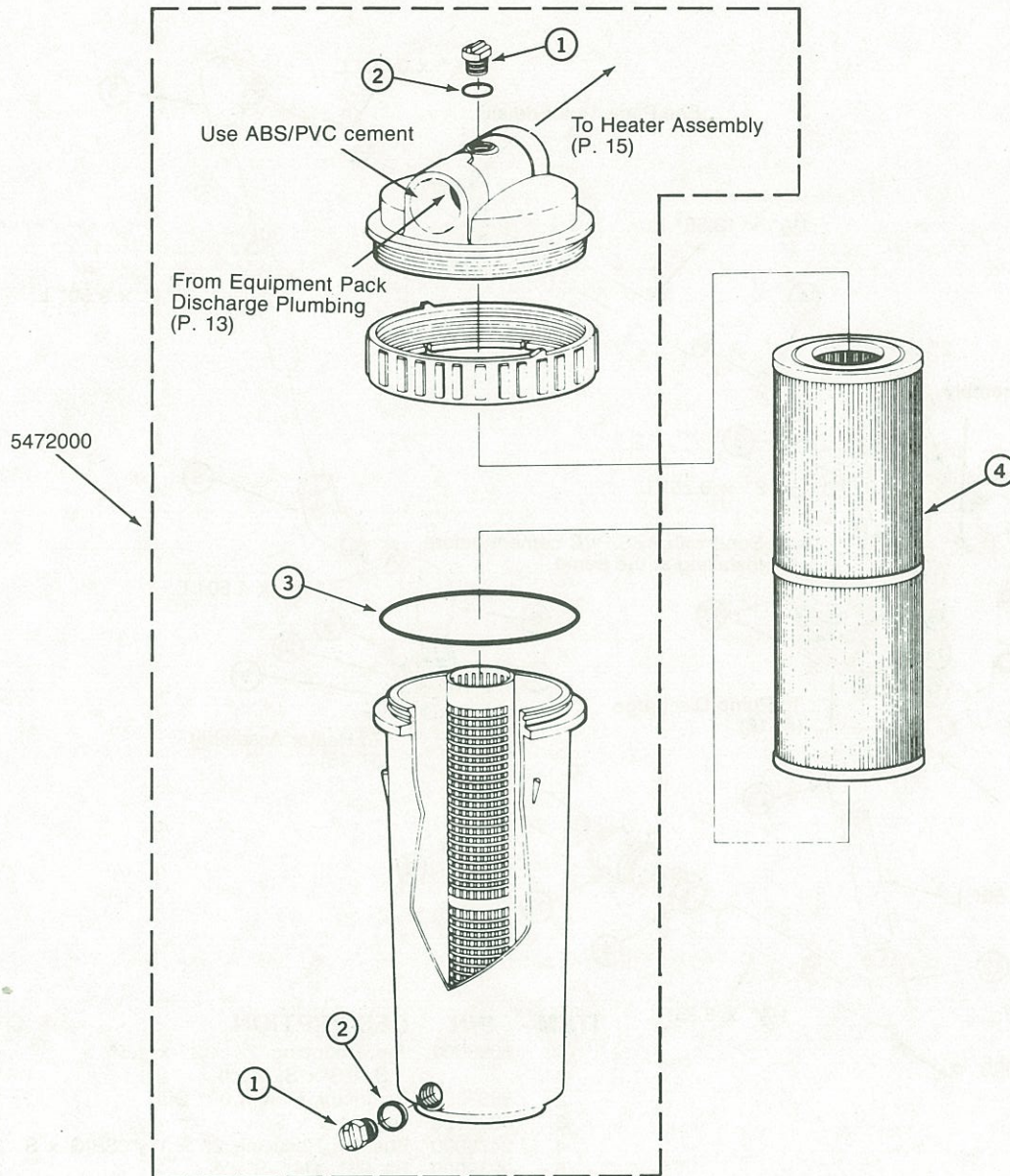

*5472000 Filter Assembly

ITEM	P/N	DESCRIPTION	QTY
1	6187000	Plug, Vent/Drain	2
2	6185000	O-ring, .487" I.D. x .693" O.D.	2
3	6186000	O-ring, 5.850" I.D. x 6.270" O.D.	1
4	**5475000	Filter Cartridge, 25 Sq. Ft.	1
N.S.	5184000	Lubricant, Silicone, 2cc Tube	1

*Available by assembly number or by individual parts as shown per callouts.

**Must be ordered separately.

HEATER ASSEMBLY

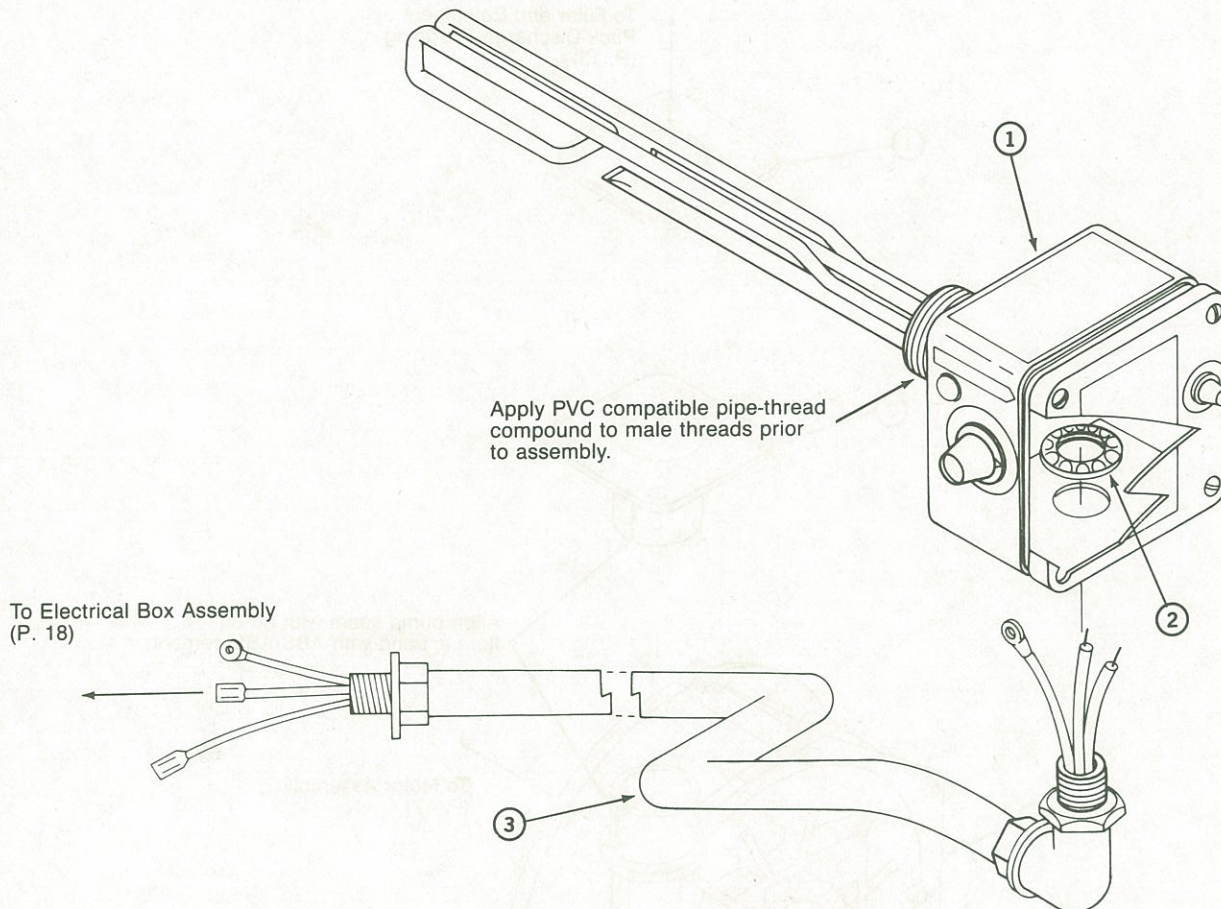

ITEM	P/N	DESCRIPTION	QTY
1	5251000	Heater, 1.5 KW, 120 VAC	1
2	4826832	Locknut, 1/2"-14 NPT	1
3	6376000	Cord Assembly, Heater 5 Wire	1

PUMP ASSEMBLY

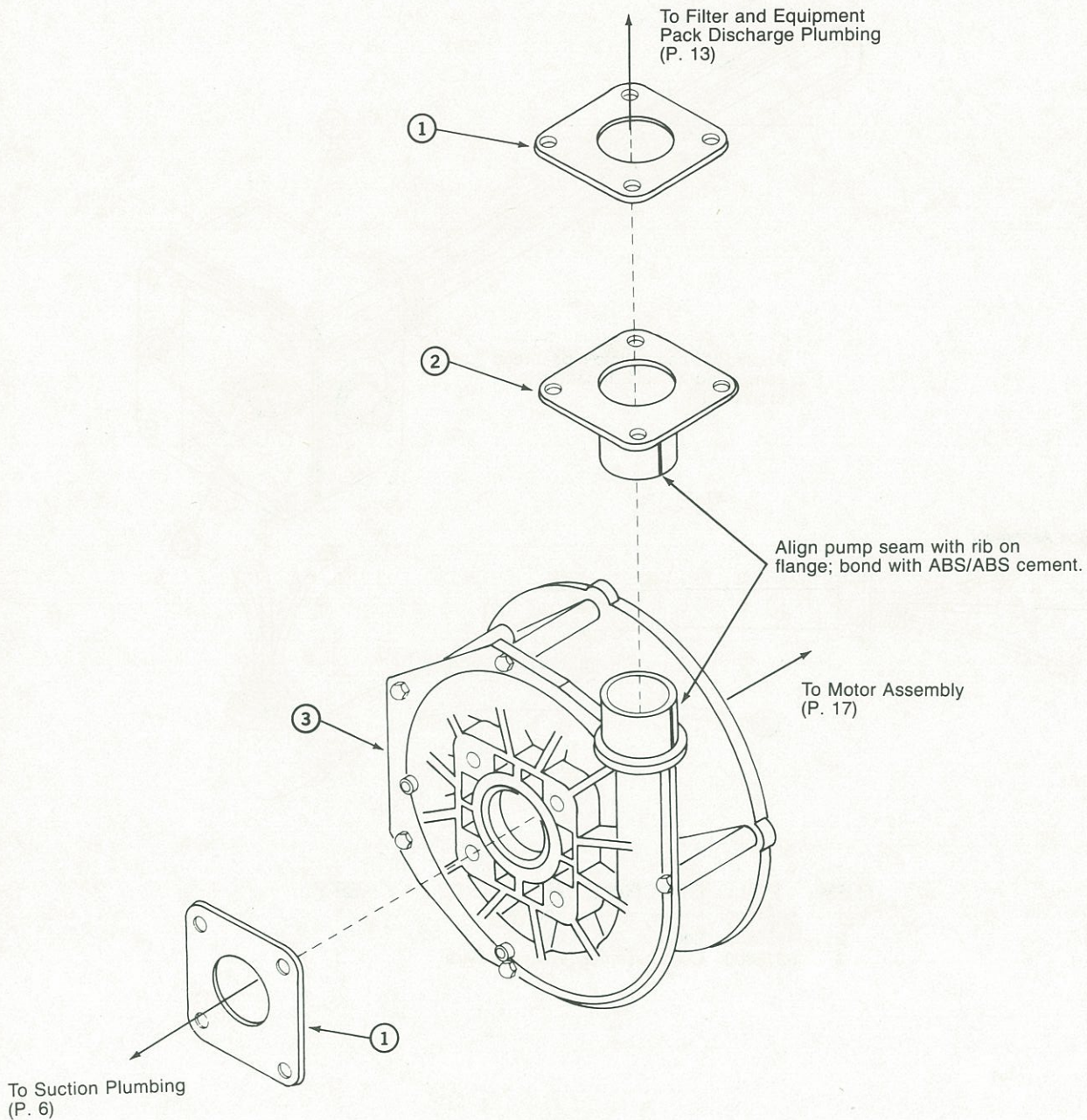

ITEM	P/N	DESCRIPTION	QTY
1	0199000	Gasket, Pump Flange	2
2	4516000	Flange, Pump 2"	1
3	4634000	Pump Assembly, .75 HP	1

MOTOR AND BRACKET ASSEMBLY

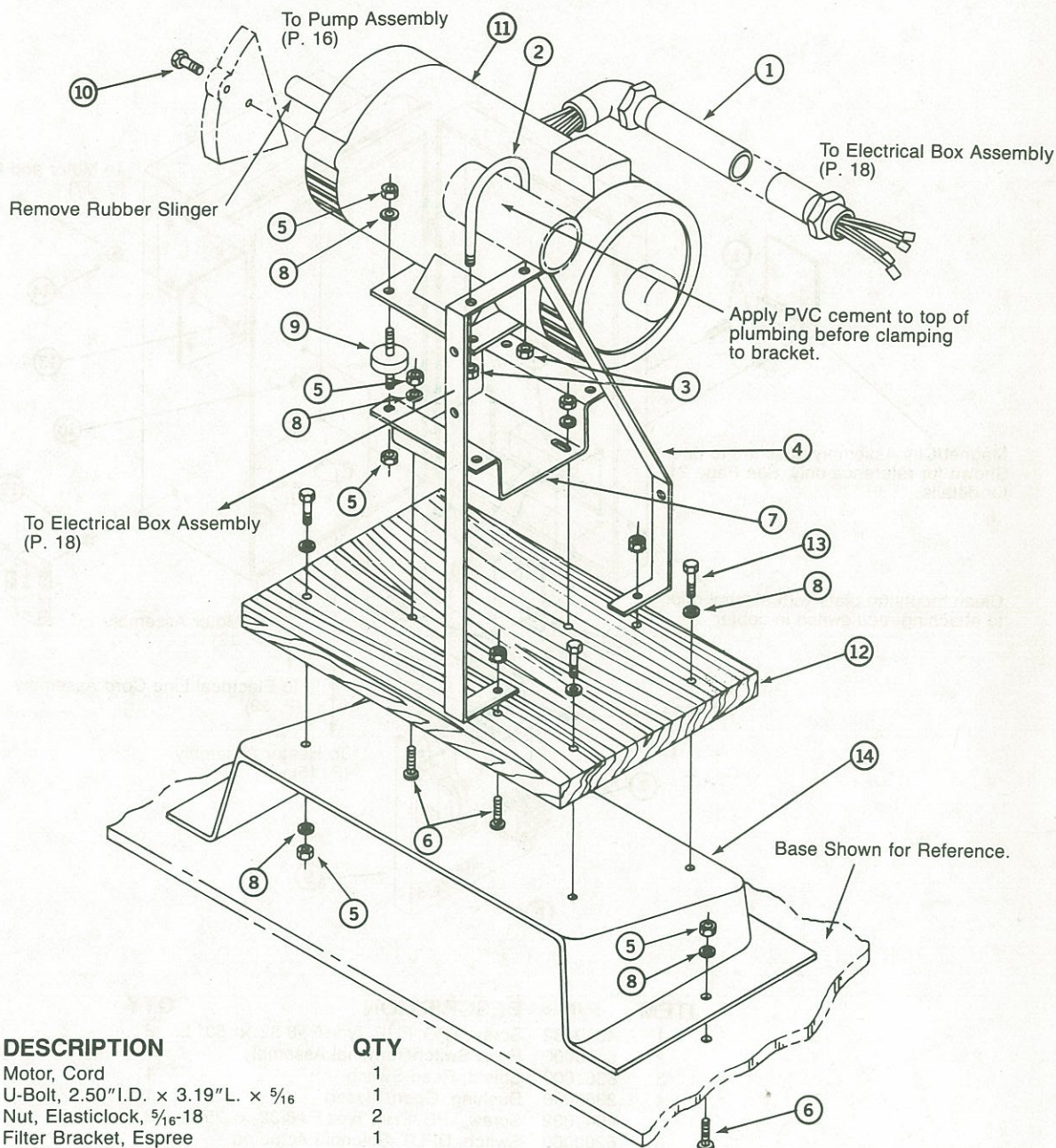

ITEM	P/N	DESCRIPTION	QTY
1	5478000	Motor, Cord	1
2	5277832	U-Bolt, 2.50" I.D. x 3.19" L. x 5/16	1
3	6371832	Nut, Elasticlock, 5/16-18	2
4	5271000	Filter Bracket, Espree	1
5	4034832	Nut, Locking Hd Kep Type 1/4-20	15
6	4022832	Bolt, Round Head, Square Neck, 1/4-20 x 2" L.	6
7	4477000	Bracket, Motor, 1" High	1
8	3982832	Washer, 1/4 Flt, Type A PlnWdSer	12
9	3689000	Vibration Damper	4
10	3953832	Bolt, Hex 3/8-16 x 1.00" L.	4
11	2812000	Motor, .75 HP, 115 V, 2-Speed Drp-Prf	1
12	5490000	Base, Equipment Pack, Espree	1
13	3945832	Bolt, Hex 1/4-20 x 1.00" L.	3
14	6382000	Pedestal, Equipment Pack	1

ELECTRICAL BOX ASSEMBLY

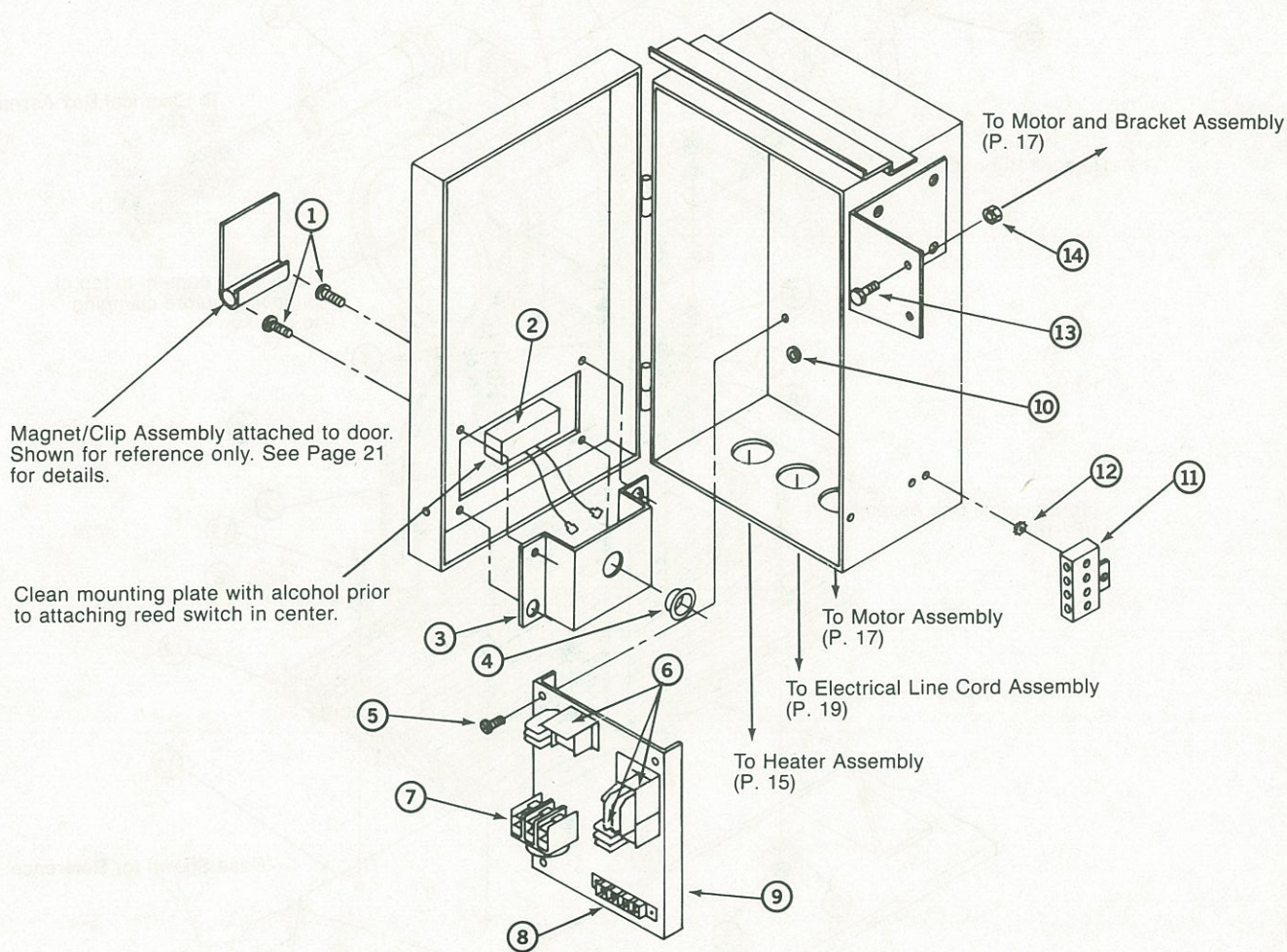

ITEM	P/N	DESCRIPTION	QTY
1	4040832	Screw, TPG, PHP, Type F #8-32 x .50" L.	2
2	6366000	Reed Switch/Terminal Assembly	1
3	6361000	Shield, Reed Switch	1
4	2369000	Bushing, Open/Closed	1
5	4041832	Screw, TPG, PHP, Type F #8-32 x .75" L.	3
6	5209000	Switch, DPDT, Solenoid Actuated	3
7	5260000	Switch, Sequence, 4-function, Air Actuated	1
8	5258000	Terminal Block, 4-circuit, .25" TB	1
9	5256000	Sub-Plate, Electrical Box	1
10	5279000	Grommet, .188" I.D.	1
11	1974000	Bar, Bonding	1
12	4012832	Washer, #9-16 Extnl. Tooth, Locking	1
13	3944832	Bolt, Hex 1/4-20 x .75" L.	2
14	4034832	Nut, Locking Hd Kep Type 1/4-20	2

ELECTRICAL LINE CORD ASSEMBLY

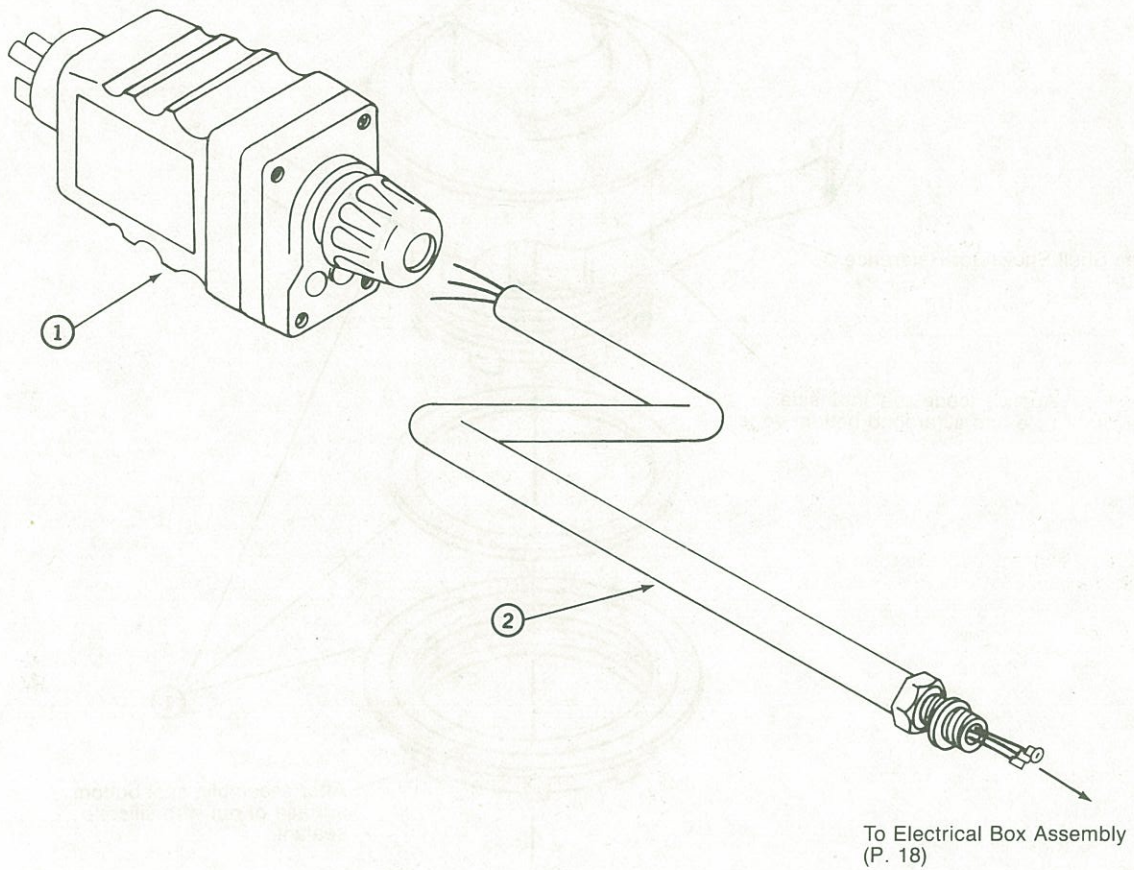

ITEM	P/N	DESCRIPTION	QTY
1	4653000	GFCI, Cord End Plug	1
2	6374000	Line Cord #14-3 Wire STRPD x 18 ft.	1

SEQUENCING SWITCH ACTUATOR

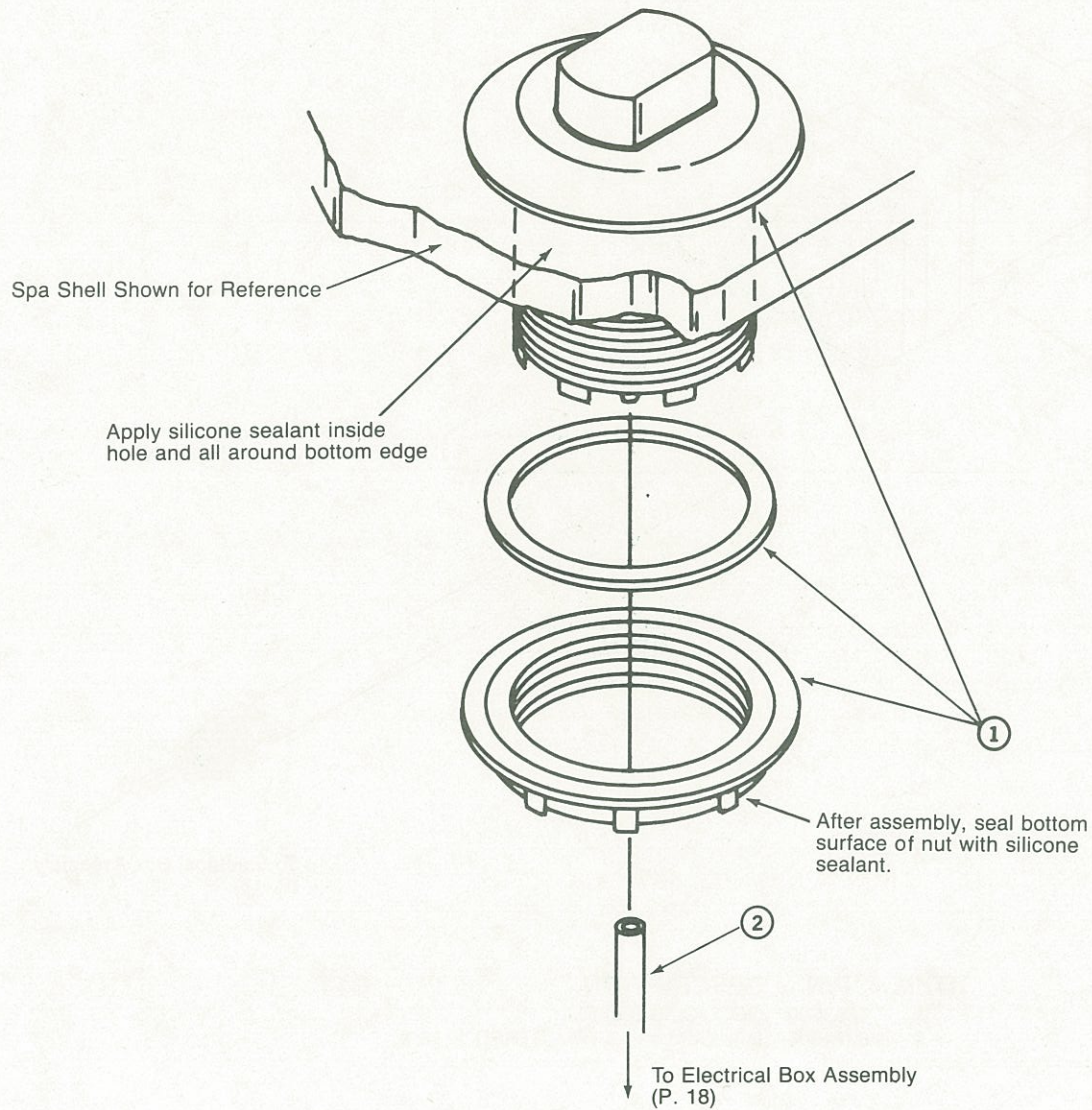

ITEM	P/N	DESCRIPTION	QTY
1	5259000	Actuator, Sequencing Switch	1
2	6627000	Tubing, .19" O.D. x .09" I.D., Flex x	1

VENT/DRAIN ASSEMBLIES

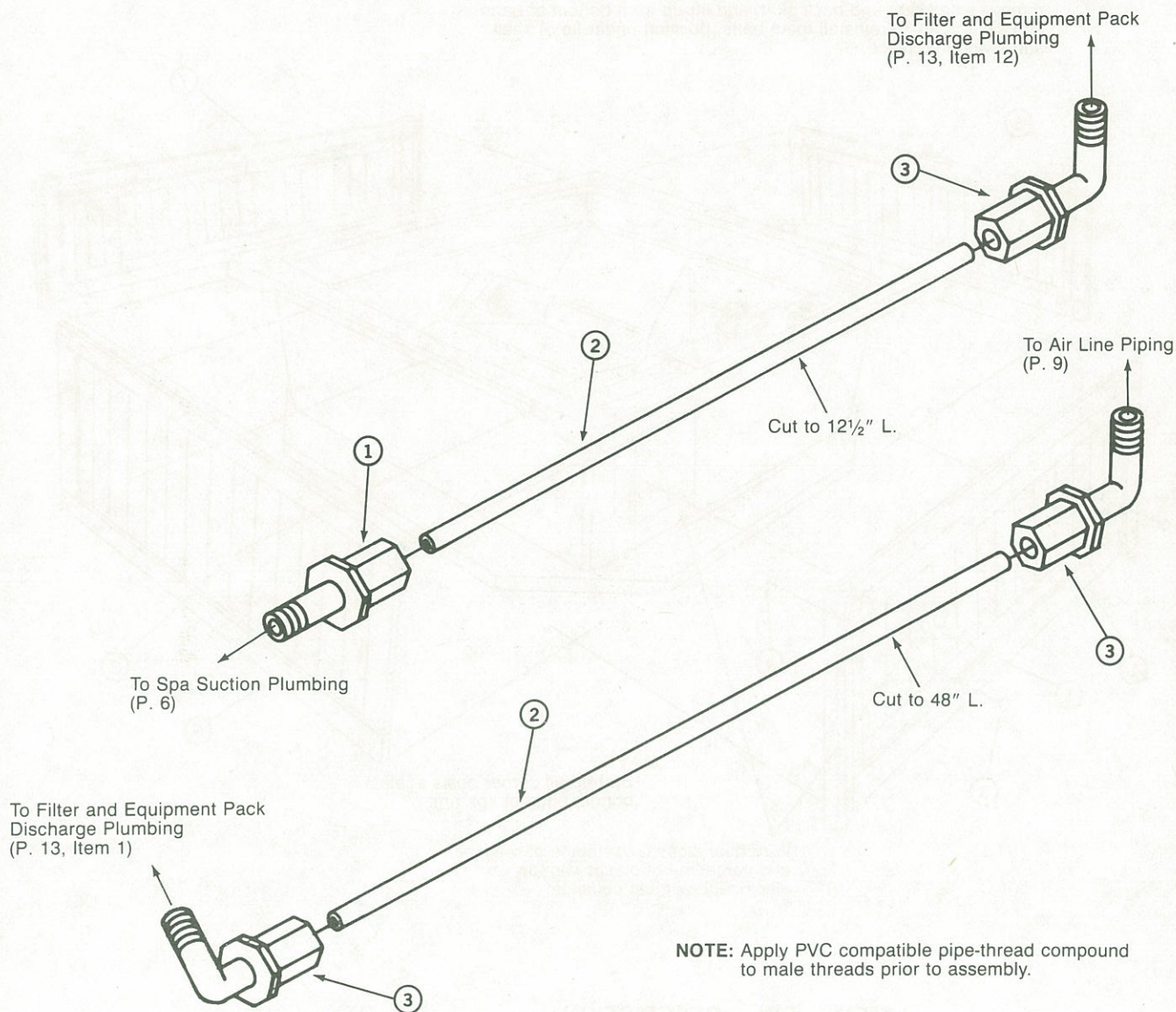

ITEM	P/N	DESCRIPTION	QTY
1	3054000	Compression Fitting, Straight, .25"	1
2	4649000	Tube, .25" O.D. Flex, Nylon x 55.00" L.	2
3	3044000	Compression Fitting, 90° Ell, .25"	3

SKIRT ASSEMBLY

NOTE: Removable insulating foam batts not shown. To remove foam batts, remove side skirts and back skirt, and lift up from bottom of batts and swing out. To reinstall foam batts, position under lip of shell and swing into place.

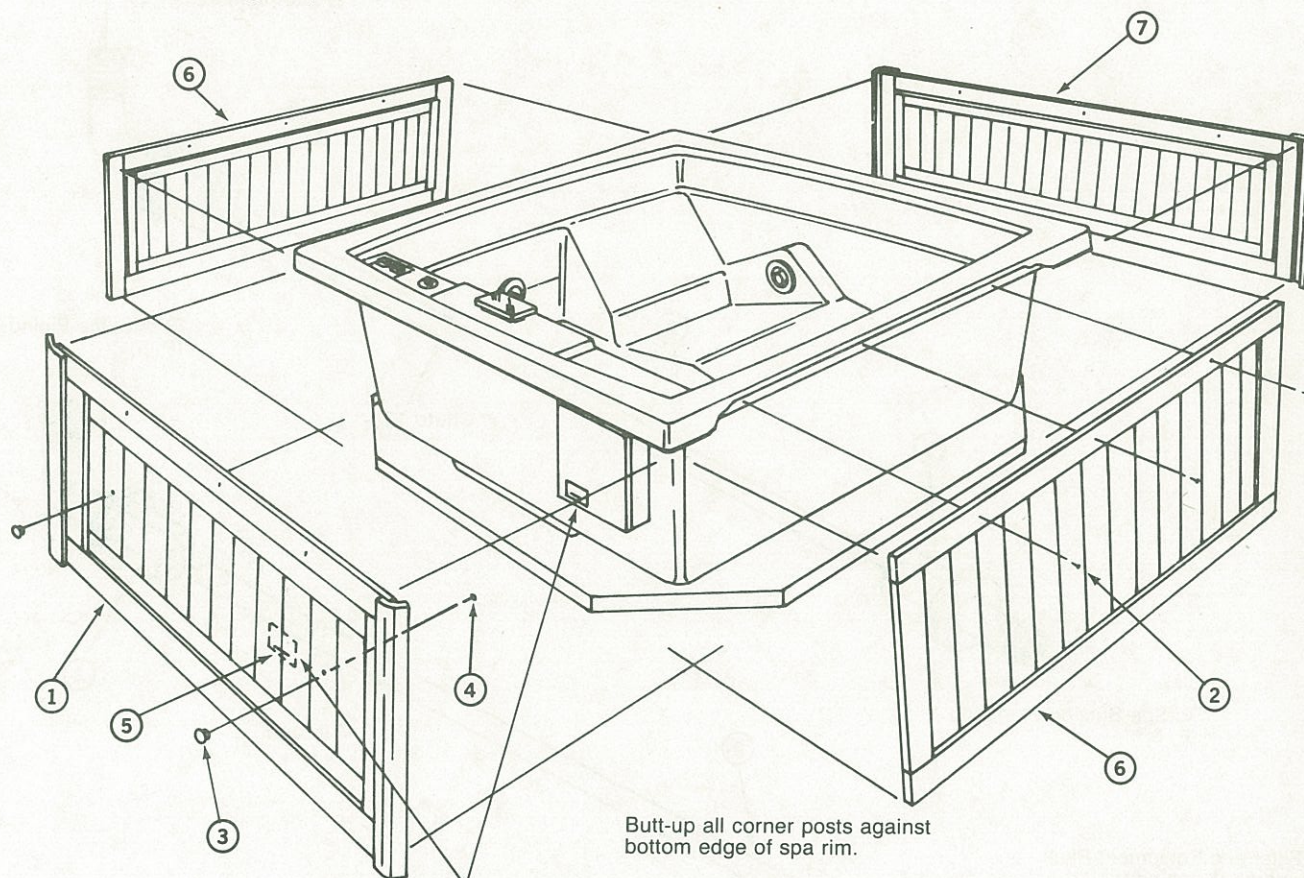

ITEM	P/N	DESCRIPTION	QTY
1	5305000	Skirt, Front, Redwood with Door	1
2	5303837	Screw, Drywall, #6 x 1.63" L.	24
3	5320000	Knob, Wood	2
4	5321832	Screw, Pan WHP, #12 x 1.0" L., Type B	2
5	6357000	Magnet/Clip Assembly	1
6	5307000	Skirt, Side, Redwood	2
7	5306000	Skirt, Back, Redwood	1



CARESSA

Model #5600000 Level 1
Issue Date: 6/85

SPA COVER

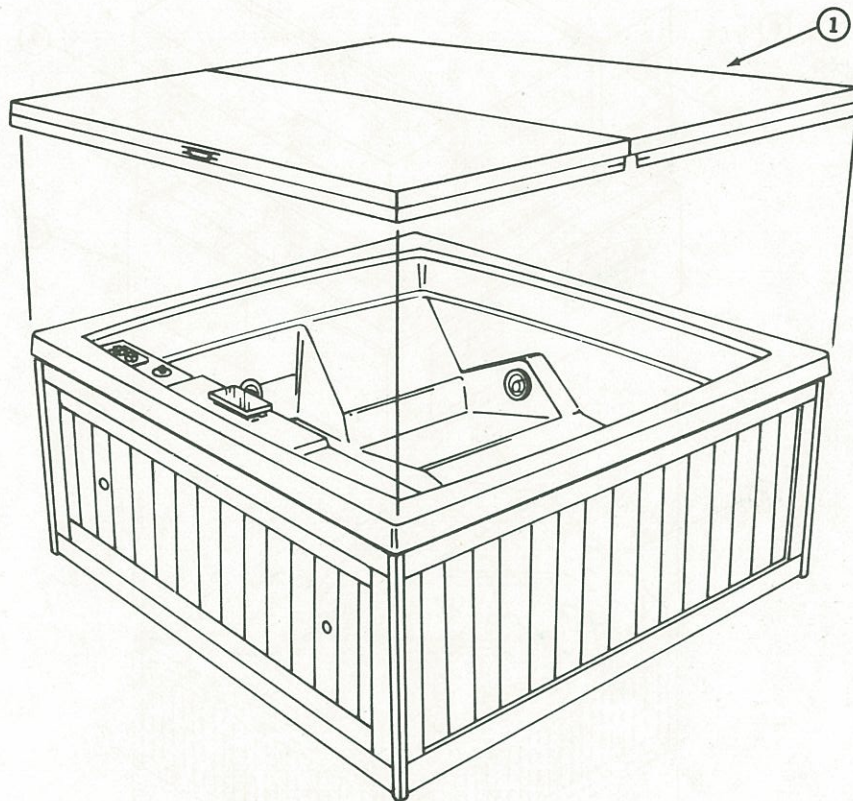

ITEM	P/N	DESCRIPTION	QTY
1	3260000	Cover, 66" x 72.25" x 1.5"	1

PACKAGING

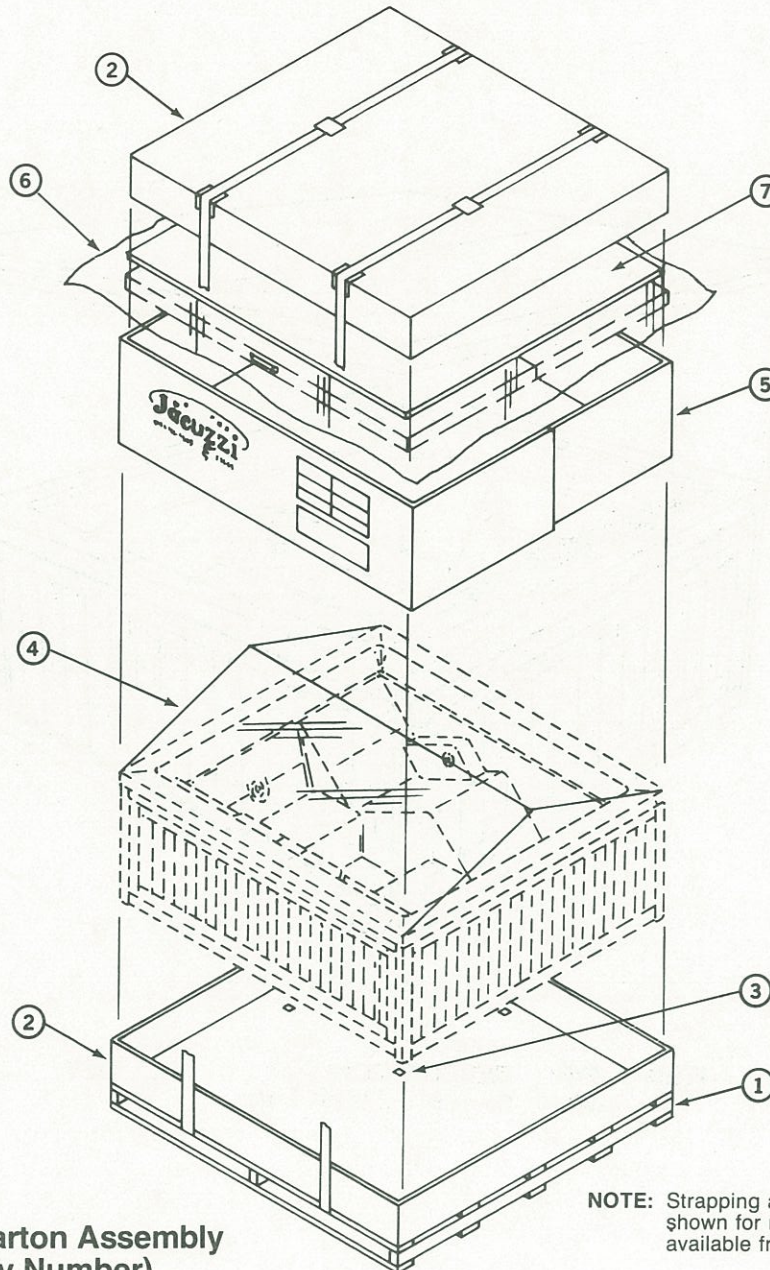

6498000 Repair Carton Assembly (Order by Assembly Number)

NOTE: Strapping and edge protectors, shown for reference, are not available from Jacuzzi Whirlpool Bath.

ITEM	P/N	DESCRIPTION	QTY
1	*2935000	Pallet Assembly	1
2	*2936000	Carton, Tray	2
3	*2086000	Nail, Square Headed, Roofing	9
4	*4900000	Bag, Gusseted, 68.0" x 74.0" x 30.0"	1
5	*2937000	U-Pad, Scored, Carton	4
6	*2080000	Sheet, 8' Roll x 4 Mil Poly, 100F	8 Ft.
7	*4411000	Pad, 66.5" x 72.5"	2

*Not available as single parts.



CARESSA

Model #5600000 Level 1
Issue Date: 6/85

OTHER ITEMS AVAILABLE

5010000	55,000 BTU Gas Heater
5400000	Timer, Portable
5050000	Repair Kit, Tan, Acrylic/Lacquer
5055000	Repair Kit, Sandstone Marble, Acrylic/Lacquer
5070000	Repair Kit, Brown, Acrylic/Lacquer
5020000	Repair Kit, Almond, Acrylic/Lacquer
5065000	Repair Kit, Cinnabar, Acrylic/Lacquer
6065000	Repair Kit, Cinnabar Marble, Acrylic/Lacquer
6072000	Repair Kit, Blue Marble, Acrylic/Lacquer

Limited 90-Day Warranty on Replacement Parts

Warranty Coverage

Jacuzzi Whirlpool Bath (the "Company") provides a limited material and labor warranty on its replacement parts.

Our warranty extends to the original purchaser of the replacement parts who buys it for installation in a Company product used for personal, family or household purposes ("user"). It does not extend to purchasers who intend to resell the product. Additional limitations apply to commercial users, and special rules apply to dealers and distributors.

Our warranty is ninety (90) days, beginning on the date the replacement part was installed or purchased by the user, whichever is later.

Our warranty covers: All replacement parts against defects in material or workmanship, or failure to operate in accordance with the performance ratings for the part.

Without charge to the user, the Company will, at its option, either repair the defective part or replace the defective part.

Warranty Service

In order to obtain service provided under this warranty, during regular business hours contact a Jacuzzi Whirlpool Bath Authorized Service Agent or the Dealer/Distributor who sold the part and describe the problem. (See the white pages of your local telephone book for the location of the nearest Authorized Service Agent.) An Authorized Service Agent will contact the user, inspect the system, and provide the service described herein.

Warranty Limitations

Our warranty is limited and does not cover defects, damage, or failure caused by the installer, user or other person, including but not limited to the following: improper installation or installation not in accordance with the instructions and specifications provided with the part or system; any type of modification of any part or component, including modification to meet local codes; misuse; lack of maintenance or improper maintenance or operation; use of chemicals in units with gold-plated fixtures; improper connections by the installer; improper voltage supply; careless handling; operation of the system without minimum amount of water in the vessel as specified in the Operating Instructions; acts of God.

In addition, the Company will not be responsible for any incidental or consequential damages or losses, direct or indirect, arising from any cause whatsoever; shipping damage; alleged factory damage or defect which was not reported to the Company prior to installation, compliance with local building codes.

Commercial Limitations

In addition to the user Warranty Limitations, our warranty does not cover commercial installations when the part or system has been altered or modified in any way. The part or system is sold on an "as is" basis, and the Company is not responsible for loss of use or profit under any circumstances.

Implied Warranties

Implied warranties of merchantability and fitness for a particular purpose, to the extent that they are applicable, are limited to ninety (90) days from the date of purchase or installation, whichever is later.

Notice: This warranty gives you specific legal rights, and you may also have other rights which vary from state to state. There are no warranties applicable to Jacuzzi Whirlpool Bath producers except as expressly stated herein or as implied in applicable state and Federal laws. The Company will not be responsible for any statements or representations made in any form that go beyond, are broader than, or are inconsistent with authorized literature or specifications furnished by the Company. Some states do not allow limitations on how long an implied warranty lasts, so the above limitation may not apply to you. Also, some states do not allow the exclusion of incidental or consequential damages, so the above limitation or exclusion may not apply to you.

Responsibility to Others

Inspecting the replacement part prior to installation is the responsibility of the user or installer or building contractor who acts on behalf of the user. He is responsible for ensuring the replacement part is free of defects or damage. In the event of a problem, the replacement part must not be installed. The Company is not responsible for defects or damage that could have been discovered, repaired, or avoided by inspection and testing the replacement part prior to installation.

Damage occurring to the replacement part during or after installation is the responsibility of the installer and/or building contractor.

PRODUCT SPECIFICATIONS ARE SUBJECT TO CHANGE WITHOUT NOTICE

Jacuzzi Whirlpool Bath has obtained applicable code (standards) listings generally available on a national basis for products of this type. It is the responsibility of the installer/owner to determine specific local code compliances prior to installation of the product. Jacuzzi Whirlpool Bath makes no representation or warranty regarding, and will not be responsible for any code compliance.

JACUZZI WHIRLPOOL BATH

Subsidiary of Kidde, Inc.

KIDDE

298 North Wiget Lane, P.O. Drawer J, Walnut Creek, CA 94596 (415) 938-7070

Jacuzzi Whirlpool Bath Regional Offices

Western Region: 335 Fischer Ave., Costa Mesa, CA 92626 (714) 751-1244

Great Lakes Region: 415 W. Golf Rd., Suite 49, Arlington Heights, IL 60005 (312) 640-1300

Central Region: 13720 Midway Rd., Suite 110, Dallas, TX 75234 (214) 233-5572

Southeast Region: 2500 Park Central Blvd., Decatur, GA 30035 (404) 981-8222

Northeast Region: West Essex Plaza II, 1129 Bloomfield Ave., West Caldwell, NJ 07006 (201) 575-7710