

REPAIRS
DRAIN CLEANING
ALTERATIONS
NEW INSTALLATION
RESIDENTIAL • COMMERCIAL

STATE CERTIFIED — LICENSED & INSURED
COMPLETE SELECTION OF PLUMBING FIXTURES
& REPLACEMENT PARTS...

KOHLER

Guillen's **PLUMBING**

"ONE STOP PLUMBING SHOP"

Jacuzzi
WHIRLPOOL BATH

226-7855

"SHOWROOM AT"
11040 W. FLAGLER ST.
MIAMI, FLORIDA

AMERICAN STANDARD

CC: 9418

Guillen's PLUMBING
We take all your plumbing needs
seriously.



LUSSO™

WHIRLPOOL BATH

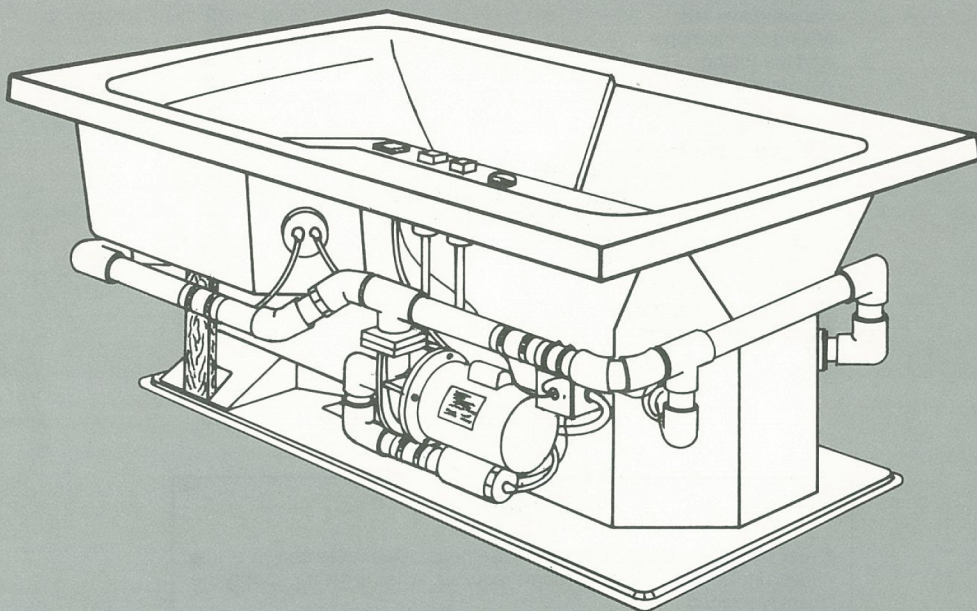

PARTS CATALOG

Model #4970000 Level 1
Model #4970000 Level 2
Model #4970000 Level 3
Issue Date: 2/85
Catalog #6462000

CONTENTS

	Page
Lusso Reference Illustrations	1
Discharge Plumbing	2
HTA Jet Trim	3
HTA Jet	4
HTA Jet (With Sensor)	5
Suction Plumbing	6
Suction Cover/Strainer	7
Suction Fitting	8
Fill Spout/Diverter Assembly	9
Diverter Assembly Trim	10
Faucet Assembly (Less Trim)	11
Faucet Valve Trim	12
Mixing Connections	13
Air Line Piping	14
Air Control Knob	15
Air Control Assembly	16
Pump Assembly	17
Motor/Bracket Assembly	18
J-Box and Bath Switch Assembly	19
Magic Touch ON-OFF/Water Level Switch (Levels 2 and 3 Only)	20
Dial Thermometer Assembly (Levels 1 and 2 Only)	21
Drain/Overflow (Less Trim)	22
Drain/Overflow Trim	23
Vent/Drain Assembly	24
Repair Carton Assembly	25
Other Items Available	26

TO ORDER

Order by part number unless otherwise noted. Quantities shown in this catalog indicate the number of items required. When ordering, specify the quantity needed.

PART NO.	MODEL	LEVEL	DESCRIPTION
4970000	Lusso	1	Acrylic Shell, HTA Jets, Factory Installed Trim
4970000	Lusso	2	Safety Suction, Magic Touch, Trim not Included.
4970000	Lusso	3	Dial Thermometer Assembly Removed, Shell not Drilled for Fill Spout.

Repair Assemblies are Referenced to Page Numbers Shown Below.

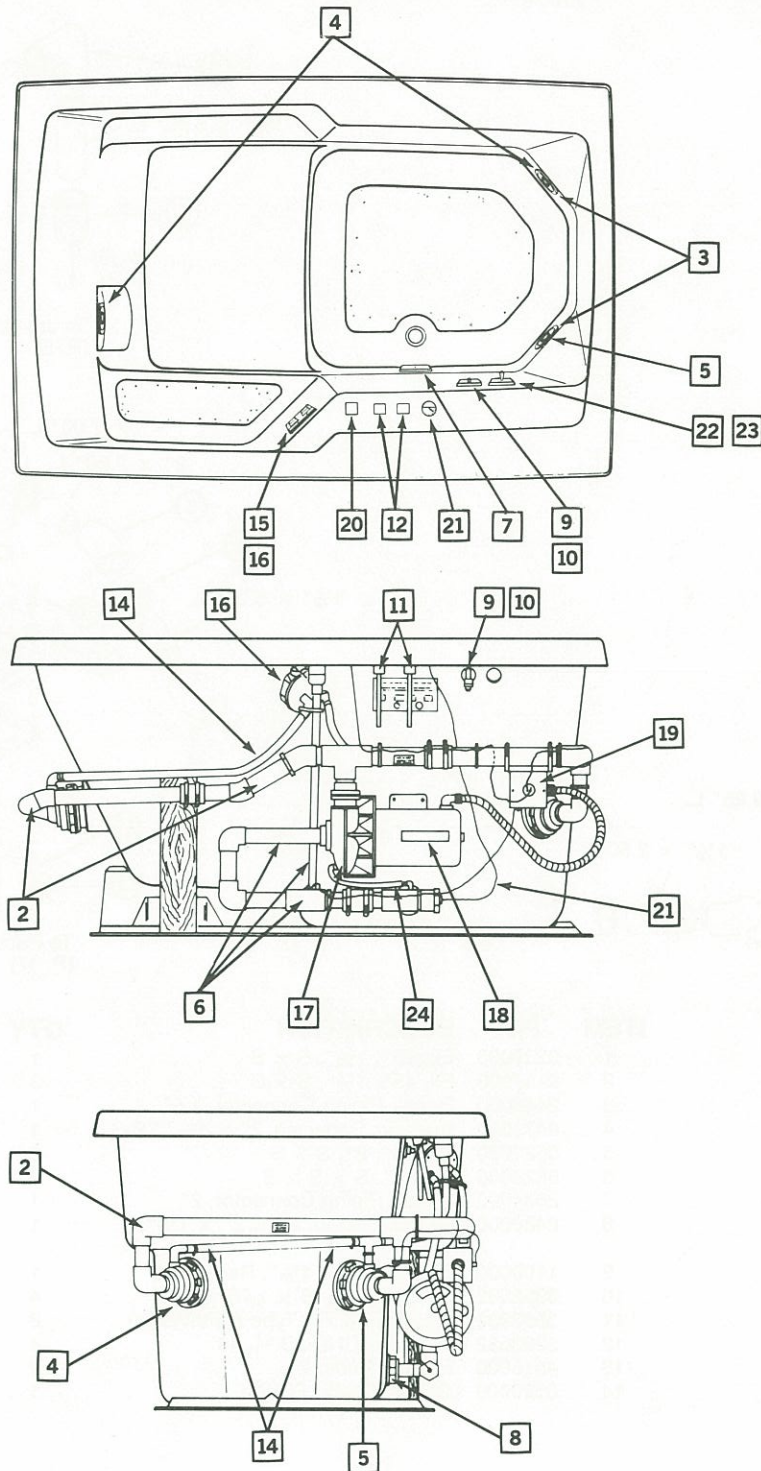

DISCHARGE PLUMBING

(1½" and 2" Sch. 40 PVC Piping, shown for reference, are not available from Jacuzzi Whirlpool Bath.)

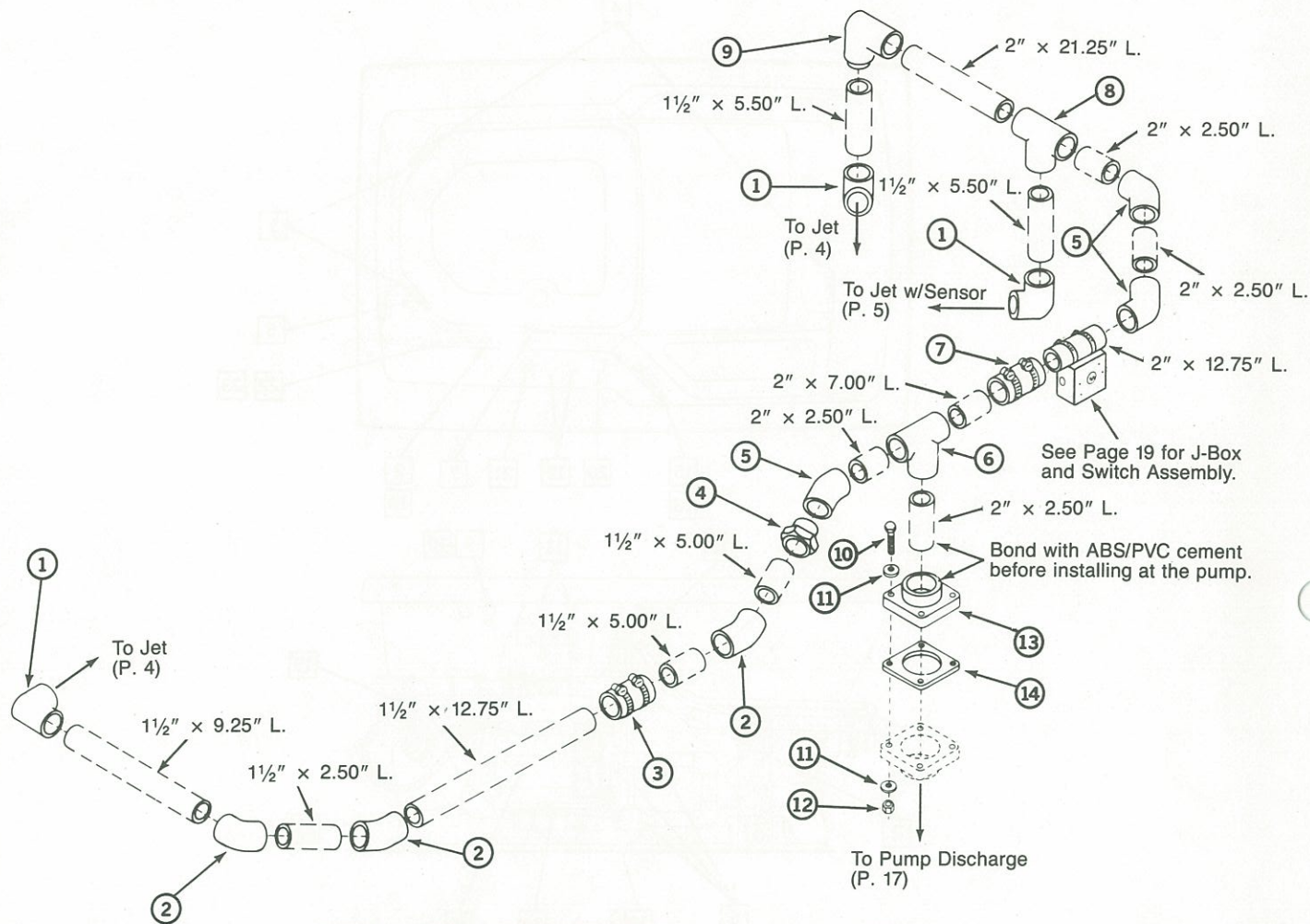

ITEM	P/N	DESCRIPTION	QTY
1	0239000	Elb, 90°, 1½", S x S	1
2	0157000	Elb, 45°, 1½", S x S	3
3	2448000	Repair Piping Connector, 1.5"	1
4	0473000	Bushing, Reducing, 2" x 1½" SPIG x S	1
5	0522000	Elb, 45°, 2", S x S	3
6	0828000	Tee, 2", S x S x S	1
7	2634000	Repair Piping Connector, 2"	1
8	2488000	Tee, Reducing, 2" x 2" x 1½", S x S x S	1
9	1100000	Elb, 90°, 2" x 1½", Reducing	1
10	3952832	Bolt, Hex 5/16-18 x 1.75" L.	4
11	3983832	Washer, 5/16 Flt, Type A PlnWdSer	8
12	3993832	Nut, Hex UNC-2B 5/16-18	4
13	4516000	Flange, Pump 2"	2
14	0199000	Gasket, Pump Flange	1

HTA JET TRIM

Quantity shown is the quantity needed per jet.

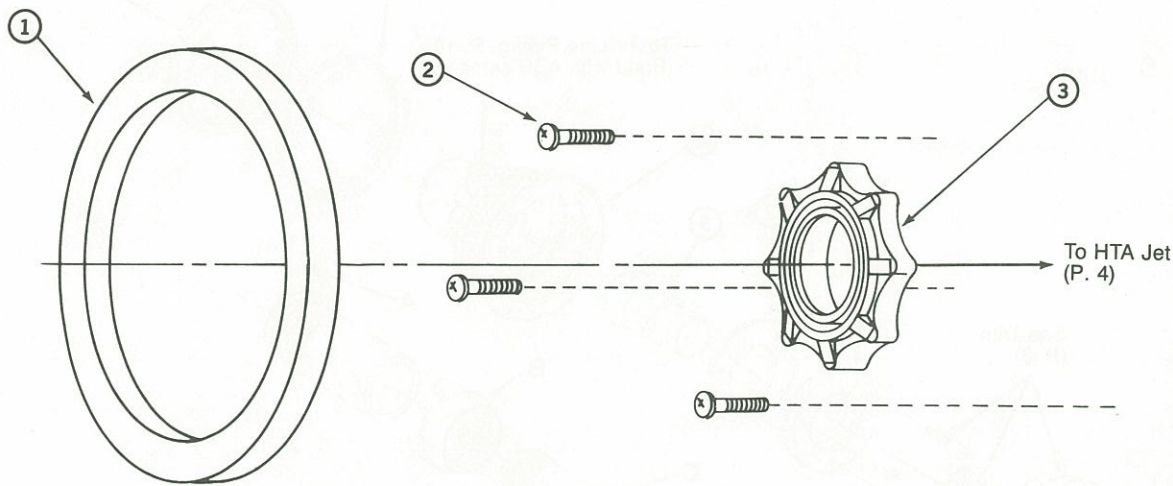

HTA Jet Trim, Chrome

ITEM	P/N	DESCRIPTION	QTY
1	4120827	Face Ring, HTA Chrome	1
2	3967000	Screw, Mach., PHP, #8-32 x .50" L.	3
3	*3641827	Venturi Handle, Chrome	1

HTA Jet Trim, Gold

ITEM	P/N	DESCRIPTION	QTY
1	4120828	Face Ring, HTA Gold	1
2	4043828	Screw, PHPM, #8-32 x .50" L., Gold	3
3	*3641828	Venturi Handle, Gold	1

HTA Jet Trim, Bright Brass

ITEM	P/N	DESCRIPTION	QTY
1	4120829	Face Ring, HTA Bright Brass	1
2	4043829	Screw, PHPM, #8-32 x .50" L., Bright Brass	3
3	*3641829	Venturi Handle, Bright Brass	1

HTA Jet Trim, Antique Brass

ITEM	P/N	DESCRIPTION	QTY
1	4120847	Face Ring, HTA Antique Brass	1
2	4043847	Screw, PHPM, #8-32 x .50" L., Antique Brass	3
3	*3641847	Venturi Handle, Antique Brass	1

***NOTE:** When ordering Venturi Handle, HTA Swivel Assembly must also be ordered. See Page 4, Item 3.

HTA JET

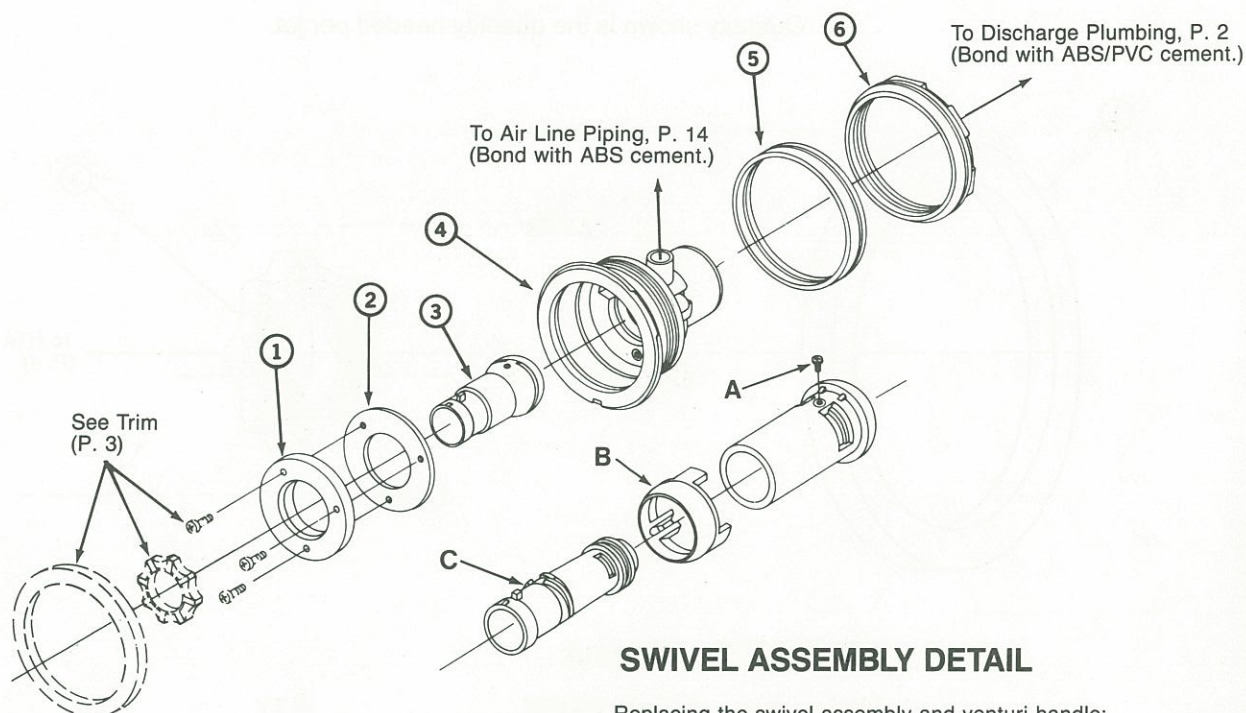

SWIVEL ASSEMBLY DETAIL

Replacing the swivel assembly and venturi handle:

Remove 3 screws securing clamping ring and gasket from jet body. Pull swivel ring B (see Detail) away from swivel to expose retaining screw A. Remove screw A from swivel. Turn venturi C counterclockwise until it is unscrewed and free from the swivel. Install new swivel assembly, securing it with clamping ring, gasket, and 3 screws. Screws are properly tightened when the swivel assembly can still be manually moved from side to side, but tight enough to allow the venturi handle to be turned to adjust water flow without turning the swivel. To install the handle, align the two projections on the swivel assembly with the notches on the handle and snap it on. Note: When installed, the handle is permanently in place: attempting to remove it will damage the snap-on feature of the handle.

ITEM	P/N	DESCRIPTION	QTY
1	1926000	Clamping Ring, HTA	1
2	1928000	Gasket, Clamping Ring, HTA	1
3	*4881000	Swivel Assembly, HTA	1
4	1644000	Body, HTA Inlet	1
5	1925000	Back-up Ring, HTA Inlet	1
6	1645000	Nut, HTA Inlet	1

***NOTE:** When ordering HTA Swivel Assembly, Venturi Handle must also be ordered. See Page 3, Item 3.

HTA JET (WITH SENSOR)

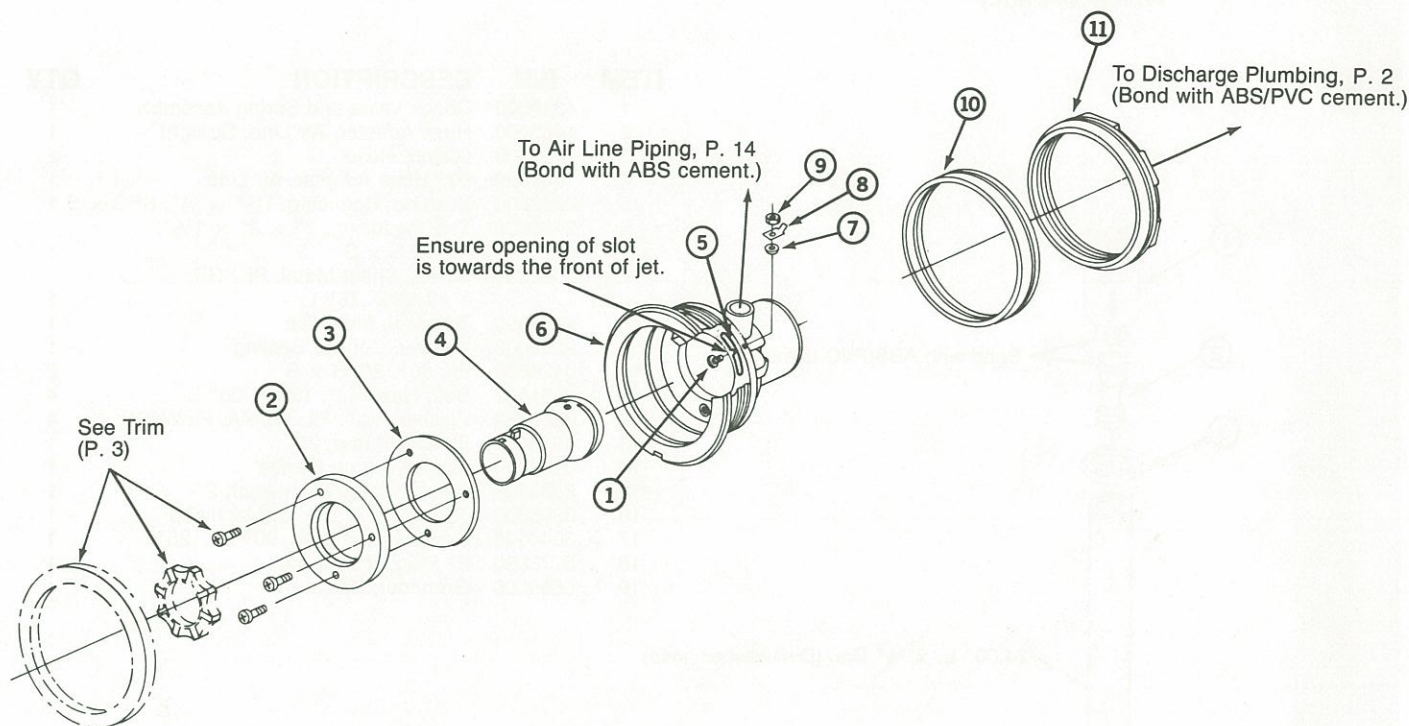

5424000 HTA Jet Sub-Assembly W/Sensor

ITEM	P/N	DESCRIPTION	QTY
1	3967000	Screw, PHPM #8-32 x .50" L.	1
2	1926000	Clamping Ring, HTA	1
3	1928000	Gasket, Clamping Ring, HTA	1
4	*4881000	Swivel Assembly, HTA	1
5	6315000	Sensor Strip, HTA	1
6	5449000	Hole Location, Sensor HTA Jet	1
7	2202000	Washer, Conical Sealing	1
8	5414000	Terminal, Male Tab	1
9	5269832	Nut, Locking, Hd Kep Type #8-32	1
10	1925000	Back-up Ring, HTA Inlet	1
11	1645000	Nut, HTA Inlet	1

***NOTE:** When ordering HTA Swivel Assembly, Venturi Handle must also be ordered. See Page 3, Item 3.

SUCTION PLUMBING

(2" Sch. 40 PVC and 5/8" dishwasher hose, shown for reference, are not available from Jacuzzi Whirlpool Bath.)

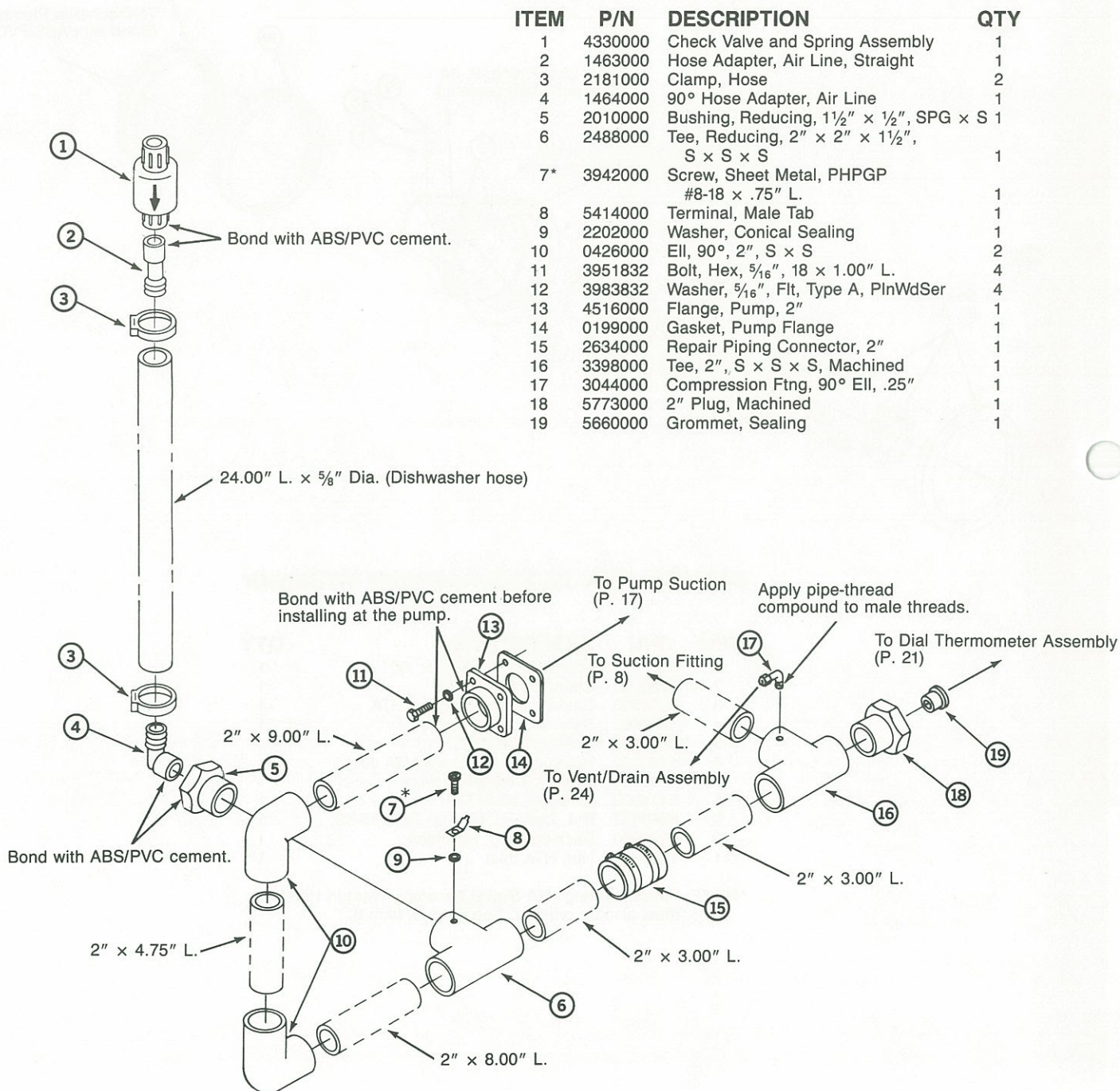

***NOTE:** The proper size of this stainless screw 7 is necessary for correct water level sensing. Do not replace it with a different size screw.

SUCTION COVER/STRAINER

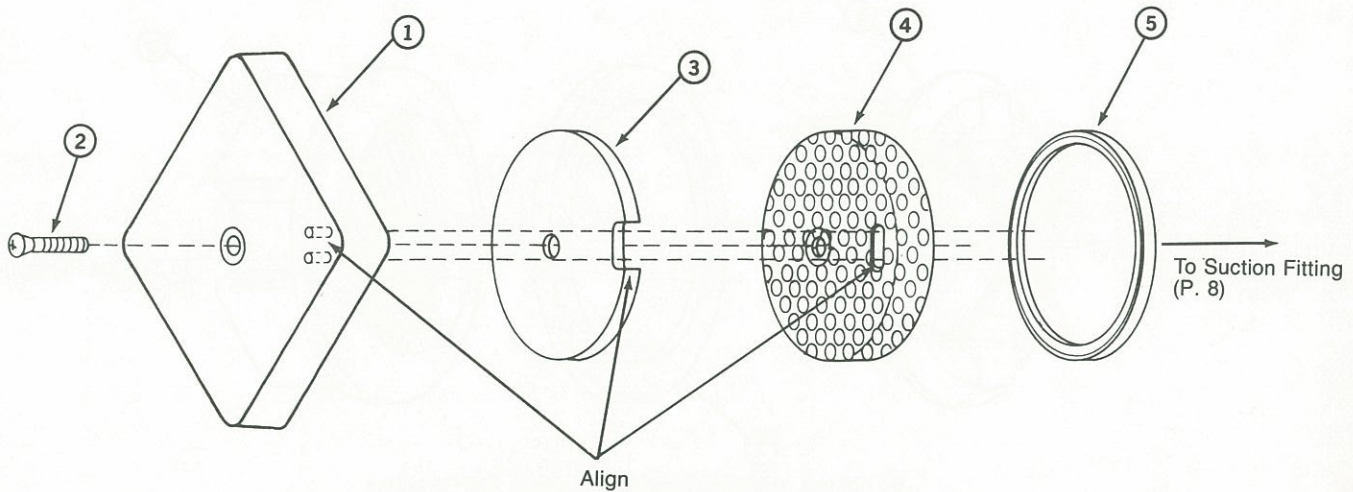

Suction Cover/Strainer, Chrome

ITEM	P/N	DESCRIPTION	QTY
1	4124827	Suction Cover, Chrome	1
2	3958000	Screw, Machined, OHP #10-24 x 1.25" L.	1
3	4627000	Gasket, Suction Screen	1
4	3060836	Suction Strainer, Modified Blk. Nickel	1
5	4507000	Ring, Suction Strainer	1

Suction Cover/Strainer, Gold

ITEM	P/N	DESCRIPTION	QTY
1	4124828	Suction Cover, Gold	1
2	4190828	Screw, OHPM #10-24 x 1.25" L., Gold	1
3	4627000	Gasket, Suction Screen	1
4	3060836	Suction Strainer, Modified Blk. Nickel	1
5	4507000	Ring, Suction Strainer	1

Suction Cover/Strainer, Bright Brass

ITEM	P/N	DESCRIPTION	QTY
1	4124829	Suction Cover, Bright Brass	1
2	4190829	Screw, OHPM #10-24 x 1.25" L., Bright Brass	1
3	4627000	Gasket, Suction Screen	1
4	3060836	Suction Strainer, Modified Blk. Nickel	1
5	4507000	Ring, Suction Strainer	1

Suction Cover/Strainer, Antique Brass

ITEM	P/N	DESCRIPTION	QTY
1	4124847	Suction Cover, Antique Brass	1
2	4190847	Screw, OHPM #10-24 x 1.25" L., Antique Brass	1
3	4627000	Gasket, Suction Screen	1
4	3060836	Suction Strainer, Modified Blk. Nickel	1
5	4507000	Ring, Suction Strainer	1

SUCTION FITTING

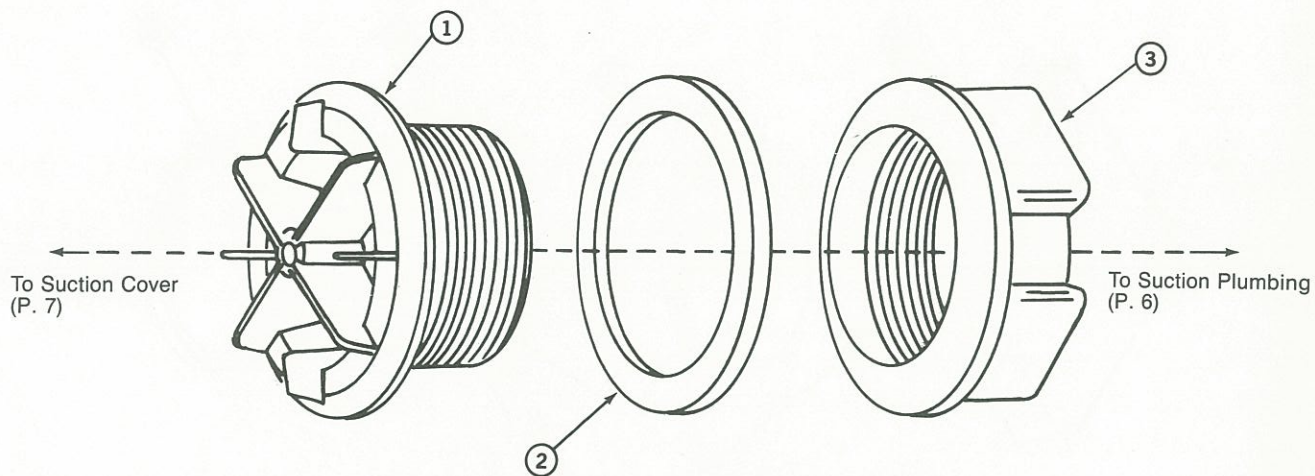

Do not use #1836000 Back-up Ring from AMH Jet. Use of non-interchangeable parts may cause leaks or malfunction.

ITEM	P/N	DESCRIPTION	QTY
1	1958000	Suction Fitting Sub-Assembly	1
2	2136000	Back-up Ring, Suction	1
3	1643000	Locknut, Suction Fitting	1

FLUSH MOUNT FILL SPOUT/DIVERTER ASSEMBLY

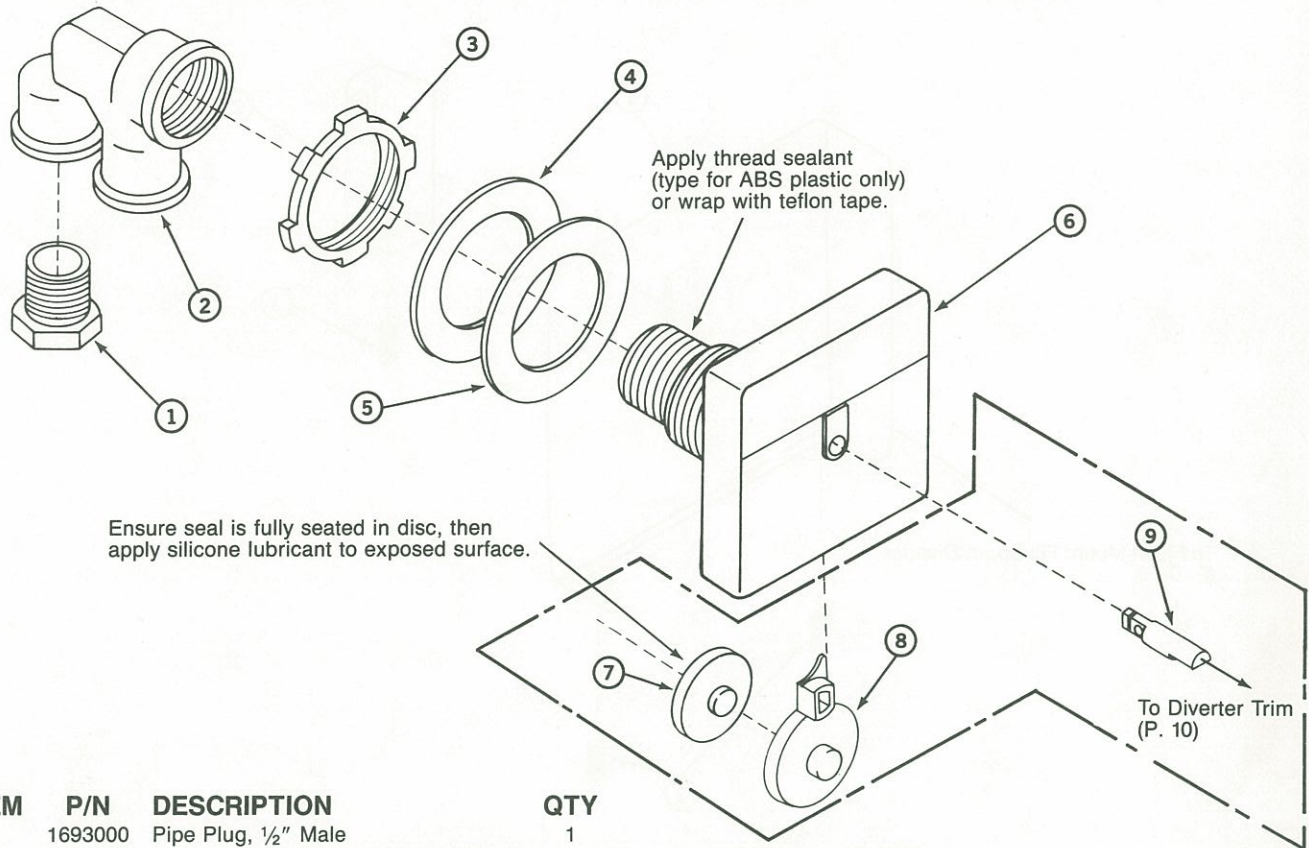

ITEM	P/N	DESCRIPTION	QTY
1	1693000	Pipe Plug, 1/2" Male	1
2	1681000	Diverter, .5" x .5" x .75", Twin Ell	1
3	4825832	Locknut, 1"-11 1/2" NPT	1
4	4708000	Washer, 1.313" I.D. x 2.25" O.D., Fibre	1
5	1707000	Washer, 1.313" I.D. x 2.25" O.D., Rubber	1
6	1593000 5728000	Fill Spout Body	1

Assemble parts 7 and 8 then insert assembly up into bottom of fill spout. Insert 9 through fill spout hole and disc hole so that flat side of shaft is down to ensure proper knob actuation.

2449000 Diverter Seal Assembly (Order by Assembly Number)

ITEM	P/N	DESCRIPTION	QTY
7	1662000*	Seal, Fill Spout/Diverter	1
8	1669000*	Disc, Diverter	1
9	1668000*	Shaft, Diverter	1
N.S.	5184000*	Lubricant, Silicone Base, 2 cc	1

*Not available as single parts.

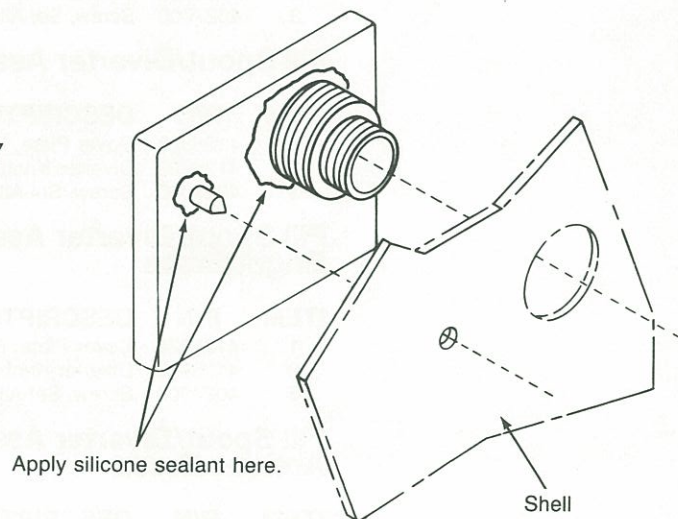

FLUSH MOUNT FILL SPOUT/DIVERTER ASSEMBLY TRIM

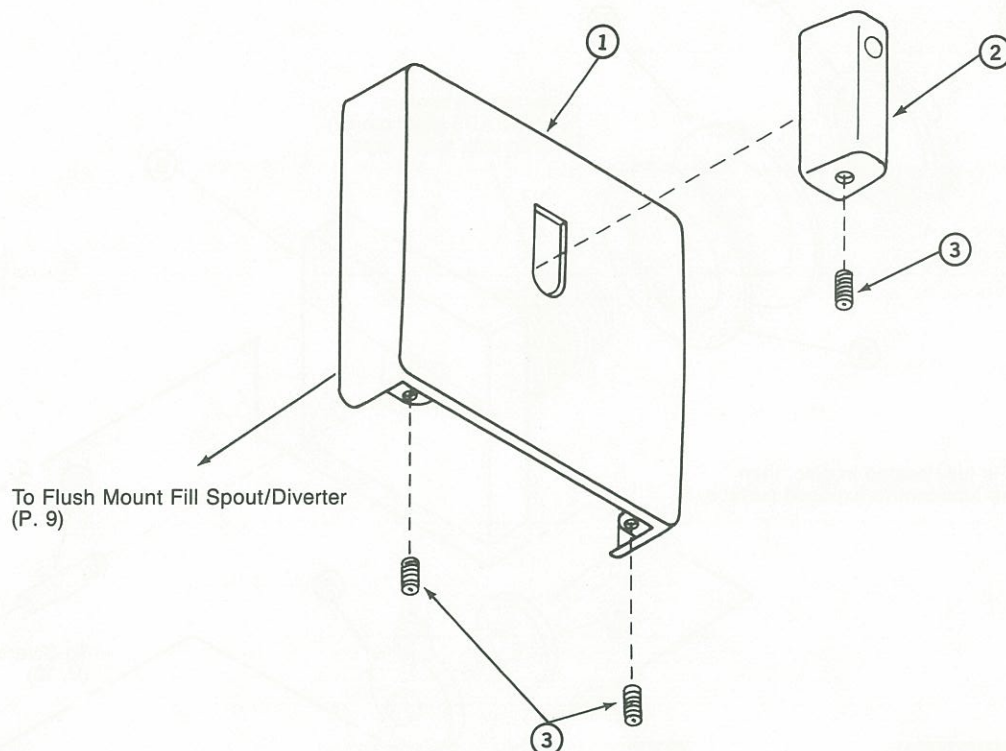

Fill Spout/Diverter Assembly Trim, Chrome

ITEM	P/N	DESCRIPTION	QTY
1	4125827	Cover Plate, Fill Spout, Chrome	1
2	4126827	Diverter Knob, Chrome	1
3	4027000	Screw, Set-Allen CP #6-32 x .25" L.	3

Fill Spout/Diverter Assembly Trim, Gold

ITEM	P/N	DESCRIPTION	QTY
1	4125828	Cover Plate, Fill Spout, Gold	1
2	4126828	Diverter Knob, Gold	1
3	4027000	Screw, Set-Allen CP #6-32 x .25" L.	3

Fill Spout/Diverter Assembly Trim, Bright Brass

ITEM	P/N	DESCRIPTION	QTY
1	4125829	Cover Plate, Fill Spout, Bright Brass	1
2	4126829	Diverter Knob, Bright Brass	1
3	4027000	Screw, Set-Allen CP #6-32 x .25" L.	3

Fill Spout/Diverter Assembly Trim, Antique Brass

ITEM	P/N	DESCRIPTION	QTY
1	4125847	Cover Plate, Fill Spout, Antique Brass	1
2	4126847	Diverter Knob, Antique Brass	1
3	4027000	Screw, Set-Allen CP #6-32 x .25" L.	3

FAUCET ASSEMBLY (LESS TRIM)

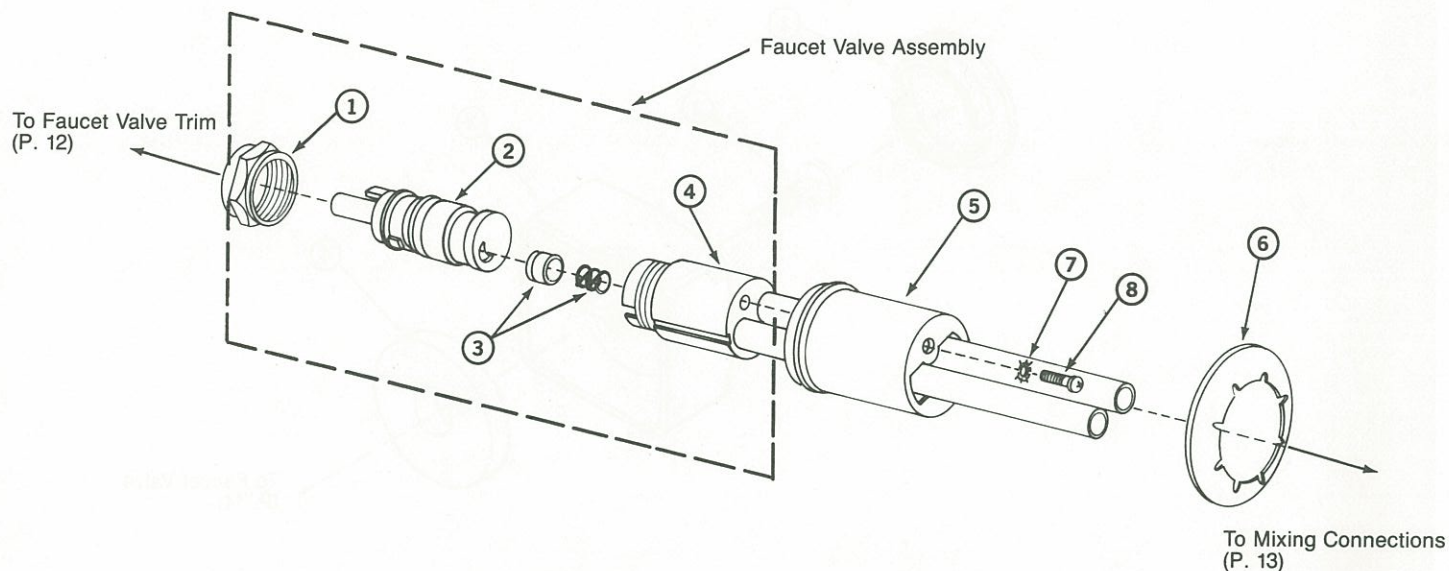

Faucet Assembly

ITEM	P/N	DESCRIPTION	QTY**
1	N/A*	Retainer, Bonnet Cylinder (Delta RP 1713)	1
2	2464000	Cylinder Valve Assembly-Cartridge (Delex Delta RP 1740)	1
3	2469000	Seat and Spring Kit (Delex-Delta 4993)	1
4	N/A*	Body, Delta Valve (Delta RP 6738)	1
5	2313000	Mount, Valve Body	1
6	2338000	Speed Nut, Push-on, 1.5"	1
7	4051000	Washer, #10 Ext. Tooth, Locking	2
8	3971000	Screw, Machined, PHP, #10-24 x .50" L.	2

2334000 Faucet Valve Assembly (Order by Assembly Number)

ITEM	P/N	DESCRIPTION	QTY**
1	N/A*	Retainer, Bonnet Cylinder (Delta RP 1713)	1
2	2464000	Cylinder Valve Assembly-Cartridge (Delex Delta RP 1740)	1
3	2469000	Seat and Spring Kit (Delex Delta 4993)	1
4	N/A*	Body, Delta Valve (Delta RP 6738)	1

*Not available as a single part.

**Quantity shown is the number of items required for each faucet valve.

FAUCET VALVE TRIM

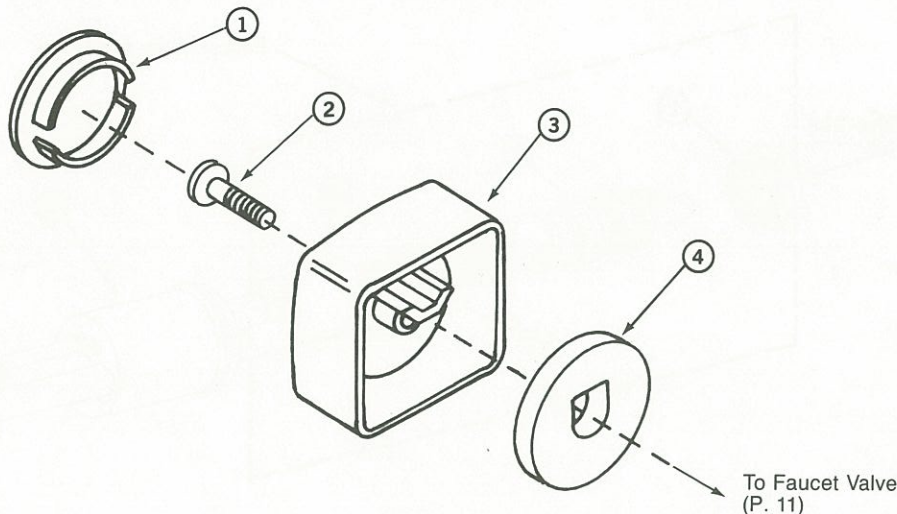

Faucet Valve Trim, Chrome (Hot)

ITEM	P/N	DESCRIPTION	QTY
1	4151000	Insert, Faucet Handle, Chrome, Hot (Red Dot)	1
2	3970000	Screw, Machined, PHP, #10-24 x .38" L.	1
3	4127827	Faucet Handle, Chrome	1
4	2329000	Gasket, Faucet Handle	2

Faucet Valve Trim, Gold (Hot)

ITEM	P/N	DESCRIPTION	QTY
1	4152000	Insert, Faucet Handle, Gold, Hot (Red Dot)	1
2	3970000	Screw, Machined, PHP, #10-24 x .38" L.	1
3	4127828	Faucet Handle, Gold	1
4	2329000	Gasket, Faucet Handle	2

Faucet Valve Trim, Bright Brass (Hot)

ITEM	P/N	DESCRIPTION	QTY
1	4153000	Insert, Faucet Handle, Bright Brass, Hot (Red Dot)	1
2	3970000	Screw, Machined, PHP, #10-24 x .38" L.	1
3	4127829	Faucet Handle, Bright Brass	1
4	2329000	Gasket, Faucet Handle	2

Faucet Valve Trim, Antique Brass (Hot)

ITEM	P/N	DESCRIPTION	QTY
1	6415000	Insert, Faucet Handle, Antique Brass, Hot (Red Dot)	1
2	3970000	Screw, Machined, PHP, #10-24 x .38" L.	1
3	4127847	Faucet Handle, Antique Brass	1
4	2329000	Gasket, Faucet Handle	2

Faucet Valve Trim, Chrome (Cold)

ITEM	P/N	DESCRIPTION	QTY
1	4156000	Insert, Faucet Handle, Chrome, Cold (Blue Dot)	1
2	3970000	Screw, Machined, PHP, #10-24 x .38" L.	1
3	4127827	Faucet Handle, Chrome	1
4	2329000	Gasket, Faucet Handle	2

Faucet Valve Trim, Gold (Cold)

ITEM	P/N	DESCRIPTION	QTY
1	4157000	Insert, Faucet Handle, Gold, Cold (Blue Dot)	1
2	3970000	Screw, Machined, PHP, #10-24 x .38" L.	1
3	4127828	Faucet Handle, Gold	1
4	2329000	Gasket, Faucet Handle	2

Faucet Valve Trim, Bright Brass (Cold)

ITEM	P/N	DESCRIPTION	QTY
1	4158000	Insert, Faucet Handle, Bright Brass, Cold (Blue Dot)	1
2	3970000	Screw, Machined, PHP, #10-24 x .38" L.	1
3	4127829	Faucet Handle, Bright Brass	1
4	2329000	Gasket, Faucet Handle	2

Faucet Valve Trim, Antique Brass (Cold)

ITEM	P/N	DESCRIPTION	QTY
1	6416000	Insert, Faucet Handle, Antique Brass, Cold (Blue Dot)	1
2	3970000	Screw, Machined, PHP, #10-24 x .38" L.	1
3	4127847	Faucet Handle, Antique Brass	1
4	2329000	Gasket, Faucet Handle	2

MIXING CONNECTIONS

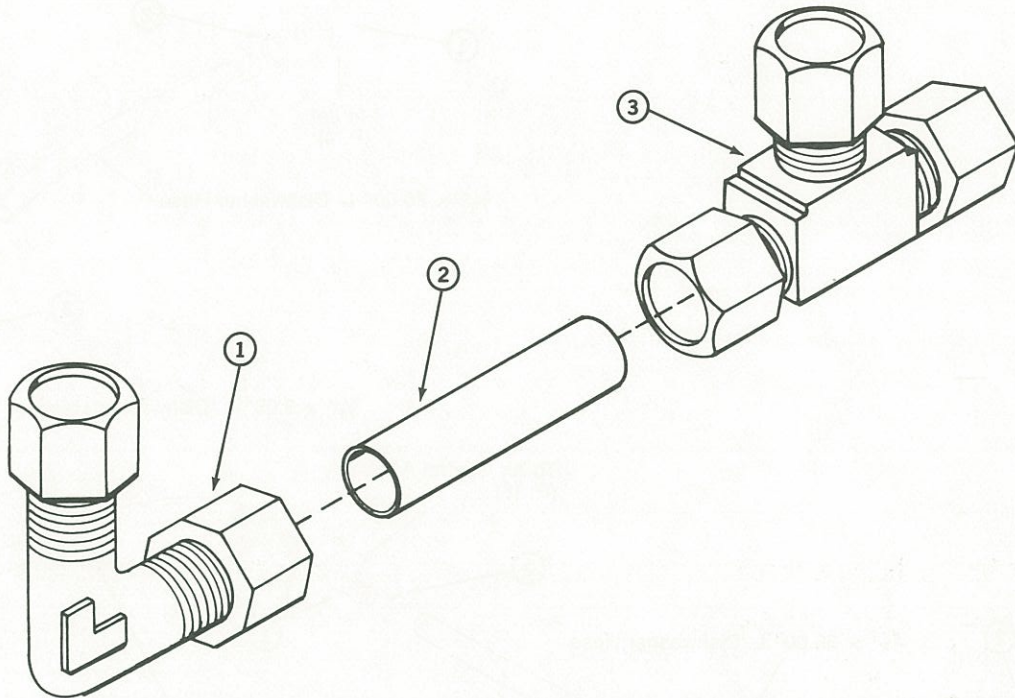

ITEM	P/N	DESCRIPTION	QTY
1	2330000	Elb, 90° Compression .5 Nom. Tube	1
2	2331000	Copper Tube, 3/8" Nom. x 1.75" L.	1
3	2332000	Tee, Compression .5" x .5" x .5", Nom. O.D.	1

AIR LINE PIPING

($\frac{5}{8}$ " Dishwasher Hose, shown for reference, is not available from Jacuzzi Whirlpool Bath.)

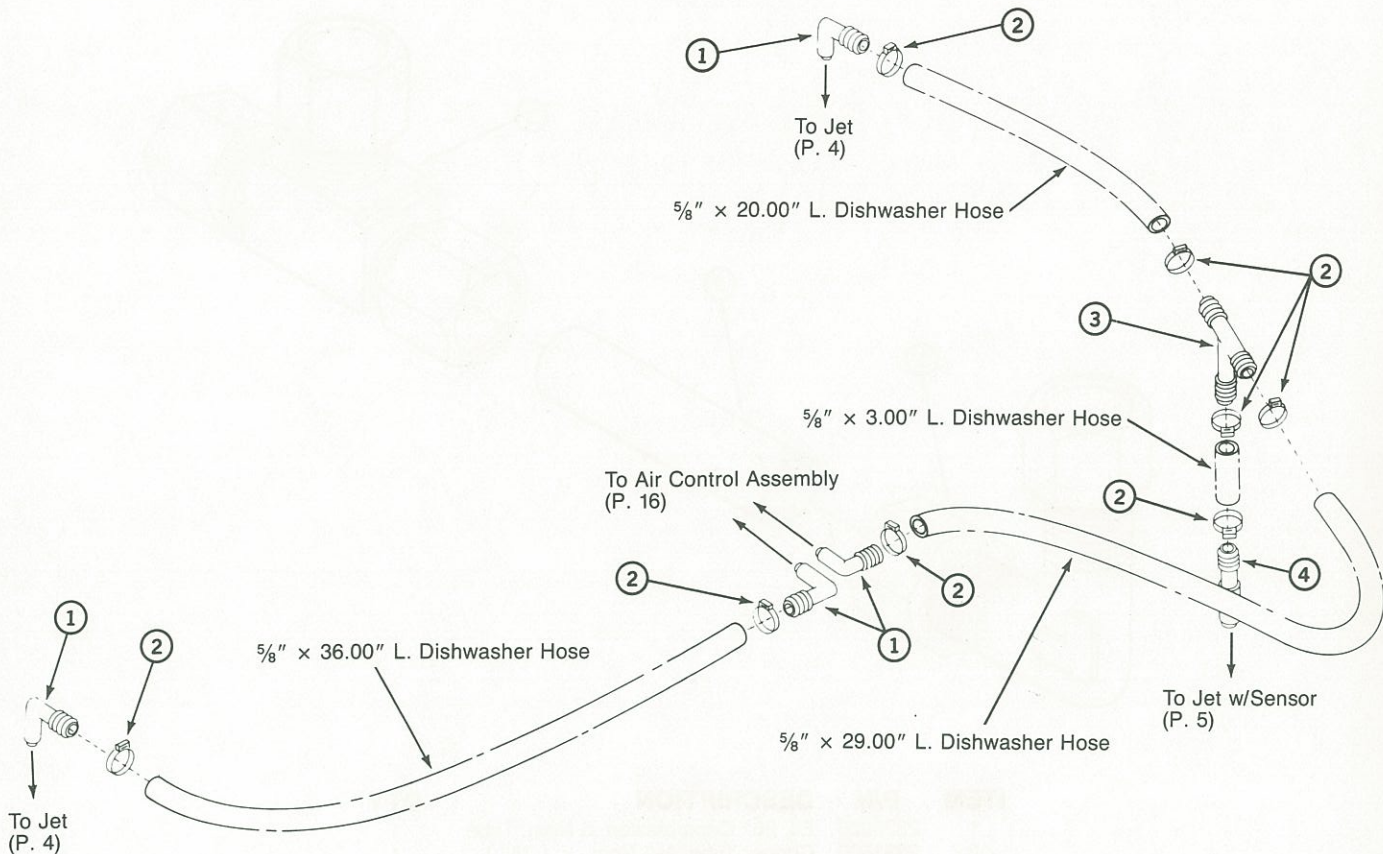

ITEM	P/N	DESCRIPTION	QTY
1	1464000	90° Hose Adapter—Air Line	4
2	2181000	Clamp, Hose	8
3	1404000	Tee, Barbed, $\frac{1}{2}$ "	1
4	1463000	Hose Adapter, Air Line, Straight	1

AIR CONTROL KNOB

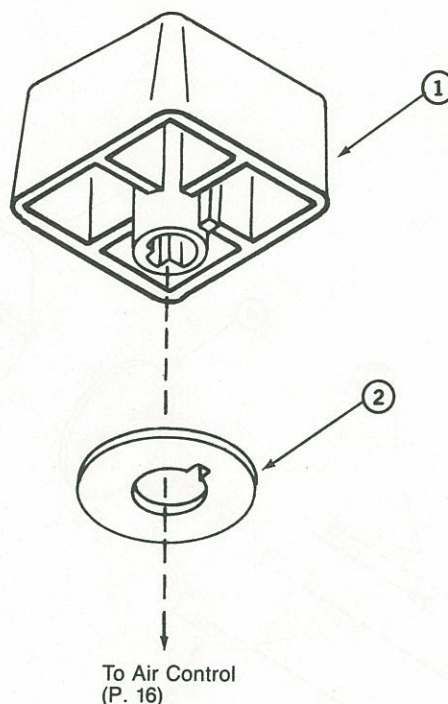

Air Control Knob Assembly, Chrome (Order two of each to replace the full set.)

ITEM	P/N	DESCRIPTION	QTY
1	5132827	Air Control Knob Sub-Assembly, Chrome	1
2	3153000	Spacer, Air Control Knob	1

Air Control Knob Assembly, Gold

ITEM	P/N	DESCRIPTION	QTY
1	5132828	Air Control Knob Sub-Assembly, Gold	1
2	3153000	Spacer, Air Control Knob	1

Air Control Knob Assembly, Bright Brass

ITEM	P/N	DESCRIPTION	QTY
1	5132829	Air Control Knob Sub-Assembly, Bright Brass	1
2	3153000	Spacer, Air Control Knob	1

Air Control Knob Assembly, Antique Brass

ITEM	P/N	DESCRIPTION	QTY
1	5132847	Air Control Knob Sub-Assembly, Antique Brass	1
2	3153000	Spacer, Air Control Knob	1

AIR CONTROL ASSEMBLY

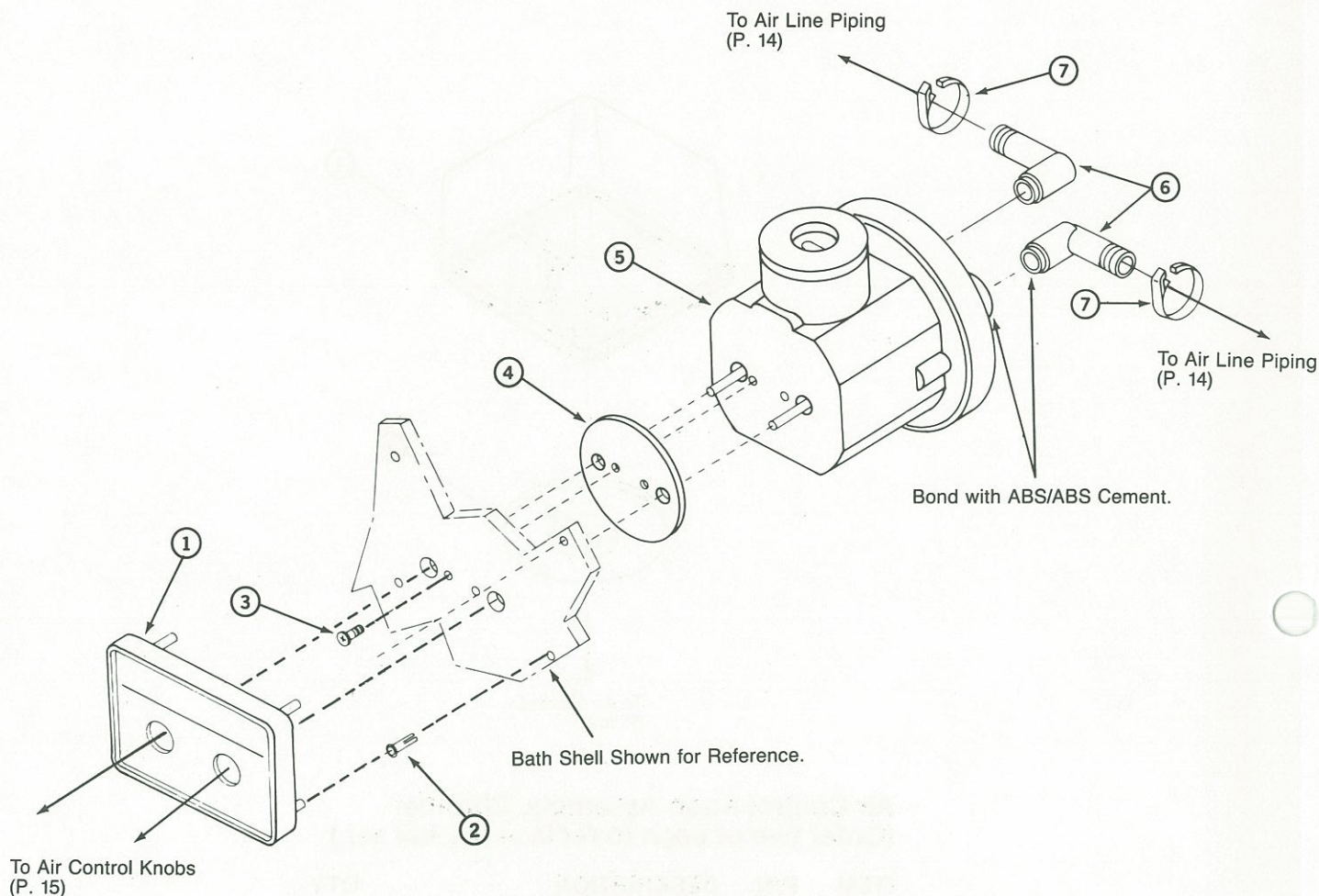

ITEM	P/N	DESCRIPTION	QTY
1	1108000	Panel Assy., Silent Air Induction System	1
2	1000000	Speed Clip, Tubular	4
3	3968000	Screw, Machined, PHP #8-32 x .75" L.	2
4	1120000	Gasket, Airbox	1
5	2124000	Air Control Unit Sub-Assembly	1
6	1464000	90° Hose Adapter—Air Line	2
7	2181000	Clamp Hose	2

PUMP ASSEMBLY

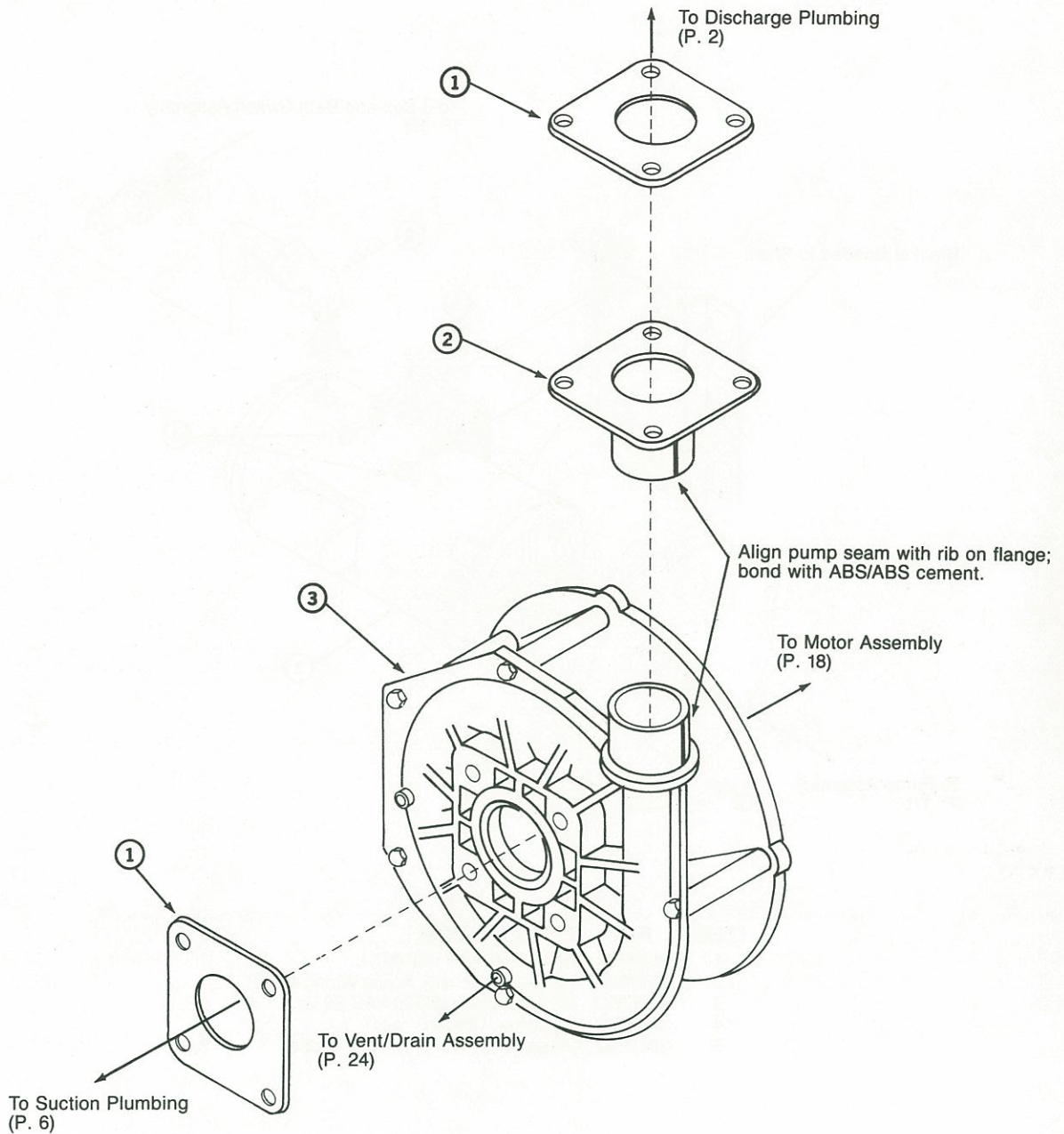

ITEM	P/N	DESCRIPTION	QTY
1	0199000	Gasket, Pump Flange	2
2	4516000	Flange, Pump 2"	1
3	4580000	Pump Assembly, .5 HP	1
4	3044000	Compression Ftg., 90° Ell, .25"	1

MOTOR/BRACKET ASSEMBLY

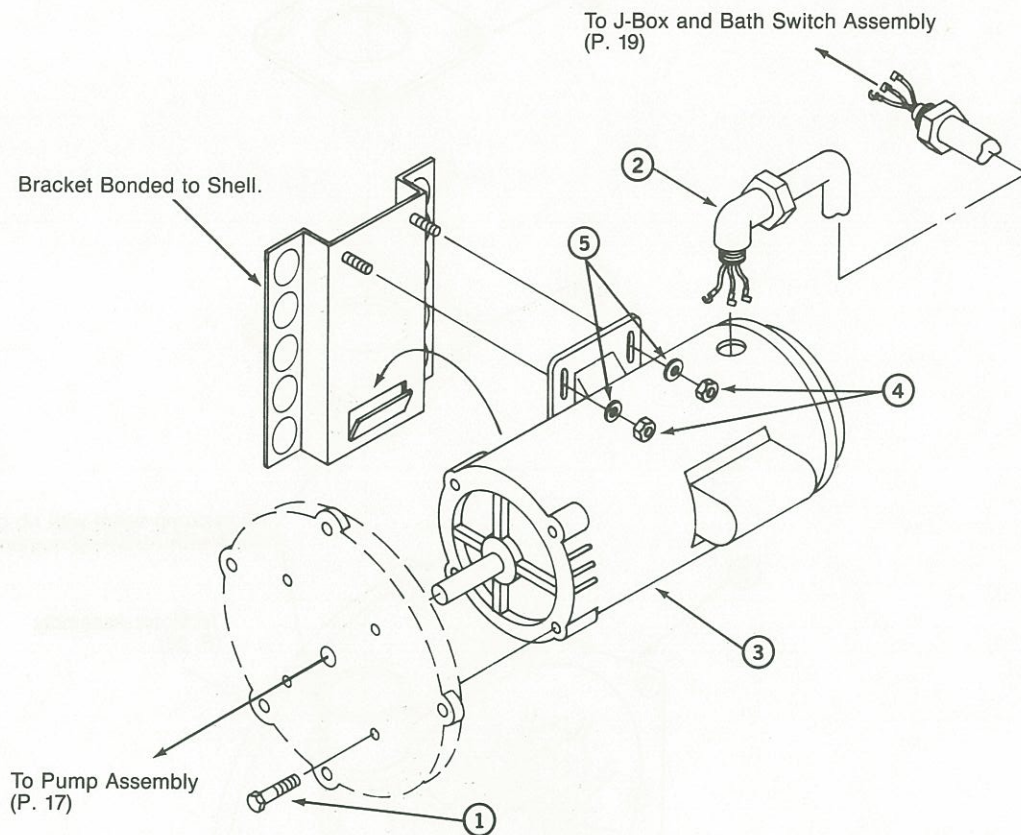

ITEM	P/N	DESCRIPTION	QTY
1	3953832	Bolt, Hex 3/8-16 x 1.00" L.	4
2	5411000	Harness Assembly, Power Wiring 40.00" L.	1
3	2095000	Motor, .5 HP, 115/230 VAC 60 Hz	1
4	3992832	Nut, Hex, UNC-2B 1/4-20	2
5	3982832	Washer, 1/4" Flt, Type A PlnWdSer	2

J-BOX AND BATH SWITCH ASSEMBLY

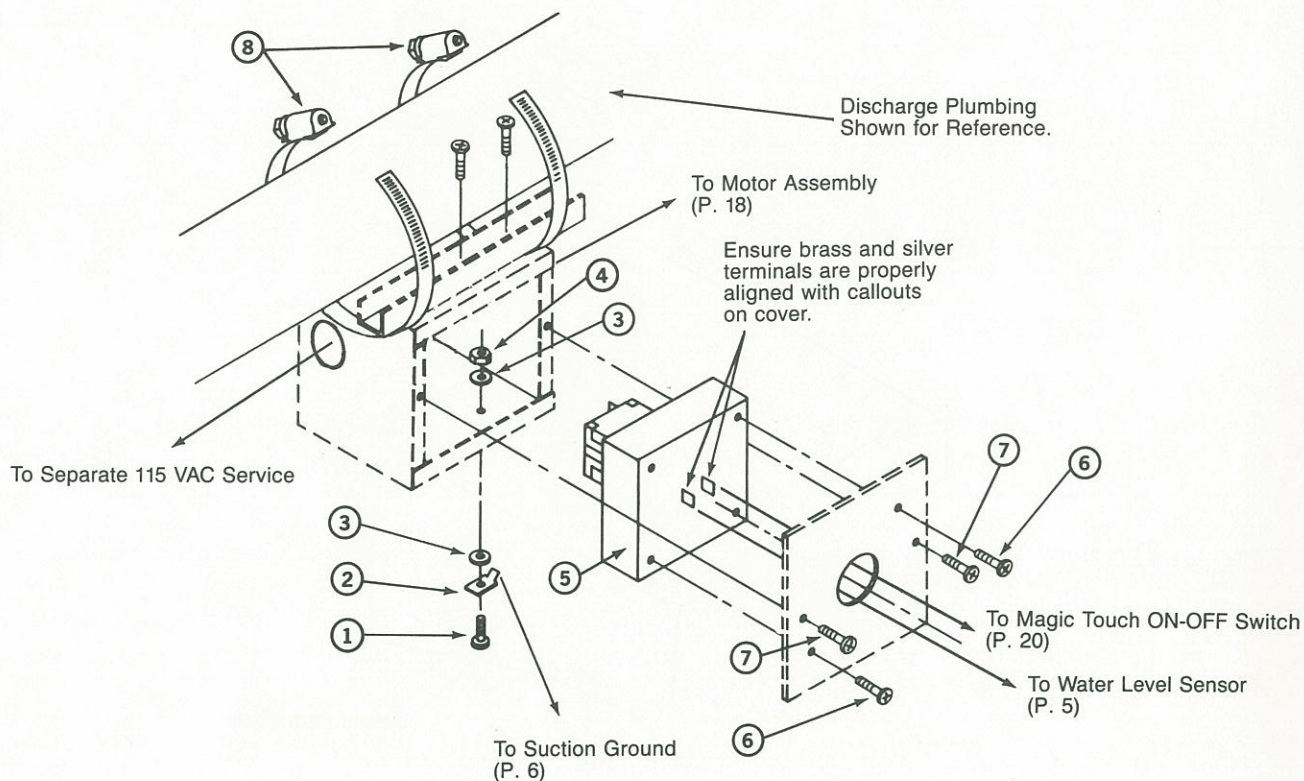

ITEM	P/N	DESCRIPTION	QTY
1	3967000	Screw, Machined, PHP #8-32 x .50" L.	1
2	5414000	Terminal, Male Tab	1
3	4011832	Washer, #8 Extnl. Tooth, Locking	2
4	3990832	Nut, Hex, UNC-2B #8-32	1
5	5246000	Switch Module, Adjustable	1
6	3939000	Screw, Sheet Metal, PHPGP #6-20 x .50" L.	2
7	4039832	Screw, TPG, PHP Type F #6-32 x .5" L.	2
8	0438000	Clamp, Hose, #H-40 Worm Drv Type	2

MAGIC TOUCH ON-OFF/WATER LEVEL SWITCH (LEVELS 2 AND 3 ONLY)

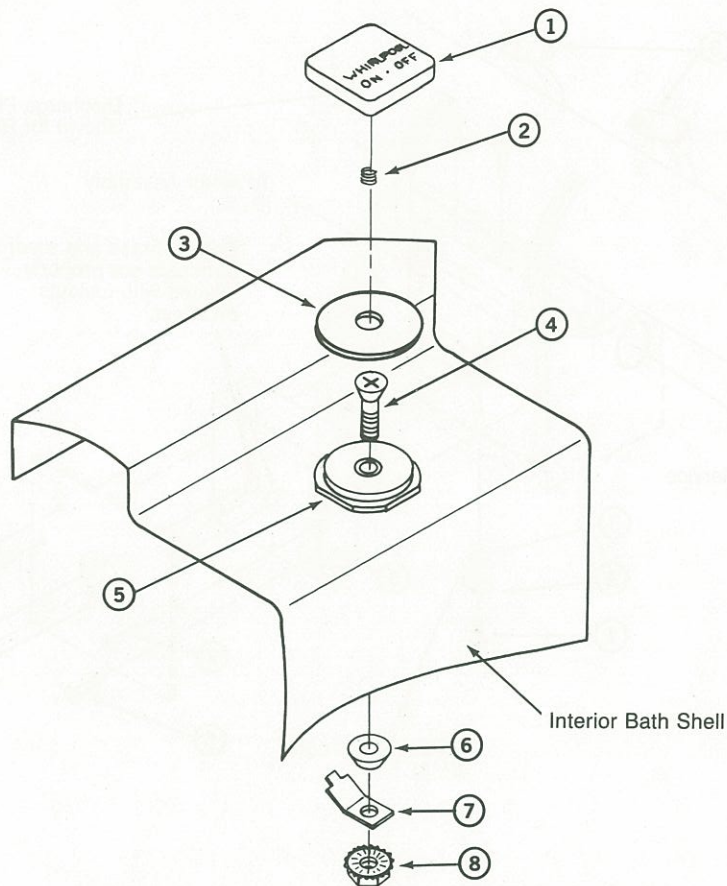

ITEM	P/N	DESCRIPTION	QTY
1	5407827	Cap, ON/OFF Switch, Chrome	1
1	5407828	Cap, ON/OFF Switch, Gold	1
1	5407829	Cap, ON/OFF Switch, Bright Brass	1
1	5407847	Cap, ON/OFF Switch, Antique Brass	1
2	5421000	Spring, Compression	1
3	5409000	Adhesive, Switch Pad	1
4	5418000	Screw, Machined, PHF, #8-32 x 1.00" L.	1
5	5408000	Bracket, ON/OFF Switch	1
6	2202000	Washer, Conical Sealing	1
7	5414000	Terminal, Male Tab	1
8	5269832	Nut, Locking, Hd Kep Type #8-32	1

DIAL THERMOMETER ASSEMBLY (LEVELS 1 AND 2 ONLY)

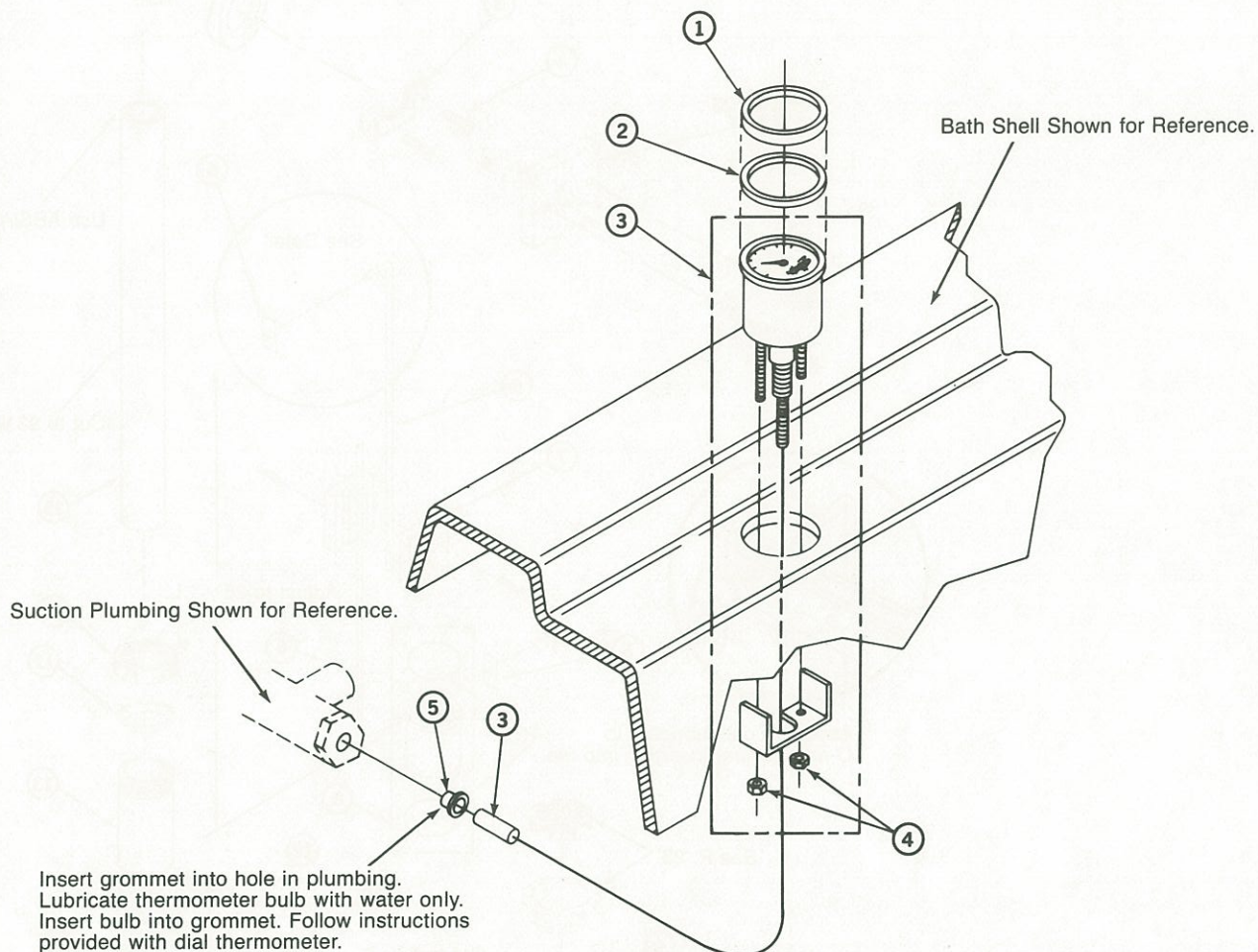

ITEM	P/N	DESCRIPTION	QTY
1	4135000	Trim Ring, Dial Thermometer	1
1	4135827	Trim Ring, Chrome	1
1	4135828	Trim Ring, Gold	1
1	4135829	Trim Ring, Bright Brass	1
2	3723000	Adhesive, Trim Ring	1
3	1887000	Dial Thermometer	1
4	3527000	Nut, Hex #10-32 UNF-2B	2
5	5660000	Grommet, Sealing	1

DRAIN/OVERFLOW (LESS TRIM)

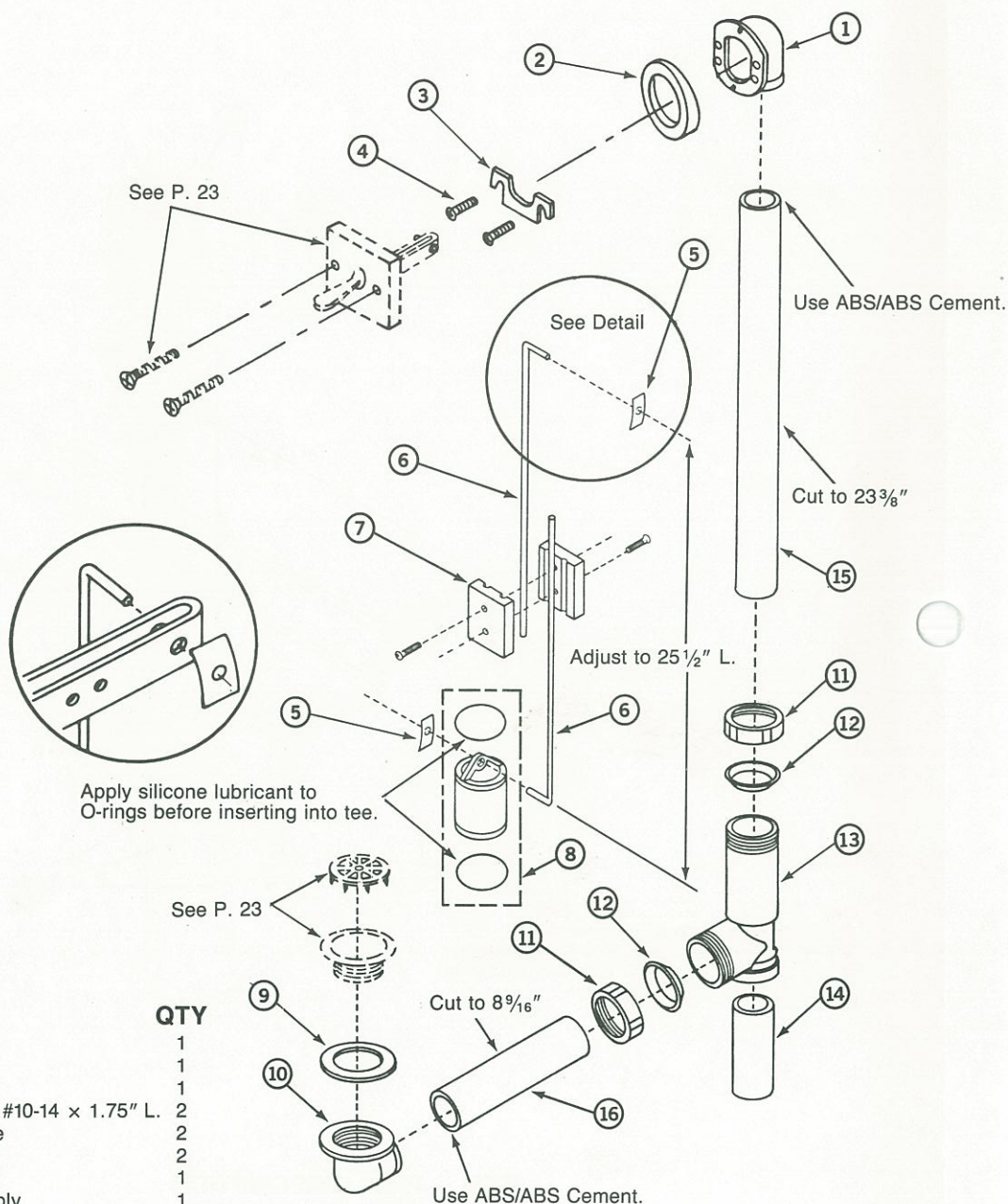

ITEM	P/N	DESCRIPTION	QTY
1	2618000	Elbow, Overflow	1
2	2648000	Gasket, Overflow Seal	1
3	3597000	Retaining Plate	1
4	2660000	Screw, PHP, Thrd. Roll, #10-14 x 1.75" L.	2
5	3638000	Fastener, Push-on Type	2
6	3595000	Rod, Actuator	2
7	2653000	Clamp, Rod	1
8	5661000	Repair Plunger Assembly	1
9	3591000	Gasket, Waste Seal	1
10	3590000	Elbow, 90° Waste	1
11	2641000	Nut, Tube, 1 1/8" DWV	2
12	2642000	Washer, Slip Joint, 1 1/2"	2
13	3588000	Tee, 1 1/2" x 1 1/2" x 1 1/2"	1
14	3589000	Tail Piece	1
15	4648000	Tube, 1.50" O.D. ABS x 23.88" L.	1
16	4647000	Tube, 1.50" O.D. ABS x 15.88" L.	1

DRAIN/OVERFLOW TRIM

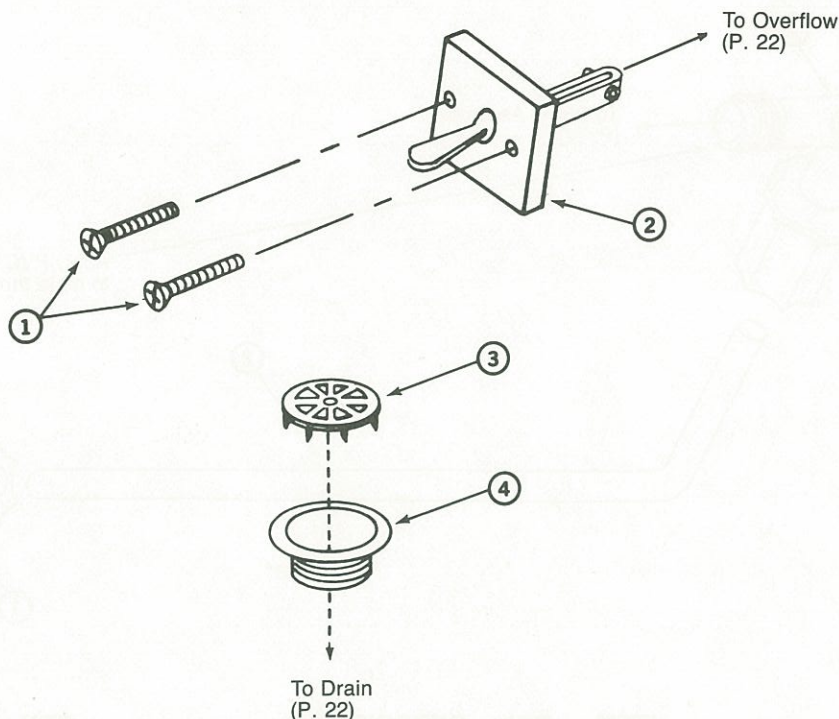

4177827* Drain/Overflow Trim Kit, Chrome

ITEM	P/N	DESCRIPTION	QTY
1	4189827	Screw, OHPM, 1/4-20 x 2" L., Chrome	2
2	4175827	Modified Trip Lever Assembly, Chrome	1
3	4132827	Strainer, Chrome	1
4	4131827	Waste Flange, Chrome	1

4177828* Drain/Overflow Trim Kit, Gold

ITEM	P/N	DESCRIPTION	QTY
1	4189828	Screw, OHPM, 1/4-20 x 2" L., Gold	2
2	4175828	Modified Trip Lever Assembly, Gold	1
3	4132828	Strainer, Gold	1
4	4131828	Waste Flange, Gold	1

4177829* Drain/Overflow Trim Kit, Bright Brass

ITEM	P/N	DESCRIPTION	QTY
1	4189829	Screw, OHPM, 1/4-20 x 2" L., Bright Brass	2
2	4175829	Modified Trip Lever Assembly, Bright Brass	1
3	4132829	Strainer, Bright Brass	1
4	4131829	Waste Flange, Bright Brass	1

4177847* Drain/Overflow Trim Kit, Antique Brass

ITEM	P/N	DESCRIPTION	QTY
1	4189847	Screw, OHPM, 1/4-20 x 2" L., Antique Brass	2
2	4175847	Modified Trip Lever Assembly, Antique Brass	1
3	4132847	Strainer, Antique Brass	1
4	4131847	Waste Flange, Antique Brass	1

*Order by Trim Kit Number or by Single Part Number.

VENT/DRAIN ASSEMBLY

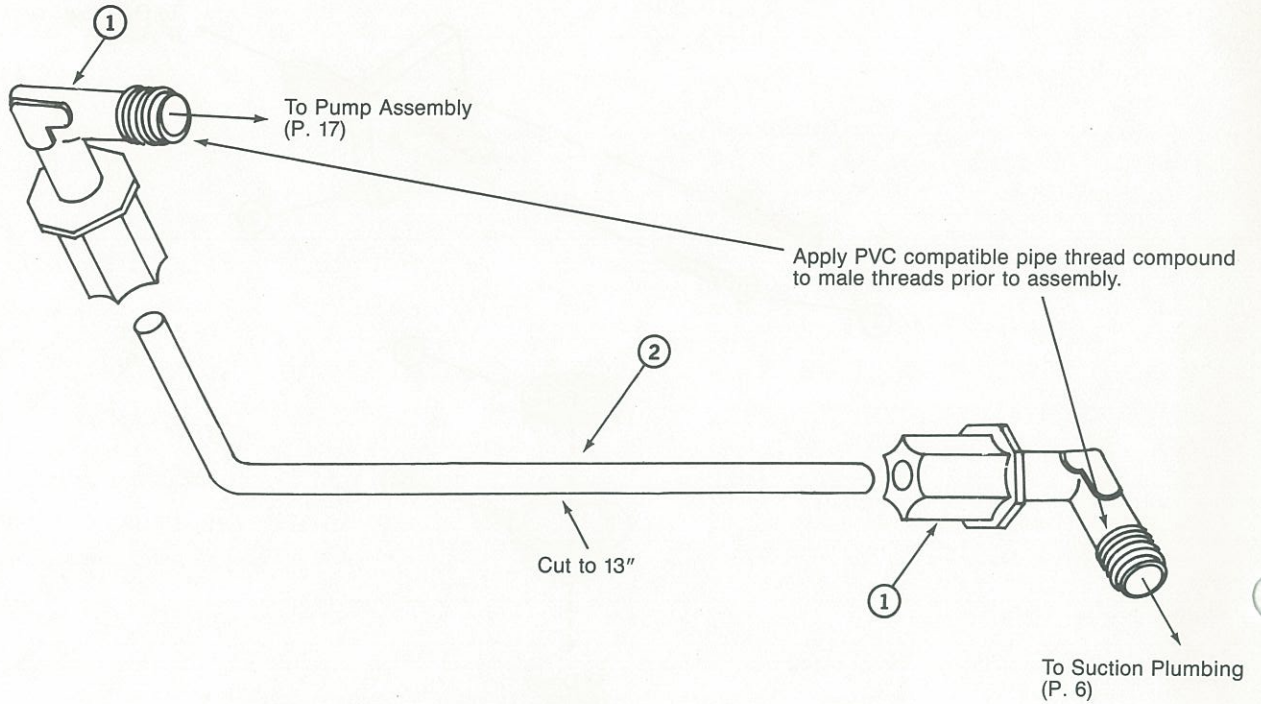

ITEM	P/N	DESCRIPTION	QTY
1	3044000	Compression Ftg., 90° Ell, .25"	2
2	4649000	Tube, .25" O.D. Flex Nylon x 55.00" L.	1

REPAIR CARTON ASSEMBLY

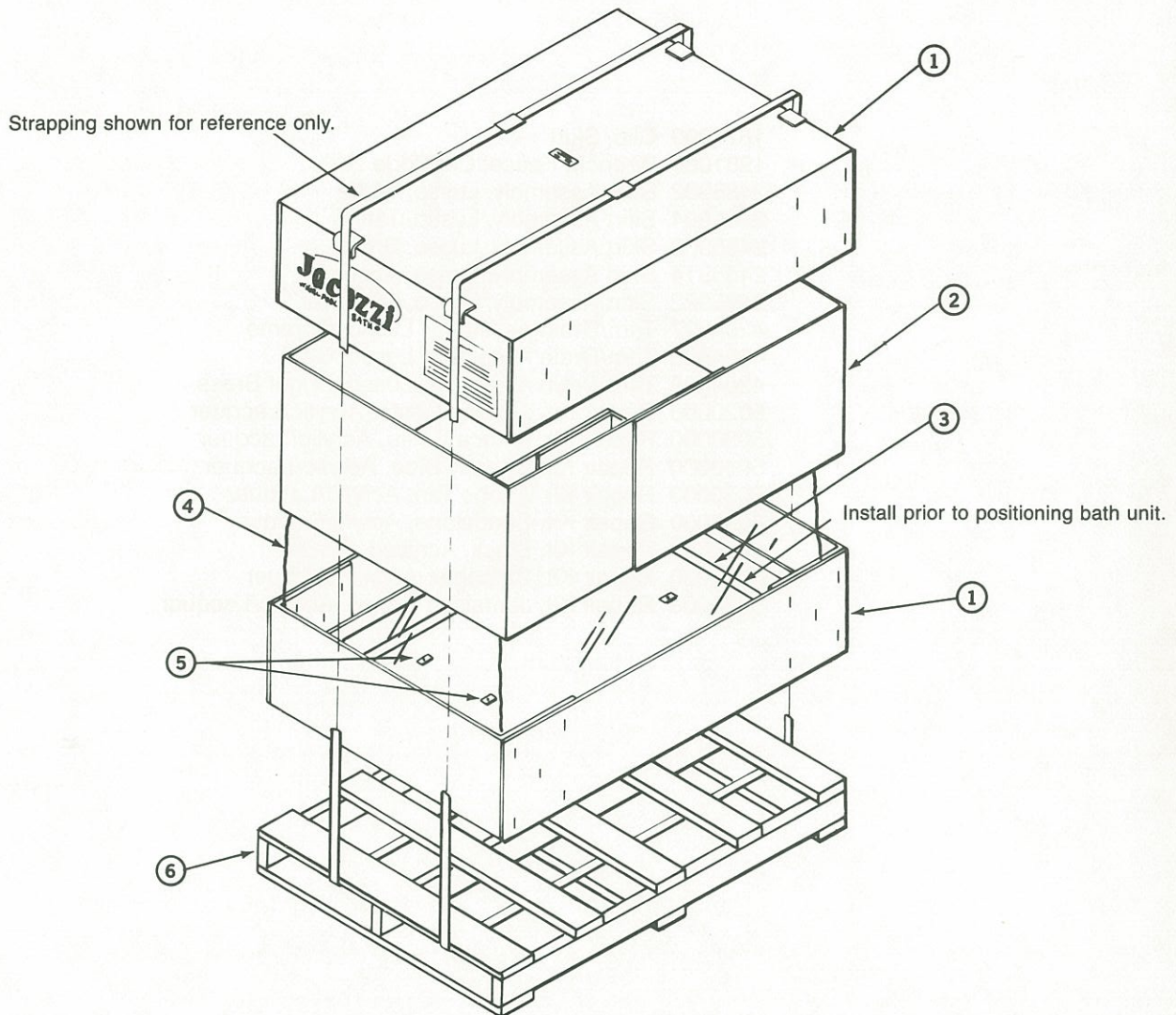

64610000 Repair Carton Assembly (Order by Assembly Number)

ITEM	P/N	DESCRIPTION	QTY
1	2501000*	Carton, Tray, Lusso	2
2	2503000*	U-Pad, Scored, Carton	1
3	2952000*	Liner/Block Assembly	1
4	1059000*	Polycovers, Tubs	1
5	2086000*	Nail, Square Headed Roofing	6
6	2504000*	Pallet Assembly, Lusso	1

*Not Available Separately



LUSO

Model #4970000 Level 1
Model #4970000 Level 2
Model #4970000 Level 3
Issue Date: 2/85

OTHER ITEMS AVAILABLE

1677000 Clip, Skirt
1981000 Wrench, Faucet Cartridge
2485902 Skirt Assembly, Lusso, White
2485904 Skirt Assembly, Lusso, Tan
2485908 Skirt Assembly, Lusso, Brown
2485914 Skirt Assembly, Lusso, Almond
2485922 Skirt Assembly, Lusso, Cinnabar
4204827 Trim/Drain Assembly, Lusso, Chrome
4204828 Trim/Drain Assembly, Lusso, Gold
4204829 Trim/Drain Assembly, Lusso, Bright Brass
5020000 Repair Kit, Almond White, Acrylic/Lacquer
5030000 Repair Kit, Blanca White, Acrylic/Lacquer
5040000 Repair Kit, Brittany Blue, Acrylic/Lacquer
5050000 Repair Kit, Adobe Tan, Acrylic/Lacquer
5055000 Repair Kit, Sandstone, Acrylic/Lacquer
5060000 Repair Kit, Black, Acrylic/Lacquer
5065000 Repair Kit, Cinnabar, Acrylic/Lacquer
5070000 Repair Kit, Jamaican Brown, Acrylic/Lacquer

REPAIRS

DRAIN CLEANING
ALTERATIONS
NEW INSTALLATION
RESIDENTIAL • COMMERCIAL

STATE CERTIFIED — LICENSED & INSURED
COMPLETE SELECTION OF PLUMBING FIXTURES
& REPLACEMENT PARTS . . .



KOHLER



Jacuzzi
WHIRLPOOL • BATH



**AMERICAN
STANDARD**

Guillian's
PLUMBING

"ONE STOP PLUMBING SHOP"

226-7855

"SHOWROOM AT"
11040 W. FLAGLER ST.
MIAMI, FLORIDA

Limited 90-Day Warranty on Replacement Parts

Warranty Coverage

Jacuzzi Whirlpool Bath (the "Company") provides a limited material and labor warranty on its replacement parts.

Our warranty extends to the original purchaser of the replacement parts who buys it for installation in a Company product used for personal, family or household purposes ("user"). It does not extend to purchasers who intend to resell the product. Additional limitations apply to commercial users, and special rules apply to dealers and distributors.

Our warranty is ninety (90) days, beginning on the date the replacement part was installed or purchased by the user, whichever is later.

Our warranty covers: All replacement parts against defects in material or workmanship, or failure to operate in accordance with the performance ratings for the part.

Without charge to the user, the Company will, at its option, either repair the defective part or replace the defective part.

Warranty Service

In order to obtain service provided under this warranty, during regular business hours contact a Jacuzzi Whirlpool Bath Authorized Service Agent or the Dealer/Distributor who sold the part and describe the problem. (See the white pages of your local telephone book for the location of the nearest Authorized Service Agent.) An Authorized Service Agent will contact the user, inspect the system, and provide the service described herein.

Warranty Limitations

Our warranty is limited and does not cover defects, damage, or failure caused by the installer, user or other person, including but not limited to the following: improper installation or installation not in accordance with the instructions and specifications provided with the part or system; any type of modification of any part or component, including modification to meet local codes; misuse; lack of maintenance or improper maintenance or operation; use of chemicals in units with gold-plated fixtures; improper connections by the installer; improper voltage supply; careless handling; operation of the system without minimum amount of water in the vessel as specified in the Operating Instructions; acts of God.

In addition, the Company will not be responsible for any incidental or consequential damages or losses, direct or indirect, arising from any cause whatsoever; shipping damage; alleged factory damage or defect which was not reported to the Company prior to installation, compliance with local building codes.

Commercial Limitations

In addition to the user Warranty Limitations, our warranty does not cover commercial installations when the part or system has been altered or modified in any way. The part or system is sold on an "as is" basis, and the Company is not responsible for loss of use or profit under any circumstances.

Implied Warranties

Implied warranties of merchantability and fitness for a particular purpose, to the extent that they are applicable, are limited to ninety (90) days from the date of purchase or installation, whichever is later.

Notice: This warranty gives you specific legal rights, and you may also have other rights which vary from state to state. There are no warranties applicable to Jacuzzi Whirlpool Bath producers except as expressly stated herein or as implied in applicable state and Federal laws. The Company will not be responsible for any statements or representations made in any form that go beyond, are broader than, or are inconsistent with authorized literature or specifications furnished by the Company. Some states do not allow limitations on how long an implied warranty lasts, so the above limitation may not apply to you. Also, some states do not allow the exclusion of incidental or consequential damages, so the above limitation or exclusion may not apply to you.

Responsibility to Others

Inspecting the replacement part prior to installation is the responsibility of the user or installer or building contractor who acts on behalf of the user. He is responsible for ensuring the replacement part is free of defects or damage. In the event of a problem, the replacement part must not be installed. The Company is not responsible for defects or damage that could have been discovered, repaired, or avoided by inspection and testing the replacement part prior to installation.

Damage occurring to the replacement part during or after installation is the responsibility of the installer and/or building contractor.

PRODUCT SPECIFICATIONS ARE SUBJECT TO CHANGE WITHOUT NOTICE

Jacuzzi Whirlpool Bath has obtained applicable code (standards) listings generally available on a national basis for products of this type. It is the responsibility of the installer/owner to determine specific local code compliances prior to installation of the product. Jacuzzi Whirlpool Bath makes no representation or warranty regarding, and will not be responsible for any code compliance.

REPAIRS
DRAIN CLEANING
ALTERATIONS
NEW INSTALLATION
RESIDENTIAL • COMMERCIAL

STATE CERTIFIED — LICENSED & INSURED
COMPLETE SELECTION OF PLUMBING FIXTURES
& REPLACEMENT PARTS...

KOHLER

Guillen's
"ONE STOP PLUMBING SHOP"
PLUMBING

Jacuzzi
Whirlpool Bath

AMERICAN STANDARD

226-7855
"SHOWROOM AT"
11040 W. FLAGLER ST.
MIAMI, FLORIDA

CC - 9418

JACUZZI WHIRLPOOL BATH

Subsidiary of Kidde, Inc.
KIDDE

298 North Wiget Lane, P.O. Drawer J., Walnut Creek, CA 94596 (415) 938-7070

Jacuzzi Whirlpool Bath Regional Offices

Western Region: 335 Fischer Ave., Costa Mesa, CA 92626 (714) 751-1244
Great Lakes Region: 415 W. Golf Rd., Suite 49, Arlington Heights, IL 60005 (312) 640-1300
Central Region: 13720 Midway Rd., Suite 110, Dallas, TX 75234 (214) 233-5572
Southeast Region: 2500 Park Central Blvd., Decatur, GA 30035 (404) 981-8222
Northeast Region: West Essex Plaza II, 1129 Bloomfield Ave., West Caldwell, NJ 07006 (201) 575-7710